



THE JACOB RADER MARCUS CENTER OF THE  
**AMERICAN JEWISH ARCHIVES**

**MS-831: Jack, Joseph and Morton Mandel Foundation Records, 1980–2008.**

Series C: Council for Initiatives in Jewish Education (CIJE). 1988–2003.

Subseries 3: Lead Communities, 1988–1997.

---

Box  
31

Folder  
13

Lead Community Consultation seminar. Milwaukee, Wis.,  
November 1993.

For more information on this collection, please see the finding aid on the  
American Jewish Archives website.

---

TO: Gail Dorph, Adam Gamoran, Ellen Goldring, Roberta Goodman,  
Alan Hoffmann, Barry Holtz, Daniel Pekarsky, Julie Tammivaara,  
FROM: Ginny Levi  
DATE: November 3, 1993

---

Information re: Milwaukee meetings, November 14

The meeting will take place at the

Residence Inn  
7275 North Port Washington Road  
Glendale, WI 53217  
Phone: 414-352-0070  
FAX: 414-352-3743

The meeting will begin at 9:00 AM and break at 2:00 PM for the Milwaukee strategic planning orientation meeting. We will reconvene at 5:30 PM and meet until 10:00 PM.

Overnight hotel reservations have been made at the Residence Inn for the following:

Saturday, November 13

Ellen Goldring  
Julie Tammivaara  
Alan Hoffmann  
Barry Holtz  
Gail Dorph  
Ginny Levi

Sunday, November 14

Roberta Goodman  
Julie Tammivaara  
Alan Hoffmann  
Barry Holtz  
Gail Dorph  
Ginny Levi

Monday, November 15

Roberta Goodman  
Julie Tammivaara

Info re: Montreal Meetings

Overnight hotel reservations have been made at the

Le Centre Sheraton  
120 Rene Leversque Blvd. West  
Montreal, Quebec H3B2L7  
Phone: 514-878-2000  
FAX: 514-878-3958

for the following:

	Arrival	Departure
Roberta Goodman	11/16	11/19
Ellen Goldring	11/16	11/17
Ginny Levi	11/15	11/17
Julie Tammivaara	11/16	11/17
Gail Dorph	11/15	11/21
Barry Holtz	11/15	11/19
Alan Hoffmann	11/15	11/20

Attached is a memo I sent to the community representatives re the GA meeting times and locations. I need to know who will be there for lunch on the 16th.

Thanks.



Call Roberta Goodman

tell her we looking for place  
near campus - stay at <sup>Jewish</sup> C. center

Meeting place - Holiday  
Inn - Residence Inn

nice rooms, good meetings  
nicely priced

Sunday - 11/14

13 + 14 hotel rooms - includes  
2 meals - provided  
food

check  
w/ Susan Jonas

What are the chances of  
having Kosher food brought in?

- approximately 9 people =

A.D.H.	E.H.	N.P.
J.Z.D.	A.H.	
B.H.	J.T.	
V.F.L.	R.H.	



Ann,

The Milwaukee River Hilton will not allow outside food of any kind to be brought in. (Apparently, Ruth Cohen does not know this.)

Will advise  
about soft-  
core bread  
own drinks.

With that in mind, I have moved on to the Marriot Residence Inn and I have found out the following:

They have no problem with outside food being brought in.

They have a meeting room available on Nov. 14 that is suitable for 10 people for \$100.00 for the day. This room can be locked and left and nothing will be disturbed. It is large enough for a conference style table with two other tables. One for coffee and tea. (coffee is \$18.00 a gallon and the tea is at no charge) Soda is \$1.50 each. I suggest that we purchase it from the caterers. I have not received a fax from them yet but they are faxing their prices to us before 3 PM today. (I spoke with them) They suggested we do a dairy tray for lunch and a meat tray for dinner. They will deliver both meals to the hotel.

2 pots 1 reg 1 deep

The individual sleeping rooms are \$81.00 a night.

I need dates of overnight stay, all names so I can reserve.

Denise to call me back at 1:00.

Closed square  
10 people

Lock room

the

Conference room - S

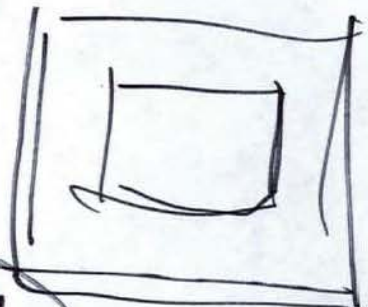

marker board - no charge  
Book it.

credit  
card to hold  
rooms

A-V equipment.





"More like a Home than a Hotel!"

With several spacious layouts to choose from,  
you feel more like you're at home  
than on the road.



STUDIO

Our over-sized Studio offers you all of the conveniences  
and comforts of home ~ including a fully-equipped kitchen.

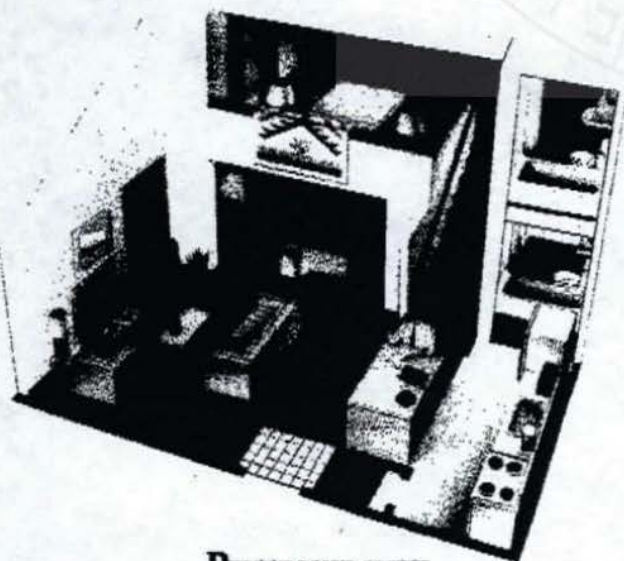

PENTHOUSE SUITE

The spectacular two-story Penthouse Suite gives you a  
flexible floor plan with twice as much space as a conventional  
hotel room ~ at comparable cost, too.

## Residence Inn by Marriott

~ Glendale, WI ~

Phone (414) 352-0070

Fax (414) 352-3743

DATE: 10.19.93

TO: MARY ESTHER Block  
OF: CITE

FROM: DENISE SCHWAIGER

FAX #: 216.391.5430

# of PAGES: 13  
(INCLUDING COVER PAGE)

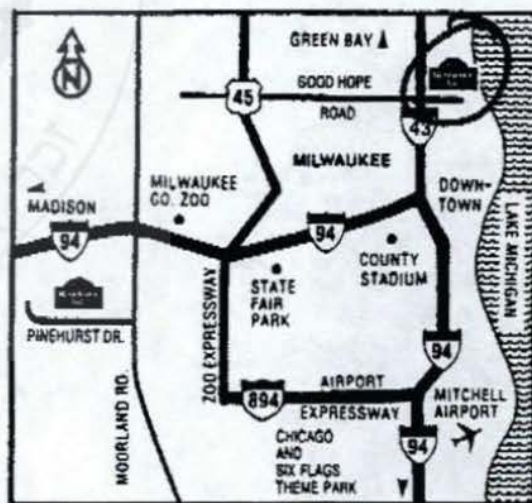

### COMPLIMENTARY:

- ◆ Breakfast Daily
- ◆ Social Hour Weekday Evenings
- ◆ Thursday Night Dinner
- ◆ Newspapers Daily
- ◆ Van Transportation (Prescheduled)
- ◆ Health Club Privileges





Residence Inn by Marriott

7275 North Port Washington Road Milwaukee-Glendale  
Glendale, Wisconsin 53217 414-352-0070 Fax 414-352-3743

\*\*\*\*\* MEMORANDUM \*\*\*\*\*

Date : October 19, 1993  
To : Ms. Mary Esther Block  
CIJE  
From : Denise Schwaiger  
Subject : CIJE Meeting in November

Following is the information you had requested regarding the 10 people that are coming into the Milwaukee area in mid November, 1993. According to our conversation, you would be interested in 10 Studio Suites for 2 nights (specific dates are yet to be determined).

Due to the number of rooms that you are requesting, I am excited to be able to offer a SPECIAL rate for November. The following rates will apply to your group.

	<u>SPECIAL CIJE RATE</u>	<u>REGULAR RATE</u>
Studio Suite	\$ 81.00 per night	\$ 131.00 per night
Penthouse Suite	\$ 126.00 per night	\$ 156.00 per night

The information that follows details all of the amenities that Residence Inn by Marriott - Glendale will offer your employees while staying with us.

If you have any questions, please feel free to call me at (414) 352-0070. I look forward to welcoming your company to Residence Inn!

Sincerely,,

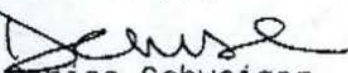
  
Denise Schwaiger

10/21/93

Kosher Food in Milwaukee

Kosher Meat Club

414-871-3273

4 of.  
414 445  
3667

Talked with Mindy. She will fax info.

Cream cheese, lox, bagels, fruit platter,  
danish & coffee.....\$4.50 per person

Cold cereal, fruit platter, danish & coffee.....\$4.00 per person

Deli tray.....\$6.50 per person  
(includes soda, bread and ~~fruit~~ *fruit*)

Dinner.....\$9.00 per person  
(consists of ?)

Kramer's

414-442-2625

Talked with Cindy. She does not have a fax machine.

\$10.00 delivery charge for each meal.

New York style Bagels, lox, cream cheese.....\$4.99 per person

Lox tray.....\$6.99 per person

Deli Tray.....\$6.99 per person

Dinner.....\$12.00 per person  
(entree, 2 veggies, salad & bread)

needs 2 days notice to prepare

ask about salad  
these platters  
each cons of soda?  
paper plates  
bagels  
salmon





Residence Inn by Marriott

Milwaukee-Glendale  
7275 North Port Washington Road Glendale, Wisconsin 53217 414-352-0070 Fax 414-352-3743

### FUNCTION SHEET

DATE OF EVENT: November 14, 1993  
LOCATION: Conference Room  
TIME: 9:00 am - 10:00 pm  
COMPANY NAME: CIJE - Council for Initiative of Jewish Education  
CONTACT: Anne Klein  
PHONE NUMBER: 216-391-8300  
NUMBER OF PEOPLE: 10  
BILLING INFORMATION: Direct Billing to be set up

#### SET UP REQUIREMENTS

Conference style seating for 10

#### BREAKS/ CATERING SERVICE

We will provide coffee and tea  
1 Regular and 1 Decaf. - \$18.00  
per gallon.

Kosher food to be provided by group

#### RADIO/VISUAL EQUIPMENT

on at this time except they  
all use the write on/ wipe off  
marker board.

#### MISCELLANEOUS

MEETING ROOM CHARGE \$100.00

Overnight Reservations

*Sat*

~~Sunday~~, November 13

Ellen Goldring  
Roberta Goodman  
Julie Tammivaara  
Alan Hoffmann  
Barry Holtz  
Gail Dorph  
Ginny Levi

*Daniel Peharsky*

*at the meeting*

EG  
RG  
JT  
AG  
DP  
ADH  
BWH  
GZD  
VFL

*Sun*

~~Monday~~, November 14

Julie Tammivaara  
Alan Hoffmann  
Barry Holtz  
Gail Dorph  
Ginny Levi

*Preserved  
with Denise  
10/25/93  
MEB*



PARTICIPANTS LEAD COMMUNITIES SEMINAR

Montreal November 16 - 17, 1993

Janice Alper  
Jewish Educational Services  
1745 Peachtree Road, NE  
Atlanta, GA 30309  
Phone: 404-873-1248  
FAX:

Lauren Azoulai  
Atlanta Jewish Federation  
1753 Peachtree Road, N.E.  
Atlanta, GA 30309  
Phone: 404-873-1661  
FAX: 404-874-7043

Chaim Botwinick  
Board of Jewish Education of Baltimore  
5800 Park Heights Ave.  
Baltimore, MD 21215  
Phone: 410-578-6943  
FAX: 410-466-1727

Ruth Cohen  
Milwaukee Jewish Federation  
1360 North Prospect Ave.  
Milwaukee, WI 53202  
Phone: 414-271-8338  
FAX: 414-271-7081

Gail Dorph  
588 West End Ave.  
Apt. 2-A  
New York, NY 10024  
Phone: 212-769-0725  
FAX: 212-769-0746

Genine Fidler  
8009 Melody Lane  
Baltimore, MD 21208  
Phone: h. 410-484-3256, w. 410-358-4934  
FAX:

Darrell Friedman  
THE ASSOCIATED  
101 West Mount Royal Ave.  
Baltimore, MD 21201  
Phone: 410-727-4828  
FAX: 410-752-1177

Jane Gellman  
3535 N. Summit  
Milwaukee, WI 53211  
Phone: 414-963-9196  
FAX:

Ellen Goldring  
Vanderbilt University  
Box 514  
Nashville, TN 37203  
Phone: 615-322-8037  
FAX: 615-343-7094

Roberta Goodman  
149 Nautilus Drive  
Madison, WI 53705  
Phone: 608-231-3534  
FAX: 608-231-6844

Michal Hillman  
2898 Sequoyah Drive NW  
Atlanta, GA 30327  
Phone: 404-351-5816  
FAX:

Stephen H. Hoffman  
Jewish Community Federation of Cleveland  
1750 Euclid Ave.  
Cleveland, OH 44115  
Phone: 216-566-9200  
FAX: 216-566-9084

Alan Hoffmann  
CIJE  
P. O. Box 94553  
Cleveland, OH 44101  
Phone: 216-391-1852  
FAX: 216-391-5430

Barry Holtz  
299 Riverside Drive, 4B  
New York, NY 10025  
Phone: 212-864-3529  
FAX: 212-864-6622

Virginia Levi  
CIJE  
P. O. Box 94553  
Cleveland, OH 44101  
Phone: 216-391-1852  
FAX: 216-391-5430

Marshall Levin  
The ASSOCIATED  
101 West Mount Royal Ave.  
Baltimore, MD 21201-5781  
Phone: 410-727-4828  
FAX: 410-752-1177

Howard Neistein  
Milwaukee Jewish Federation  
1360 North Prospect Ave.  
Milwaukee, WI 53202  
Phone: 414-271-8338  
FAX: 414-271-7081

David I. Sarnat  
Atlanta Jewish Federation  
1753 Peachtree Road, N. E.  
Atlanta, GA 30309  
Phone: 404-873-1661  
FAX: 404-874-7043

William Schatten  
3865 Parian Ridge Road N.W.  
Atlanta, GA 30327-3027  
Phone: 404-233-8246  
FAX:

Louise Stein  
2510 West Dean Road  
Milwaukee, WI 53217  
Phone: 414-352-3140  
FAX:

Julie Tammivaara  
58 Penny Lane  
Baltimore, MD 21209  
Phone: 410-653-4648  
FAX: 410-653-3727





**KOSHER MEAT KLUB SUPERMARKET**  
**4731 W. BURLEIGH**  
**MILWAUKEE, WI 53210**  
**+14-871-3273 (FAX) 414-445-3667**

**TO C.I.J.E.**  
**MARY ESTHER BLOCK**  
**216-391-5430**

**DELIVER TO RESIDENCE INN**  
**7275 N. PORT WASHINGTON ROAD**  
**GLENDALE, WI 53217**  
**414-352-0070**

**SUNDAY NOVEMBER 14, 1993 DELIVERY**

**LUNCH DELIVERED 11:30**

**DAIRY DELI PLATTER**

**BAGELS, SLICED TOMATOES AND ONIONS**  
**CREAMCHEESE, & LOX**  
**FRUIT**  
**MINI DANISH**  
**SOFT DRINKS**  
**TUNA SALAD**  
**CUT UP VEGGIES.....\$7.5PER PERSON**

**DINNER DELIVERED BY 5:00 P.M.**

**MEAT PLATTER**

**MORE TURKEY, ROAST BEEF, CORNED BEEF**  
**PASTA SALAD, COLESLAW**  
**PICKLES, RYE BREAD, ROLLS**  
**CONDIMENTS**  
**SOFT DRINKS**  
**FRUIT**  
**TUNA SALAD, CUT UP VEGGIES.....7.50 PER PERSON**

**WILL INCLUDE ALL UTENSILS + Paper products**

To be picked up at Airport in Milwaukee  
on hotel van:

<u>Name</u>	<u>Flight #</u>	<u>Time</u>
Julie T.	USAir 721	5:40
Jimmy L.	USAir 1653	8:30
Alan ?		
Ellen D.	Sunday Delta	
<del>Robert D.</del>	1181	9:15

Reynolds



Sun., Nov. 14, Milw.

Place: Residence Inn  
(details)

Meeting times 9am - 2pm, 5:30 - 10pm  
[Can they provide a flip chart?]

from 9am - coffee, tea, cold water  
~~eat fruit a.m.~~

delivered lunch: 11:30 - C. cheese, lox, bagels,  
fruit, danish, soft  
drinks

delivered dinner: 5:00

(What is "dinner" vs. deli tray?

Pls. find out) Ask about veg. options

The conference Room

414-871-3273

F  
A  
X  
  
C  
O  
V  
E  
R  
  
S  
H  
E  
E  
T

Council for Initiatives  
in  
Jewish Education

Date sent: November 2, 1993  
To: Marcia Eisenbach  
Organization:

No. of Pages (incl. cover): 2  
From: Mary Esther Block

Phone Number:

Phone Number:

Fax Number:

Fax Number:

414-445-3667

216-391-5430

Comments:

Marcia:

We understand the following will be provided by Kosher Meat Klub on Sunday, November 14 for a meeting at

Residence Inn  
7275 N. Port Washington Road  
Glendale, WI 53217  
414-352-0070:

For Lunch to be delivered by 11:30 AM

One dairy deli platter which will consist of:

Bagels  
sliced tomatoes and onions  
cream cheese & lox  
fruit  
danish  
soft drinks  
tuna salad  
cut up veggies

For Dinner to be delivered by 5:00 PM

One meat deli platter which will consist of:  
cold cuts (plenty of turkey, roast beef, corned beef, no tongue)  
pasta salad

cole slaw  
pickles  
rye bread  
rolls  
condiments  
soft drinks  
fruit  
tuna salad  
cut up veggies

If there are any problems receiving  
this transmission, please call:

216-391-1852

(CONTINUED ON NEXT PAGE)



Kosher Meat Klub will provide paper products: paper plates, napkins, cups, flatware.

There will be nine (9) people at each of these meals.

Please fax back price. I will then call you.

MEB



November 2, 1993

Ginny,

I spoke to Denise at the Residence Inn in Milwaukee. The meeting room does not have a name or number. Its just the "conference room." I told her you would like coffee, tea and cold water served throughout the day on the 14th starting at 9:00 AM making sure there was plenty at each meal.

Flip charts are \$25.00. There is a "white board" in that meeting room if you could use it with wipe off markers provided by the hotel. What do you think?

MEB



*Flip charts  
@ 25.00  
Jo-*



Ginny,

Mark this up anyway you want. These people can do anything. They want to know what we want exactly, then Marcia will fax back a definite price on what they will do it for. Everything below I mentioned to her and she didn't seem to think it would cost any more than what she has already told us. I told her this was for 9 people and she understands the date we need it.

TO: Marcia Eisenbach  
Kosher Meat Klub

Marcia:

We understand the following will be provided by Kosher Meat Klub on Sunday, November 14: *for a meeting at Residence Inn, (address & phone)*

For Lunch to be delivered by 11:30 AM -

*Do we know an. name on #?*

One dairy deli platter which will consist of

Bagels  
sliced tomatoes and onions  
lox  
cream cheese  
fruit  
danish  
soft drinks  
tuna salad  
cut up veggies

*Hotel will replenish  
coffee & tea at 5:00?*

For dinner to be delivered by 5:00 PM -

One meat deli platter which will consist of

cold cuts  
pasta salad  
cole slaw  
pickles  
rye bread or rolls  
condiments  
soft drinks  
fruit  
tuna salad  
cut up veggies

*- plenty of turkey + roast beef? corned beef? anything else?  
No tongue*

*flat* Kosher Meat Klub will provide paper products: paper plates, napkins, cups, silverware.

Ginny:

Dinner consists of: a meat, (sliced brisket, corned beef) rice or potato, 1 vegetable plus bread but it would be hot and there is no way to keep it.

*I will fax back to her exactly what,  
when, how much —*

Overnight Reservations

November 14

Ellen Goldring

~~Roberta Goodman~~

November 14 and 15

Julie Tammivaara

Alan Hoffmann

Barry Holtz

Gail Dorph

Ginny Levi

November 15

~~Roberta Goodman~~

Sunday,  
Meeting Room date - November 14  
9AM - 10PM

~~Set up fee~~  
\$500/person

→ No set up charge.

10/25 - function  
sheet

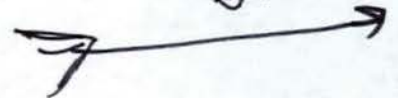

Up until  
4:00 pm cancellation

Form  
for direct  
billing -  
with ASAP

Set up  
direct billing  
w/ BK  
or credit card  
to hold rms.  
Credit card  
or check -  
guarantee  
rooms.

6

\* \$81/night

\$100 - meeting room  
Kosher catering in  
responsible for arrangements



TO: Gail Dorph, Adam Gamoran, Ellen Goldring, Roberta Goodman,  
Alan Hoffmann, Barry Holtz, Daniel Pekarsky, Julie Tammivaara,  
FROM: Ginny Levi  
DATE: November 3, 1993

---

Information re: Milwaukee meetings, November 14

The meeting will take place at the

Residence Inn  
7275 North Port Washington Road  
Glendale, WI 53217  
Phone: 414-352-0070  
FAX: 414-352-3743

The meeting will begin at 9:00 AM and break at 2:00 PM for the Milwaukee strategic planning orientation meeting. We will reconvene at 5:30 PM and meet until 10:00 PM.

Overnight hotel reservations have been made at the Residence Inn for the following:

Saturday, November 13

~~Ellen Goldring~~  
Julie Tammivaara  
Alan Hoffmann  
Barry Holtz  
Gail Dorph  
Ginny Levi

Sunday, November 14.

*Ellen Goldring* *Adam Gamoran*  
Roberta Goodman  
Julie Tammivaara  
Alan Hoffmann  
Barry Holtz  
Gail Dorph  
Ginny Levi

Monday, November 15

Roberta Goodman  
Julie Tammivaara

VFL

TO: Gail Dorph, Adam Gamoran, Ellen Goldring, Roberta Goodman,  
Alan Hoffmann, Barry Holtz, Daniel Pekarsky, Julie Tammivaara,  
FROM: Ginny Levi  
DATE: November 3, 1993

Information re: Milwaukee meetings, November 14

The meeting will take place at the

Residence Inn  
7275 North Port Washington Road  
Glendale, WI 53217  
Phone: 414-352-0070  
FAX: 414-352-3743

The meeting will begin at 9:00 AM and break at 2:00 PM for the Milwaukee strategic planning orientation meeting. We will reconvene at 5:30 PM and meet until 10:00 PM.

Overnight hotel reservations have been made at the Residence Inn for the following:

Saturday, November 13

~~Ellen Goldring~~  
Julie Tammivaara  
Alan Hoffmann  
Barry Holtz  
Gail Dorph  
Ginny Levi

(5)

Sunday, November 14

~~Ellen Goldring~~  
Roberta Goodman  
Julie Tammivaara  
Alan Hoffmann  
Barry Holtz  
Gail Dorph  
Ginny Levi

(8)

Monday, November 15

Roberta Goodman  
Julie Tammivaara

(2)

*Baggage claim #5*  
*20 minutes*  
*Free shuttle service*  
*How far from airport?*  
*8037 - OK for telecons*  
*No messages on E-mail*  
*For E-mail address is going to try you to contact you*  
*DOLD RIEB*  
*(AT sign)*  
*C. TR. FAX.*  
*V. D. V.*  
*E. D. V.*



F  
A  
X  
  
C  
O  
V  
E  
R  
  
S  
H  
E  
E  
T

Council for Initiatives  
in  
Jewish Education

Date sent:

Time sent:

No. of Pages (incl. cover):

To: November 4, 1993  
Ellen Goldring

From:

Mary Esther Block

Organization:

Phone Number:

Phone Number:

Fax Number:

Fax Number:

(615) 343-7094

216-391-5430

Comments:

Ellen:

The airport in Milwaukee is located 20 minutes away from the hotel. I have arranged for the hotel to pick you up at 9:15 AM on Sunday, November 14 in their free shuttle service van. They will meet you at Baggage Claim # 5.

Let me know if you have any questions.

MEB

If there are any problems receiving  
this transmission, please call:  
216-391-1852

*M - Am I set  
with this shuttle?*

November 4, 1993

Ginny,

Ellen Goldring called. She wanted me to find out about transportation from the airport to the Residence Inn in Milwaukee. I did. Its 20 minutes away and they have free shuttle service and I have arranged for the hotel to pick her up at baggage claim #5. Room reservations for her are changed. She will not need a room for Saturday night. She will be coming in 9:15 AM Sunday and will stay Sunday night only. I will fax the info to her about the shuttle.

She is OK for telecon on 11/9 at 1 PM (her time) at her 8037 number.

There are no messages for her on her E-mail from you. Please fax her your E-mail address and she will try and get through to you. She said she gave you a code. Here is another one that should work:

G O L D R I E B (at sign) C T R V A X period Vanderbilt period E D U period

