



THE JACOB RADER MARCUS CENTER OF THE  
**AMERICAN JEWISH ARCHIVES**  
A DIVISION OF HEBREW UNION COLLEGE – JEWISH INSTITUTE OF RELIGION

**MS-630: Rabbi Alexander M. Schindler Digital Collection, 1961-1996.**

Series A: Union of American Hebrew Congregations, 1961-1996.

---

Box  
7

Folder  
5c

Museum of the Southern Jewish Experience, 1986-1995.

For more information on this collection, please see the finding aid on the  
American Jewish Archives website.

---

Give us the strength to be gentle  
the wisdom to be confused  
the right to be wrong on occasion  
the sense to know when to lose.  
Give us the time to be patient  
the courage to be afraid.  
Give us the eyes of children again  
to see the world — a different world —  
a world that can still be made.

from **The Tap Dance Kid**  
"William's Song"  
Lyrics by Robert Lorick

August 6, 1986

## Henry S. Jacobs Camp

**Macy B. Hart**  
Camp Director

**David B. Grishman**  
Chairman, Board of Directors

Summer  
Utica, Mississippi 39175  
(601) 885-6042

Winter  
P. O. Box 16528  
Jackson, Mississippi 39236-0528  
(601) 362-6357



Plough Foundation  
P. O. Box 11087  
Memphis, Tennessee 38111-0087

ATTENTION: Mr. B. R. Haltom, Chief Operating Officer

RE: Grant to Henry S. Jacobs Camp

Dear Mr. Haltom:

Enclosed herewith is a duly executed copy of your letter dated June 24, 1986 addressed to Macy B. Hart as Camp Director for Henry S. Jacobs Camp, Utica, Mississippi.

On behalf of Henry S. Jacobs Camp and the members of the Camp Committee, I want to thank the Plough Foundation for its generosity in approving the grant of \$539,220 to the Camp to fund construction costs and related items of expense for the synagogue-museum-repository to be located at the Camp. The impact this structure when completed will have on the Jewish community of the deep south will be immeasurable and will be felt for many years and generations to come. The thoughtfulness of the representatives of the Plough Foundation is greatly appreciated. Please convey our heartfelt thanks to each of them.

We will look forward to working with you or another designated representative of the Plough Foundation in pursuing the completion of this project.

Sincerely,

*David B. Grishman*  
David B. Grishman, Chairman

DBG:sj  
enclosure  
cc: Mr. Macy B. Hart ✓



PLOUGH FOUNDATION  
P.O. Box 11087 • Memphis, TN 38111-0087

June 24, 1986

Henry S. Jacobs

Mr. Macy B. Hart  
Camp Director  
Box C  
Union of American Hebrew Congregations  
Henry S. Jacobs Camp for Living Judaism  
Utica, Mississippi 39175

Dear Macy:

This letter is to confirm the favorable action of the Board of Trustees of the Plough Foundation in approving the grant of \$539,220. This represents the amount of your grant request to fund construction costs and related items of expense earlier presented as "Plan A" covering a synagogue-museum to be located at the Henry S. Jacobs Camp near Utica, Mississippi. The grant was made subject to the following conditions:

1. Construction advances will be made over a three year period commencing in 1986 and with the final payment due in 1988, as the funds are required.
2. There is to be no family name associated with the building or appearing thereon at any time.
3. It is understood that there will not be a mortgage placed on the building as long as the present owners maintain title to the property.
4. After final bids have been received and accepted, representatives of the Plough Foundation will have an opportunity to approve the plans before construction contracts are finalized.
5. The maximum amount of funds to be provided, \$539,220, is to include installation of a pullman kitchen system.
6. It is understood that the building will be completed no later than June 30, 1988 unless a nominal extension of time is granted by the donor.
7. As funds are advanced, a report will be forwarded each calendar quarter reflecting the receipts along with the disbursements of the funds provided.



Mr. Macy Hart  
June 24, 1986  
Page Two

8. The grant of \$539,220 is intended to fund the total amount as presented in your grant request covering "Plan A" and represents the maximum amount payable and includes "Miscellaneous for contingencies" of \$25,000. It is understood that any amount incurred in excess of \$539,220 will not be included as the commitment of the Plough Foundation, but will be the responsibility of the Union of American Hebrew Congregations or the Henry S. Jacobs Camp for Living Judaism which by acceptance of this grant guarantees the completion of the project.

We will be communicating with you from time to time with respect to providing the funds as building costs and related expenses become payable. It will be appreciated if you will kindly sign a copy of this letter and return to the writer for our files.

Since you are having your board meetings this weekend, should any question arise with respect to this letter, I will be pleased if you wish to telephone me at home. The number is 901-683-3365.

Cordially,



B. R. Haltom  
Chief Operating Officer

The foregoing terms and conditions are agreed to and accepted, this 29<sup>th</sup> day of June, 1986.

By: David B. Guithman, Chairman





# *The University of Mississippi*

Center for the Study of Southern Culture  
University, MS 38677  
(601) 232-5993

January 12, 1987

Macy B. Hart, Director  
Henry S. Jacobs Camp  
P.O. Box 16528  
Jackson, MS 39236

Dear Macy,

It was a special pleasure to see you at the Jacobs Camp this past month. I was very pleased with the discussions we had and look forward to meeting with you here at the Center.

As I indicated, we would very much like to develop a long-term relationship with you and your project on southern Jews. In our study of the American South we are well aware of the major contributions of Jewish families. Our forthcoming Encyclopedia of Southern Culture features entire entries on southern Jews by scholars such as Eli Evans.

We are also developing a major film on Ludwig Lewisohn who was one of the few Jewish novelists from the South. Born in Charleston, Lewisohn became a leader of the Zionist cause and corresponded with Freud, Einstein, and other intellectuals during the early part of this century. One of Lewisohn's relatives, Walter Lewisohn, has made major gifts of films, books, and paintings to our center. The enclosed copy of our SOUTHERN REGISTER includes a feature on Walter and his wife, Florence.

I would like to outline resources which our Center and the University might provide should you choose to work with us in developing an Archive of Southern Jewish Culture. We currently have internationally recognized programs on the American South which include archives, conferences, publications, research, and teaching components. Each of these areas has an obvious relationship to the study and preservation of southern Jewish culture.

We also have extensive media facilities at the University which could be used to develop films, videotapes, slides and other materials for public dissemination. As a filmmaker, I would be especially interested in working with you on such projects.



macy hart  
page 2

I would like to stress the fundraising potential a relationship with our Center and the University would offer your project. Since its creation in 1977, the Center has raised just under four million dollars in non-state support. Much of this support was for projects which were developed by individuals such as yourself who felt the Center was the appropriate base to develop their efforts.

Should you decide to work with us, we would assist in developing proposals, and I would personally travel with you to make presentations before foundations. We also have prominent Jewish alumni who have expressed an interest in supporting projects on southern Jewish culture at the University.

Our discussions and my visit with you at the Jacobs Camp make it increasingly clear that our respective institutions can develop a symbiotic relationship in which we will both benefit. We can assist you in developing conferences and public exhibits on at your museum, and we will develop research archives and courses on southern Jewish culture. Our Center and the history department cosponsor an annual symposium on southern history, and we might consider highlighting this project through a symposium focused on the theme of southern Jewish history. As with earlier symposia, the edited proceedings would be published and could serve as a basic text for courses on southern Jewish culture.

These are preliminary thoughts which we can discuss further during your visit on January 12th. I look forward to seeing you then and deeply appreciate your interest in our program.

Sincerely,

*Bill*

William Ferris  
Director

cc: Chancellor et.al.  
Ann Abadie  
Don Fruge  
Catherine and Julian Weiner  
Bob Haws





STATE HISTORICAL MUSEUM  
OLD CAPITOL RESTORATION  
MISSISSIPPI DEPARTMENT OF ARCHIVES AND HISTORY  
BOX 571  
JACKSON, MISSISSIPPI 39205-0571

BOARD OF TRUSTEES

WILLIAM F. WINTER, PRESIDENT  
JOHN K. BETTERS WORTH  
ARCH DALRYMPLE III  
HERMAN B. DECELL  
FRANK E. EVERETT JR.  
MRS. MITCHELL ROBINSON  
ESTUS SMITH  
EVERETTE TRULY  
SHERWOOD W. WISE  
ELBERT R. HILLIARD  
DIRECTOR

December 31, 1986

Mr. Macy B. Hart, Director  
Henry S. Jacobs Camp  
P.O. Box 16528  
Jackson, MS 39236-0528

Dear Macy:

I hope plans for the Jewish History Museum are moving swiftly and successfully. I know that it will be a facility that Mississippi will be extremely proud of. An idea has occurred to me that I would like for you to consider.

I think your museum, its setting, and its development, would be of great interest to the museum profession. Would you be interested in hosting the 1990 or 1991 annual meeting of the Southeastern Museums Conference?

Approximately 300 attend the four-day meeting. The cost of the registration should cover all of the expenses that you would have (exclusive of your staff time). Lodging is charged separately to each participant. The SEMC program committee always arranges a high-caliber program of professional interest and a local arrangements committee assists the host.

Normally the group meets in a city that can offer tours of several museums. We can arrange bus trips to Jackson, Vicksburg and Natchez to accomplish that. Normally the entertainment is "city" entertainment: drinks and hors d'oeuvres and musical groups. I think many wonderful entertainments could be devised at your camp, including some sports activities and outdoor cooking. There may be logistical problems that I have not considered.

If you are at all interested in this possibility, I would love to come down and talk to you about it. A formal invitation would need to be extended at the 1987 meeting which will be in Virginia in September and then the in-coming president would probably make a visit.



Accredited by the American Association of Museums

Mr. Macy B. Hart  
Page 2  
December 31, 1986

If you are too swamped to think about this yet, I will understand and bring it up again later.

Let me know what's going on down there.

Sincerely yours,

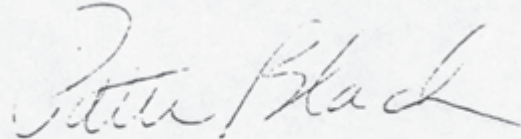

Patti Carr Black, Director  
State Historical Museum

PCB/dm  
cc: Elbert Hilliard  
Mary Lohrenz





ROUGH DRAFT

PROPOSAL TO PRESERVE  
THE JEWISH CEMETERY  
DONALDSONVILLE, LA.

HENRY S. ...

THE JEWISH ENDOWMENT FOUNDATION WOULD ESTABLISH  
A PHILANTHROPIC FUND WHICH WOULD BE USED EXCLUSIVELY TO  
MAINTAIN AND PRESERVE THE JEWISH CEMETERY IN DONALDSONVILLE,  
LA.

THE FUND WOULD BE MANAGED BY THE NEW ORLEANS  
RABBINICAL COUNCIL IN CONSULTATION WITH HEBREW REST CEMETERY  
ASSN.

ANNUALLY, THE RABBINICAL COUNCIL WOULD TAKE ALL  
MEMBERS OF THE 7TH OR 8TH GRADES OF ALL RELIGIOUS SCHOOLS  
TO DONALDSONVILLE, FOR A ONE-DAY TRIP. THE PURPOSE OF THE  
VISIT IS TO HAVE THE KIDS HELP CLEAN AND MAINTAIN THE CEMETERY,  
LET THEM SEE THE CEMETERY AND LEARN ABOUT A SMALL JEWISH  
COMMUNITY, AND GIVE THEM IDEAS AS TO THE JEWISH VALUES AND  
RESPONSIBILITIES. ANNUALLY, THE CEMETERY WOULD BE RECONSECRATED.

ON THE TRIP, THERE WILL BE AT LEAST ONE RABBI,  
AND SOME PARENTS AS CHAPERONES. TWO HOURS WOULD BE SPENT  
CLEANING AND MAINTAINING THE CEMETERY. THEN LUNCH, AND A  
TALK BY SOMEONE ABOUT:

1. The history of the Donaldsonville Jewish  
community
2. The history of the Jews of Louisiana
3. History of N.O. Jewry and the N.O. Jewish  
organizations
4. Other outstanding events in Jewish history



in Louisiana such as:

- a. Sicily Island project
- b. West Indies Jews bringing sugar cane to Louisiana
- c. Judah Touro
- d. Etcetera

THE RABBINICAL COUNCIL SHOULD PREPARE A BOOKLET TO USE AT THIS TALK AND IT COULD BE DISTRIBUTED TO EACH CHILD TO TAKE HOME.

THE FUND WOULD REQUIRE CAPITAL IN THE AMOUNT OF \$30,000.00. THE INCOME ON THIS ENDOWMENT WILL BE USED AS FOLLOWS:

- 75% of income for upkeep and maintenance
- 15% of income to increase endowment
- 10% of income to JEF for expenses

THE DRIVE TO SECURE THE \$30,000.00 WOULD BE A JOINT EFFORT OF THE JEF, THE RABBINICAL COUNCIL, AND HEBREW REST CEMETERY ASSN. WE WOULD ASK HEBREW REST CEMETERY ASSN. TO DONATE \$12,000.00. RAISE \$12,000.00 FROM LOCAL SOLICITATIONS OF INDIVIDUALS AND JEWISH ORGANIZATIONS (MEN'S CLUB, SISTERHOODS, COUNCIL, HADASSAH, YOUTH GROUPS, ETC.) IN AMOUNTS OF \$250.00, \$500.00, AND \$1,000.00 GIFTS. THERE IS AN INDIVIDUAL IN DONALDSONVILLE WHO HAS AGREED TO GIVE \$6,000.00 IF OTHER MONIES ARE RAISED.



MUSEUM SURVEY

Community \_\_\_\_\_

President \_\_\_\_\_

Address \_\_\_\_\_

\_\_\_\_\_ City \_\_\_\_\_ State \_\_\_\_\_ Zip \_\_\_\_\_

Phone (\_\_\_\_) \_\_\_\_\_ (\_\_\_\_) \_\_\_\_\_  
Business Home

No. of members in Synagogue \_\_\_\_\_  
Adults Children

Highest Temple membership ever \_\_\_\_\_

Population of City \_\_\_\_\_

Do you have rabbinic services? \_\_\_\_\_

If so, describe (full time, etc.) \_\_\_\_\_

If no, please complete the next 3 blanks

When did you last have a rabbi? \_\_\_\_\_

How often do you have services? \_\_\_\_\_

Who conducts them? \_\_\_\_\_

How many people attend services on a regular basis? \_\_\_\_\_

Do you own a building? \_\_\_\_\_

If no, where are the services held? \_\_\_\_\_

If yes, when was it built? \_\_\_\_\_

Are there any stained glass windows? \_\_\_\_\_

If yes, please describe \_\_\_\_\_

Are there any photographs available? \_\_\_\_\_

How many Torahs does your synagogue have? \_\_\_\_\_

Is the ark a permanent part of the sanctuary? \_\_\_\_\_



Are there any other Jewish artifacts which belong to the congregation such as:

<input type="checkbox"/> Ner Tamid	<input type="checkbox"/> Torah Binders	<input type="checkbox"/> Spice Box
<input type="checkbox"/> Candlesticks	<input type="checkbox"/> Torah Breastplate	<input type="checkbox"/> Murals
<input type="checkbox"/> Ark	<input type="checkbox"/> Kiddush Cups	<input type="checkbox"/> Paintings
<input type="checkbox"/> Mezuzah	<input type="checkbox"/> Yad (Torah Pointer)	
<input type="checkbox"/> Other _____		

Are these objects still used by the congregation? \_\_\_\_\_

If not, where are they? \_\_\_\_\_

Would you be willing to have them displayed as part of the museum? \_\_\_\_\_

Is there a written history of your congregation? \_\_\_\_\_

If not, are there copies of news stories that contain historical data? \_\_\_\_\_

Is there someone in the congregation who knows the history of your congregation? \_\_\_\_\_

Are there scrapbooks and/or photographs of temple events? \_\_\_\_\_

Do you have a cemetery? \_\_\_\_\_

Is it documented? \_\_\_\_\_

Can you identify families for us who have left the area who were once prominent in your community who might have information, photographs or artifacts for the museum?  
\_\_\_\_\_  
\_\_\_\_\_

Please use this space for additional comments regarding your Jewish community and its history.

We appreciate your participation in this survey. Please return it in the envelope provided to:

Museum/Synagogue Project  
P. O. Box 16528  
Jackson, MS 39236-0528



1969

1987

ARKANSAS:

Blytheville - Temple Israel	40	28
Eldorado	10* *	0
Fayetteville	0	40
Fort Smith - United Hebrew	56	40
Helena - Beth El	70	46
Hot Springs - House of Israel	150	64
Jonesboro - Temple Israel	36	23
Little Rock - B'Nai Israel	348	382
McGehee/Dumas - Meir Chayim Temple	28	20
Pine Bluff - Anshe Emeth	70	69

LOUISIANA:

Alexandria - Gemiluth Chassodim	178	161
Baton Rouge - B'Nai Israel	212	253
Baton Rouge - Liberal	84	158
Lafayette - Rodeph Sholom *	[	44
Lafayette - Yeshurun Synagogue *	82 [	35
Morgan City - Shaare Zedek *	[	0
Lake Charles - Temple Sinai	55	83
Metairie - Gates of Prayer	400	575
Monroe - B'Nai Israel	189	156
New Iberia - Gates of Prayer	29	35
New Orleans - Temple Sinai	913	950
New Orleans - Touro Synagogue	750	707
Opelousas - Temple Emanuel *	[	
Shreveport - B'Nai Zion	400	321

MISSISSIPPI:

Clarksdale - Beth Israel	100	58
Cleveland - Adath Israel	79	56
Columbus - B'Nai Israel	27	25
Greenville - Hebrew Union Congregation	169	138
Greenwood - Beth Israel	20	5
Hattiesburg - B'Nai Israel	27	68
Jackson - Beth Israel	138	232
Lexington - Beth El	15	13
Meridian - Beth Israel	100	44
Natchez - B'Nai Israel	60	29
Port Gibson - Gemiluth Chasadim	6* *	0
Rolling Fork		0
Vicksburg - Anshe Chesed	105	85

\* were considered one congregation in 1969

\*\* approximate

*Jacobs Camp  
Synagogue / Museum*

December 2, 1986

Memo to: Rabbi Schindler

From : Smitty

Re: Macy Hart and Museum

I have read Macy's memo about the Museum and the need for full time staff. Macy also told me you will be meeting with him at the Board Meeting. There are a few issues which I believe to be important:

1. The UAHC must decide how far it wants this to go and whether in fact there really is the type potential concerning which Macy speaks.
2. Jacobs Camp is a 180 Camper Bed Facility, the smallest of the UAHC. This is not meant to put down anyone or the institution. The Camp has become a major educational facility for the deep south and has incredible lay support. However, to suggest that Macy needs two full time assistants is perverse. Build the new facility first, then let's see.
3. In terms of the facility, if it is on Camp property, it should be built under the directions and guidelines of the NCCI. I know that Macy does not like this. He always likes to work alone under his own guidelines. I think it would be a big mistake not to be very clear that this operation will be carefully supervised.

I just believe that this must be kept in proper perspective. I am in the office Wednesday Afternoon and Thursday Morning. I am picking up Mel and Harry Thursday PM and then am at Stouffers for the duration if you need me.



Give us the strength to be gentle  
the wisdom to be confused  
the right to be wrong on occasion  
the sense to know when to lose.  
Give us the time to be patient  
the courage to be afraid.  
Give us the eyes of children again  
to see the world — a different world —  
a world that can still be made.

from **The Tap Dance Kid**  
"William's Song"  
Lyrics by Robert Lorick

ce  
November 21, 1986

FEDERAL EXPRESS

Rabbi Alexander Schindler  
Rabbi Daniel Syme  
Union of American Hebrew Congregations  
838 Fifth Avenue  
New York, New York 10021

RE: Museum of the Southern Jewish  
Experience

Dear Alex and Danny:

This is a difficult letter to compose because there is so much to convey. We shall not attempt to capture in writing all that is necessary, but merely hit some essential and crucial points. The main issue is that we believe that an immediate meeting must be held to allow us sufficient time to make you aware of how magnificent this project has, or can, become.

When we were first notified that someone was interested in funding this museum, we advised that we were not ready to undertake a project of this magnitude. We were finishing a 15,000 square foot Activities Center for which we had raised over \$700,000 in pledges and cash. We had every detail on that building identified because we had had sufficient time to prepare and plan. Now that the Activities Center is complete, there are no mistakes, none of the "I wish we had thought of that" type problems, because simply we had thought of and planned for all possibilities.

Even though we protested that we were not ready for the current project, you insisted that we proceed anyway, because we had a chance for immediate funding. Hurriedly, we put together a package that, you remember, called for a 3,000 square foot building and a budget of \$190,000. You presented that to Jocelyn, and she expressed interest. We were then instructed to submit a real budget and floor plan. This time, we had six weeks to do it right, and we then submitted

**Henry S. Jacobs  
Camp**

Macy B. Hart  
Camp Director

David B. Grishman  
Chairman, Board of Directors

Summer  
Utica, Mississippi 39175  
(601) 885-6042

Winter  
P. O. Box 16528  
Jackson, Mississippi 39236-0528  
(601) 362-6357



Rabbi Alexander Schindler  
Rabbi Daniel Syme  
November 21, 1986  
Page Two

a proposal for 8,000 square feet and \$540,000. The plan in itself is good, but it is way off in what it can be.

When we began, we had no idea that the project would become such a magnificent one. The reason that we are now seeing an outpouring of interest is simply because many of these small communities in the deep South are dying and are desperate to have their Jewish contributions and sentiments preserved. Macy travelled with our consultant for eleven days in October. Each day brought something phenomenal, and doors that were not even previously approached opened.

The scope of the museum has changed -- merely by the fact that there will be one! Presently, two universities are ready to publicize this project, and in fact, assist with additional funding. The State Department of Archives and History has already been a tremendous help and source of information. The American Jewish Archives is interested, as well. No one previously has helped plan for a community's demise. We are creating a model of a last will and testament for many small congregations. These are great treasure houses that are fading fast.

Here are some of the problems:

1. This is a major project in which you must become involved to comprehend the vast potential.
2. We need several full time staff members working on this project immediately. Our part time consultant needs to be on this job full time immediately.
3. Macy has been working on this project almost full time since September, but we have a Camp to operate. Is Macy going to be freed to head this project? Are you going to allow us to hire another assistant director to handle the Camp under his supervision?
4. Editorial staff from Reform Judaism should have already been here to prepare a feature article. We need publicity, and we need it properly coordinated. The article from Richard Cohen's office took far too long. Please do not say that we took too long to get pictures. We took three different sets of pictures and air expressed them each time they were asked for. We had a photographer at Camp all summer. He took a set of what was requested. After Camp was over, when we no longer had a photographer standing by, we were asked for something different, and so it went. The request



Rabbi Alexander Schindler  
Rabbi Daniel Syme  
November 21, 1986  
Page Three

should have come to us in early June, after we had been given the grant.

5. This project can be one of the most innovative, impressive and important undertakings the UAHC has ever undertaken. It is not simply another Camp project that can be quickly thrown together. The possibilities of this being a major Jewish museum is real. We are only limited by our imagination. The implications for the orderly transition of small Jewish communities everywhere are vast.

6. We cannot move in any direction until you decide what you want. We are at a complete standstill. If we are to proceed with what we have, we can do that, but the project will fall far short of what it should be and must be. Time is of the essence!

7. Do we approach one of these universities and make a commitment to work with them only? Do we have the authority to make this decision on our own? Do we try to work with more than one? Are there others who want to share in what we are assembling?

8. Are you willing to approach other big givers for some help on this project?

9. Attached is a brief analysis of what the UAHC can offer and receive in return.

We believe that it is imperative that we meet face to face and bring you up-to-date. It is crucial that we get moving because the Plough Foundation wants a report as to how we are progressing.

We are willing to meet with you in New York, or certainly you are welcome to come South. We would love to have you visit. It will make you a believer in what is really here and what can be.

Sincerely,

  
David B. Grisaman

  
Macy B. Hart

DBG:sj  
enclosure

**WHAT UAHC CAN OFFER THE MUSEUM PROJECT:**

- \*access to and assistance in acquisition of major funds
- \*credibility for the project
- \*standing within the national community
- \*staff, equipment and resources, for example the publishing company
- \*support and recognition for our project
- \*priority in publicity efforts (i.e. REFORM JUDAISM Dick Cohen)
- \*Alexander Schindler and Daniel Syme to grasp the magnitude of the Museum and project it with vision.
- \*minimum of a full time staff person to administer the project (Macy B. Hart?) -- if not that, then another Assistant Camp Director under Macy's supervision

**WHAT UAHC STANDS TO GAIN:**

- \*prestige
- \*recognition for the most visionary approach and responsibility to/for a constituency
- \*credit for recognizing a people's contribution within the development of a community
- \*world-wide recognition for their creativity and vision
- \*creation and development of a **model for the transition** of Jewish communities throughout the United States
- \*source of potential income and new sources of funding and support
- \*curriculum(s), catalogues and publications to their credit
- \*whole new area of scholarship and research
- \*impact on the overall Jewish community
- \*interest/affiliations by universities and institutions
- \*international acclaim
- \*credibility, respect and enhanced image



Give us the strength to be gentle  
the wisdom to be confused  
the right to be wrong on occasion  
the sense to know when to lose.  
Give us the time to be patient  
the courage to be afraid.  
Give us the eyes of children again  
to see the world — a different world —  
a world that can still be made.

from **The Tap Dance Kid**  
"William's Song"  
Lyrics by Robert Lorick

November 21, 1986

FEDERAL EXPRESS

Rabbi Alexander Schindler  
Rabbi Daniel Syme  
Union of American Hebrew Congregations  
838 Fifth Avenue  
New York, New York 10021

RE: Museum of the Southern Jewish  
Experience

Dear Alex and Danny:

This is a difficult letter to compose because there is so much to convey. We shall not attempt to capture in writing all that is necessary, but merely hit some essential and crucial points. The main issue is that we believe that an immediate meeting must be held to allow us sufficient time to make you aware of how magnificent this project has, or can, become.

When we were first notified that someone was interested in funding this museum, we advised that we were not ready to undertake a project of this magnitude. We were finishing a 15,000 square foot Activities Center for which we had raised over \$700,000 in pledges and cash. We had every detail on that building identified because we had had sufficient time to prepare and plan. Now that the Activities Center is complete, there are no mistakes, none of the "I wish we had thought of that" type problems, because simply we had thought of and planned for all possibilities.

Even though we protested that we were not ready for the current project, you insisted that we proceed anyway, because we had a chance for immediate funding. Hurriedly, we put together a package that, you remember, called for a 3,000 square foot building and a budget of \$190,000. You presented that to Jocelyn, and she expressed interest. We were then instructed to submit a real budget and floor plan. This time, we had six weeks to do it right, and we then submitted

**Henry S. Jacobs  
Camp**

Macy B. Hart  
Camp Director

David B. Grishman  
Chairman, Board of Directors

Summer  
Utica, Mississippi 39175  
(601) 885-6042

Winter  
P. O. Box 16528  
Jackson, Mississippi 39236-0528  
(601) 362-6357





Rabbi Alexander Schindler  
Rabbi Daniel Syme  
November 21, 1986  
Page Two

a proposal for 8,000 square feet and \$540,000. The plan in itself is good, but it is way off in what it can be.

When we began, we had no idea that the project would become such a magnificent one. The reason that we are now seeing an outpouring of interest is simply because many of these small communities in the deep South are dying and are desperate to have their Jewish contributions and sentiments preserved. Macy travelled with our consultant for eleven days in October. Each day brought something phenomenal, and doors that were not even previously approached opened.

The scope of the museum has changed -- merely by the fact that there will be one! Presently, two universities are ready to publicize this project, and in fact, assist with additional funding. The State Department of Archives and History has already been a tremendous help and source of information. The American Jewish Archives is interested, as well. No one previously has helped plan for a community's demise. We are creating a model of a last will and testament for many small congregations. These are great treasure houses that are fading fast.

Here are some of the problems:

1. This is a major project in which you must become involved to comprehend the vast potential.
2. We need several full time staff members working on this project immediately. Our part time consultant needs to be on this job full time immediately.
3. Macy has been working on this project almost full time since September, but we have a Camp to operate. Is Macy going to be freed to head this project? Are you going to allow us to hire another assistant director to handle the Camp under his supervision?
4. Editorial staff from Reform Judaism should have already been here to prepare a feature article. We need publicity, and we need it properly coordinated. The article from Richard Cohen's office took far too long. Please do not say that we took too long to get pictures. We took three different sets of pictures and air expressed them each time they were asked for. We had a photographer at Camp all summer. He took a set of what was requested. After Camp was over, when we no longer had a photographer standing by, we were asked for something different, and so it went. The request



Rabbi Alexander Schindler  
Rabbi Daniel Syme  
November 21, 1986  
Page Three

should have come to us in early June, after we had been given the grant.

5. This project can be one of the most innovative, impressive and important undertakings the UAHC has ever undertaken. It is not simply another Camp project that can be quickly thrown together. The possibilities of this being a major Jewish museum is real. We are only limited by our imagination. The implications for the orderly transition of small Jewish communities everywhere are vast.

6. We cannot move in any direction until you decide what you want. We are at a complete standstill. If we are to proceed with what we have, we can do that, but the project will fall far short of what it should be and must be. Time is of the essence!

7. Do we approach one of these universities and make a commitment to work with them only? Do we have the authority to make this decision on our own? Do we try to work with more than one? Are there others who want to share in what we are assembling?

8. Are you willing to approach other big givers for some help on this project?

9. Attached is a brief analysis of what the UAHC can offer and receive in return.

We believe that it is imperative that we meet face to face and bring you up-to-date. It is crucial that we get moving because the Plough Foundation wants a report as to how we are progressing.

We are willing to meet with you in New York, or certainly you are welcome to come South. We would love to have you visit. It will make you a believer in what is really here and what can be.

Sincerely,



David B. Grishman

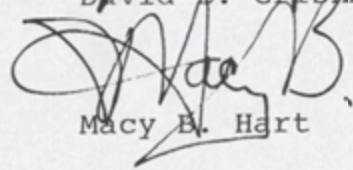

Macy B. Hart

DBG:sj  
enclosure



**WHAT UAHC CAN OFFER THE MUSEUM PROJECT:**

- \*access to and assistance in acquisition of major funds
- \*credibility for the project
- \*standing within the national community
- \*staff, equipment and resources, for example the publishing company
- \*support and recognition for our project
- \*priority in publicity efforts (i.e. REFORM JUDAISM Dick Cohen)
- \*Alexander Schindler and Daniel Syme to grasp the magnitude of the Museum and project it with vision.
- \*minimum of a full time staff person to administer the project (Macy B. Hart?) -- if not that, then another Assistant Camp Director under Macy's supervision

**WHAT UAHC STANDS TO GAIN:**

- \*prestige
- \*recognition for the most visionary approach and responsibility to/for a constituency
- \*credit for recognizing a people's contribution within the development of a community
- \*world-wide recognition for their creativity and vision
- \*creation and development of a model for the transition of Jewish communities throughout the United States
- \*source of potential income and new sources of funding and support
- \*curriculum(s), catalogues and publications to their credit
- \*whole new area of scholarship and research
- \*impact on the overall Jewish community
- \*interest/affiliations by universities and institutions
- \*international acclaim
- \*credibility, respect and enhanced image





*Excellent  
file*

RABBI ALEXANDER M. SCHINDLER • UNION OF AMERICAN HEBREW CONGREGATIONS  
PRESIDENT 838 FIFTH AVENUE NEW YORK, N.Y. 10021 (212) 249-0100

December 11, 1989  
13 Kislev 5750

Mr. Melvin Merians  
10 Bonnie Briar Lane  
Larchmont, NY 10538

Dear Mel:

I know that Smitty sent you a copy of the full Synagogue-Museum file, most of which, incidentally, was in Edie's file cabinet. Thanks to her we have the records.

As you will see, Macy made his initial proposal in late November, 1986. We did meet with him at a Board meeting in Westchester County (I can't for the world of me remember who was there but I believe it was with Chuck Rothschild). At any rate, my letter of February 11, 1987 summarizes our discussion in this realm and sets the limit of his authority to move.

Warm regards.

Sincerely,

Alexander M. Schindler

cc: Allan B. Goldman, Esq.  
Encl.



*Synagogue Museum*

February 11, 1987

12 Shevat 5747

Mr. Macy B. Hart, Director  
UAHC Jacobs Camp Institute  
Box T6528  
Jackson, MS. 39236-0528

Dear Macy:

I assume that you have already heard by phone of the general responses to the Museum Project Proposal. I have reviewed the proposal in great detail and want to express my personal feelings to you.

It seems very clear to all of us that there is great interest in this project, not only in your own Jewish community but in the general community as well. Whether such interest can be translated into active support is a question to be determined. For the immediate future, my specific interests are as follows:

1/ The Facility: The Synagogue/Exhibit Area should be planned out and executed in accordance with the Plough Foundation donation, as soon as is possible. As the facility will be part of the Jacobs Camp, this means getting the necessary Camp Committee and Board approvals quickly. I have asked Smitty to assist you in this area to insure the least possible complications. I am sure that a suitable facility can be completed with the funds available. I know that you will need to hold some monies back for appropriate program support.

2/ The Synagogue Trust Fund: I am most intrigued with what I consider to be a sacred trust that we have relative to congregations which cease their operations. To be the guardians of their cemeteries and artifacts is a task which we should attempt to undertake. To that end, I will be forming a national committee with input from yourself and your leadership. I have discovered that this is an area of concern not only for the South but for many congregations in various locations.

3/ The Expanded Project: HUC-JIR has Archives and a Museum. I do not feel that the Union is prepared to enter into an expanded Museum venture of the scope suggested in your proposal. I suggest that consultations be held with the College-Institute to see if they are interested. If so, we



Mr. Macy B. Hart  
February 11, 1987  
Page -2-

will go from there. If not, I understand that there are interested agencies in your area who might be willing to assist in Grant Proposals for such a project. There is no reason why these should not be pursued in the future once the facility is in place.

4/ Sacred Object Loan Program: As the Jacobs Synagogue/Museum becomes the repository of large quantities of Synagogue Sacred Objects and Art, a loan program to new congregations and havurot could be established through the facility.

There are some practical considerations. I know that the project, even within the limited scope, will require much of your time. Our Camp Directors have all had the responsibility of major development on the Camp properties. At times, some extra part time help was needed. I suggest that the same is true in this case. It might be necessary for you to have a rabbinic intern during the next year or so to help with the programmatic aspects outlined above. I believe that this can be done within the existing Grant structure. Macy, all of us know that the success of the Jacobs Camp has been related in large measure to your function as Camp Director. I do not want to jeopardize that. Your prime responsibility must be the Camp and its development. We will assist you in whatever way possible with the normal constraints of time and budget.

Please be in touch with Danny and Smitty as matters progress. Thanks for your vision and your dedication.

Warm regards,

Sincerely,

Alexander M. Schindler

cc: David Grishman, Esq.  
Rabbi Allan Smith  
Rabbi Daniel Syme

Box 427 39205



KEEPING THE STORY ALIVE



MUSEUM OF THE SOUTHERN JEWISH EXPERIENCE



OUR STORY BEGINS ALMOST TWO CENTURIES AGO, WHEN THOUSANDS  
OF EUROPEAN JEWS GATHERED THEIR MEAGER BELONGINGS AND RICH  
RELIGIOUS TRADITIONS AND EMBARKED UPON A FORMIDABLE JOURNEY IN  
SEARCH OF NEW OPPORTUNITIES IN THE NEW WORLD. CONFRONTED  
WITH THE SWEATSHOPS AND SMOKESTACKS OF AMERICA'S INDUSTRIAL  
NORTHEAST IN THE 19TH CENTURY, MANY OF THESE JEWISH FAMILIES  
MIGRATED TO THE GREEN HILLS AND FERTILE BOTTOMLANDS OF THE  
DEEP SOUTH. THEY FOUND WORK WHEREVER THEY COULD — ON  
FARMS, IN SHOPS, OR AS PEDDLERS, BRINGING HARD-TO-FIND CLOTHING  
AND HOUSEHOLD ITEMS TO REMOTE RURAL SETTLEMENTS. AS THEIR  
LABORS BROUGHT THEM PROSPERITY, THEY SENT FOR THEIR RELATIVES  
AND BECAME DEEPLY ROOTED IN THE SOUTHERN SOIL.



## SUSTAINING THE FAITH

These Southern Jews established themselves as enthusiastic, dedicated citizens of their communities. Some Americanized their names — "Goldsmith," "Rosenzweig," and "Applebaum" were transformed into "Smith," "Rose," and "Apple." Their children grew up to become merchants, planters, and professionals. In towns and cities throughout the South, they built synagogues in which to keep their faith and nourish their heritage, and they established cemeteries to honor their dead. By choice of locale and lifestyle they were Southerners, but by religion and heritage they were Jews, courageous pioneers bringing the Jewish experience to the American South.



## TIME TAKES ITS TOLL

Times change, populations shift, and our story continues. Generations of young Southerners — Jews among them — left their small hometowns for more promising careers in larger cities. While Jewish culture thrived in the metropolitan centers, Jewish congregations dwindled in the smaller communities, and historic rural synagogues which had once flourished as centers of worship and heritage were abandoned, their original architecture hardly recognizable, their initial purpose forgotten. Other places of worship were stripped of their religious and historic treasures. These beautiful artifacts, testaments to a pioneering Jewish presence in the South, were scattered among individuals, sold on the open market to the highest bidder, or lost altogether. In many small towns, the story of the southern Jewish experience survives only as a dusty relic or a cherished memory.

## CHOOSING A DIRECTION

As we reach the present day, the story of the southern Jewish experience continues to unfold. At this point in our story, however, a choice of two directions confronts us. The first direction leads to the continued decline and eventual disappearance of identifiable Judaism in the small towns and rural areas of the American South. The second direction, on the other hand, can bring us to a celebration of this distinguished legacy and a renewed vitality in southern Jewish culture. Clearly, it is the second direction that we must choose — a direction which points unmistakably toward the Museum of the Southern Jewish Experience.

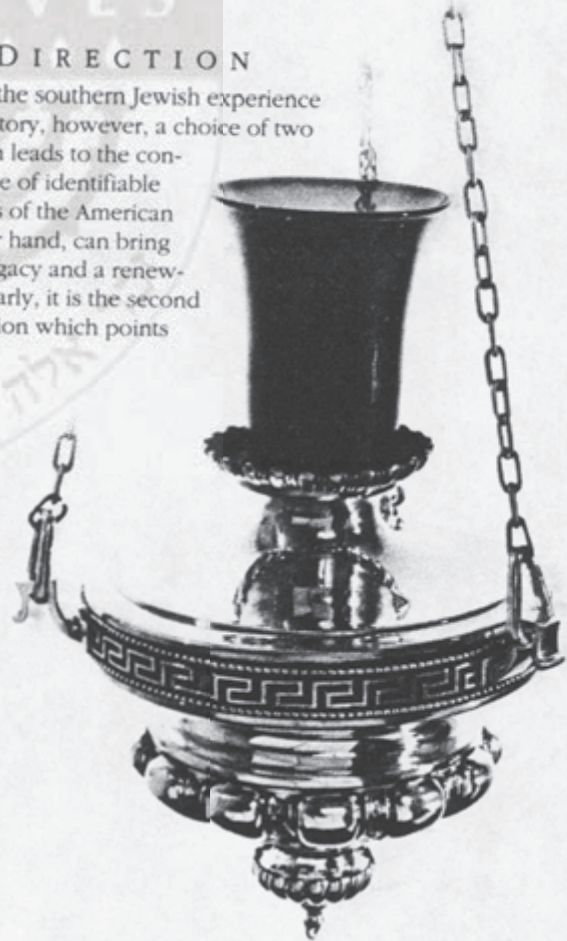



## A LIVING TRIBUTE

The Museum of the Southern Jewish Experience will stand as both an enduring tribute to the past and a radiant beacon for the future. It will commemorate the history of Southern Jews by documenting their heritage and contributions and preserving their religious and historical artifacts. The Museum will also reach beyond its own walls to assist small rural congregations in the restoration and maintenance of synagogues and



cemeteries. And, through Museum programs of educational outreach, the depth and richness of Southern Jewish history and culture will come alive for Jew and non-Jew alike.

The Henry S. Jacobs Camp for Living Judaism, located just southwest of Jackson, Mississippi, offers a uniquely appropriate site for the Museum of the Southern Jewish Experience. Since its founding in 1970, members of disbanded congregations have entrusted Jacobs Camp with Torahs, breastplates, mantles, stained glass, and other relics of historic, cultural, and artistic significance. These items will form the Museum's core collection. They will be permanently displayed in a setting of narrative panels, graphics, and photographs relating the story of Judaism in the South.

To supplement the permanent collection, special displays will be mounted on a regular basis, featuring artifacts on loan to the Museum and items chosen from the Museum's collection. These displays will present more detailed studies of specific aspects of Southern Jewish culture — synagogue architecture in the South, or the experiences of early Jewish merchants, or Jewish participation in the Civil War or the Civil Rights era.

Finally — and, perhaps, most significantly — the Museum of the Southern Jewish Experience with its ornate tapestry of history and heritage will serve as a magnificent setting for an active, modern-day synagogue. Enhanced by decorative and religious objects from synagogues of the past, services within this synagogue will represent a compelling fusion of yesterday and tomorrow. While celebrating the Jewish community's ancestral struggle for existence, the synagogue will inspire today's southern Jewish congregations to keep that struggle alive as a legacy for generations yet to come.





## RACING AGAINST TIME

In 1986, the Plough Foundation of Memphis, Tennessee, granted more than \$500,000 for construction of a facility to house and exhibit the growing collection of Judaica and southern Jewish memorabilia currently in the custody of the Henry S. Jacobs Camp. Several fact-finding trips into a cluster of small communities, supported by the Plough grant, indicated the need for a southern Jewish museum which could also act as an umbrella organization, encouraging and supporting the preservation and revitalization of Jewish culture in the South.



The trips made it apparent — in no uncertain terms — that we are engaged in a race against time. Many objects of historical, religious, and artistic significance have been uncovered, but many others have been displaced over the years, scattered among various owners or held by small, endangered rural congregations. The study pointed out a number of formerly or presently active Jewish congregations which would benefit from the services of the proposed museum. Jewish landmarks throughout the southern states, unprotected and undocumented, face the inexorable onslaught of deterioration. Conversations with Jews and non-Jews throughout the area revealed that many details of the southern Jewish experience are currently documented only in the memories of a declining number of living individuals.

The Museum of the Southern Jewish Experience will reverse this deterioration of our heritage and culture. Religious objects will be collected, catalogued, and conserved. Jewish architecture will be photographed, and restoration efforts will be supported. Family photographs, correspondence, and memoirs will be compiled, edited, and published. These preservation efforts will be amplified through original research into Jewish contributions to the general southern culture. A speakers bureau and travelling exhibits will deliver authoritative presentations on southern Jewish heritage to academic and civic audiences, focusing on those areas in which there is no longer a significant Jewish presence.





## ACCEPTING THE RESPONSIBILITY

Since its inception, the Museum project has been supported by members of Jewish communities throughout the South. The current Museum development committee is comprised of two highly qualified, dedicated, and active community members, a professional museum consultant, and a representative of Jacobs Camp. Once the Museum has been established, this planning group will evolve into a board of governors with responsibility for the Museum's constitution and policies of operation. A professional staff will carry out such curatorial duties as conservation of artifacts, exhibit design, research, and development of educational programs. Supplementing the staff will be a team of volunteers, including knowledgeable representatives from local Jewish communities who will direct collecting, cataloguing, and documenting activities in their home areas.

## ENCOURAGEMENT AND SUPPORT

Plans for the creation of a Museum of the Southern Jewish Experience have been supported and encouraged by many respected institutions, including the Southern Jewish Historical Society, The Jewish Museum of New York, the Hebrew Union College Skirball Museum in Los Angeles, the American Jewish Archives in Cincinnati, the Southern Jewish Archives of Tulane University in New Orleans, and the Center for the Study of Southern Culture at the University of Mississippi. Other contributions, both direct and indirect, have also been received from widely diverse sources:

*The original Jewish immigrants who came to settle in the South, bearing with them their Old World culture, their family traditions, and their abiding faith.*

*The small band of Jewish parents who came together three decades ago to conceive a regional camp for their children — a camp that has grown into a major cultural center and resource for Jewish families throughout the South.*

*The members of endangered Jewish congregations in small southern towns who have cared enough to retrieve irreplaceable religious artifacts and place them with Jacobs Camp for safekeeping.*

*The Plough Foundation and other institutions who have contributed financial or logistical support in an effort to keep the vision of a southern Jewish museum alive.*





## REALIZING THE DREAM

Even with all this invaluable support, however, the Museum of the Southern Jewish Experience remains a dream. For the dream to become reality, the Museum's planners must depend on dedicated assistance from the members of the Jewish community and from all those who wish to take pride in and preserve the legacy of the South and the history of the United States.

First and foremost, financial commitments are required — firm, significant financial commitments which can underwrite the employment of a thoroughly professional staff, support regional collection and conservation endeavors, and pay for the day-to-day operation of the Museum and its programs.

While funding is a primary concern, the Museum will not be able to carry out its planned activities without a devoted corps of enthusiastic volunteers. These vital team members will be called upon to contribute their time and energies toward projects in the fields of research, documentation, artifact procurement, and architectural preservation.

And finally, the stature and significance of the Museum's collection will be largely dependent upon those who are generous enough to donate items of religious, artistic, and historic importance. By entrusting their treasures to the safekeeping and professional care of the Museum and its staff, these visionary donors will be forging a vital link between those who initiated our ancient heritage and those who will carry that heritage into the future.

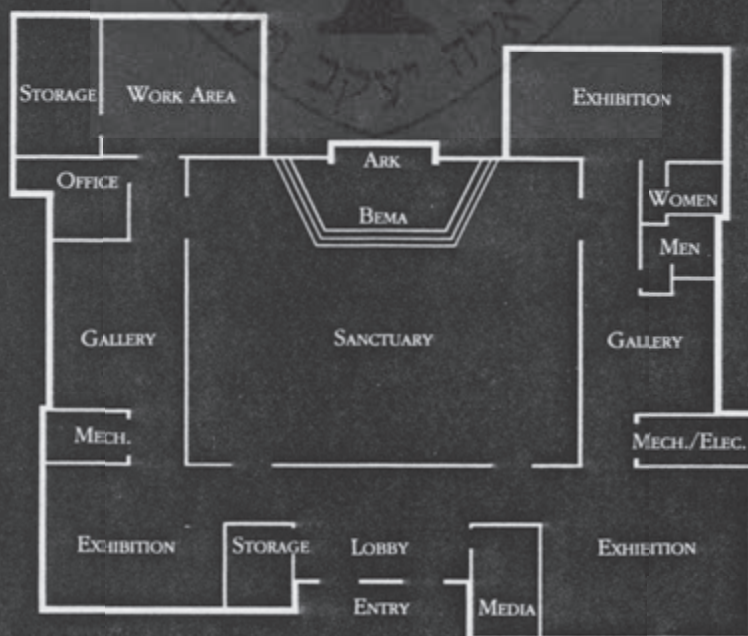



## CELEBRATING THE STORY

The story of Jews in the American South is an exciting, inspiring tale of personal courage, community solidarity, and profound faith. It is a story which deserves celebration and preservation for the continuing edification of tomorrow's generations. The Museum of the Southern Jewish Experience can keep the story alive and vital, but only with your generous financial contributions and your energetic personal support.

Gifts to the Museum are tax-deductible as allowed by law.  
Make your commitment today.



MUSEUM  
OF THE  
SOUTHERN  
JEWISH  
EXPERIENCE

a project of the Henry S. Jacobs Camp  
P.O. Box 16528 Jackson, MS 39236-0528 (601) 362-6357





November 16, 1989

Rabbi Daniel B. Syme  
Union of American Hebrew Congregations  
838 Fifth Avenue  
New York New York 10021

Dear Dan:

Thank you for your note acknowledging receipt of the museum information. I hope you find it interesting and something that you could work with.

Alex and I met for quite some time on Tuesday following the Biennial. What was agreed to by us with regard to the museum, as I understand it, is as follows: Any monies that are raised with the assistance of UAHC executives, such as Alex or yourself, will incur a 15% administrative charge. Any funds raised through our own committees (outside monies) will go directly to benefit the museum without the deduction of the 15% surcharge.

This appears to me to be a fair and equitable arrangement and I look forward to working with you on this project. I would love for you to schedule one of your out-of-town trips so you could come through Jackson either coming or going. I believe once you see our facility, you will be mightily impressed. You will then understand our persistence in the Museum being a top priority.

It will be a pleasure for the Museum Committee to work with the UAHC in its endorsement of this project as we seek funds for the growth and development of the Museum outside our geographical sphere. I have always maintained that this project will attract funds if we have the right presentation.

I hope all is well with you and I am sorry we did not have a chance to visit in New Orleans. I appreciated your telephone call of earlier weeks. We had our strained moments in the past, but everyone is happy with each other right now.

With affection,

Sincerely yours,

Macy B. Hart

MBH/lpm

xc: Rabbi Allan Smith  
Dr. Julian Wiener

Dr. and Mrs. Julian Wiener  
Project Co-Chairmen

Vicki Reikes Fox  
Project Director

David B. Grishman  
Past Chairman Board of Directors  
Henry S. Jacobs Camp

Macy B. Hart  
Director  
Henry S. Jacobs Camp



HENRY S. JACOBS U.A.H.C. CAMP INSTITUTE  
UTICA, MISSISSIPPI  
INTERIM FINANCIAL STATEMENTS  
AUGUST 31, 1989

AMERICAN ISRAELI  
ARCHIVES  
1948-1989





HENRY S. JACOBS U.A.H.C. CAMP INSTITUTE  
UTICA, MISSISSIPPI  
OPERATIONS FUND  
INDEX TO REPORT  
AUGUST 31, 1989

	<u>PAGE</u>
Accountant's Compilation Report	1
Balance Sheet	2
Statement of Support and Revenue, Expenses, Capital Additions and Changes in Fund Balance	3

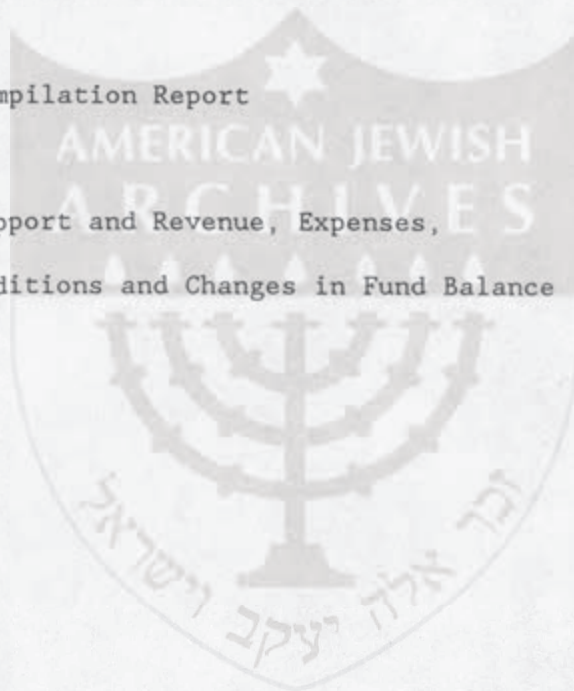





## Wilson & Schloemer

Certified Public Accountants

P. O. Box 4920 Jackson, MS 39216 (601) 366-1636

To the Directors  
Henry S. Jacobs U.A.H.C. Camp Institute  
Utica, Mississippi

We have compiled the accompanying balance sheet of Henry S. Jacobs U.A.H.C. Camp Institute as of August 31, 1989, and the related statement of support and revenue, expenses, capital additions and changes in fund balance for the ten months then ended, in accordance with standards established by the American Institute of Certified Public Accountants.

A compilation is limited to presenting in the form of financial statements information that is the representation of management. We have not audited or reviewed the accompanying financial statements and, accordingly, do not express an opinion or any other form of assurance on them.

Management has elected to omit substantially all of the disclosures and the statement of changes in financial position required by generally accepted accounting principles. If the omitted disclosures and statement of changes in financial position were included in the financial statements, they might influence the user's conclusions about the Organization's financial position and results of operations. Accordingly, these financial statements are not designed for those who are not informed about such matters.

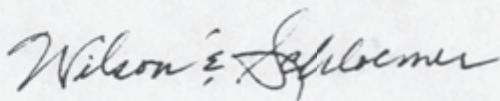

October 3, 1989



HENRY A. JACOBS U.A.H.C. CAMP INSTITUTE  
UTICA, MISSISSIPPI  
OPERATIONS FUND  
BALANCE SHEET  
AUGUST 31, 1989

ASSETS

Cash	\$ 6,150	
Receivables	17,178	
Inventories	17,037	
Prepaid Expenses	17,500	
Investments	<u>13,568</u>	
Total Assets		<u>\$ 71,433</u>

LIABILITIES AND FUND BALANCE

Accounts Payable	\$ 24,978	
Accrued Expenses	1,768	
Notes and Mortgages Payable	<u>17,265</u>	
Total Liabilities		\$ 44,011
Fund Balance		<u>27,422</u>
Total Liabilities and Fund Balance		<u>\$ 71,433</u>

See accountant's compilation report.



HENRY S. JACOBS U.A.H.C. CAMP INSTITUTE  
UTICA, MISSISSIPPI  
OPERATIONS FUND  
STATEMENT OF SUPPORT AND REVENUE, EXPENSES,  
CAPITAL ADDITIONS, AND CHANGES IN FUND BALANCE  
FOR THE TEN MONTH PERIOD ENDED AUGUST 30, 1989

SUPPORT AND REVENUE:

Fees	\$430,931
Canteen Revenue	31,179
Investment Income	5,009
Contributions	22,013
Camp Rentals and Other	<u>75,016</u>

Total Support and Revenue	\$564,148
---------------------------	-----------

EXPENSES:

Administrative	172,905
Commissary	74,099
Educational and Recreational	82,447
Plant Operations	89,369
Housekeeping	3,429
Other	<u>94,075</u>

Total Expenses	<u>516,324</u>
----------------	----------------

Excess of Support and Revenue over Expenses Before Capital Additions and Transfers	47,824
---	--------

CAPITAL ADDITIONS AND TRANSFERS:

Equipment Purchases	(2,097)
Provision for Replacement	(43,093)
Transfer from Scholarship Endowment	<u>3,638</u>

Total Capital Additions and Transfers	<u>(41,552)</u>
---------------------------------------	-----------------

Excess of Support and Revenue over Expenses After Capital Additions and Transfers	6,272
--	-------

Fund Balance (Deficit), Beginning Year	(3,035)
--	---------

Provision for Replacement Not Funded	<u>24,185</u>
--------------------------------------	---------------

Fund Balance, Year End	<u>\$ 27,422</u>
------------------------	------------------

See accountant's compilation report.



HENRY S. JAGGERS U.S.A. H. C. JAGGERS INSTITUTE  
IRVING, MISSISSIPPI  
ANNUAL REPORT  
OCTOBER 11, 1968



HENRY S. JACOBS U.A.H.C. CAMP INSTITUTE  
UTICA, MISSISSIPPI  
INDEX TO REPORT  
OCTOBER 31, 1988

	<u>PAGE</u>
Independent Accountants' Report	1
Balance Sheet	2
Statement of Support and Revenue, Expenses, Capital Additions and Changes in Fund Balances	3
Statement of Changes in Financial Position	5
Notes to Financial Statements	6
Independent Accountants' Report on Supplemental Data	9
Analysis of Balance Sheet Accounts - Operations Fund	10
Analysis of Revenue and Expenses - Operations Fund	11



Wilson & Schloemer

Certified Public Accountants

P. O. Box 4920 Jackson, MS 39216 (601) 366-1636

December 20, 1988

To the Directors  
Henry S. Jacobs U.A.H.C. Camp Institute  
Utica, Mississippi

We have audited the accompanying balance sheet of Henry S. Jacobs U.A.H.C. Camp Institute as of October 31, 1988, and the related statements of activity and changes in financial position for the year then ended. These financial statements are the responsibility of the organization's management. Our responsibility is to express an opinion on these financial statements based on our audit.

We conducted our audit in accordance with generally accepted auditing standards. Those standards require that we plan and perform the audit to obtain reasonable assurance about whether the financial statements are free of material misstatement. An audit includes examining on a test basis, evidence supporting the amounts and disclosures in the financial statements. An audit also includes assessing the accounting principles used and significant estimates made by management, as well as evaluating the overall financial statement presentation. We believe that our audit provides a reasonable basis for our opinion.

In our opinion, the financial statements referred to above present fairly, in all material respects, the financial position of Henry S. Jacobs U.A.H.C. Camp Institute as of October 31, 1988, and the results of its operations and of changes in financial position for the year then ended in conformity with generally accepted accounting principles.

*Wilson & Schloemer*

Certified Public Accountants



HENRY S. JACOBS U.A.H.C. CAMP INSTITUTE  
UTICA, MISSISSIPPI  
BALANCE SHEET  
OCTOBER 31, 1988

	<u>Operations Fund</u>	<u>Sustaining Fund</u>	<u>Plant Fund</u>	<u>Scholarship Fund</u>	<u>Total All Funds</u>
<u>ASSETS</u>					
Cash	\$ 3,693	\$ 11,720	\$ 2,268	\$	\$ 17,681
Accounts Receivable (Note 3)	26,834				26,834
Inventories	20,329				20,329
Prepaid Expenses	19,905				19,905
Investments (Note 2)	12,409	1,223	5,126	47,407	66,165
Land, Buildings and Equipment at Cost less Accumulated Depreciation of \$994,857 (Note 4)			957,453		957,453
Due From (To) Other Funds	967	(2,261)	1,419	(125)	0
Total Assets	<u>\$ 84,137</u>	<u>\$ 10,682</u>	<u>\$ 966,266</u>	<u>\$ 47,282</u>	<u>\$1,108,367</u>
<u>LIABILITIES AND FUND BALANCES</u>					
Accounts Payable	\$ 15,950	\$	\$	\$	\$ 15,950
Accrued Expenses	5,386	2,153	649		8,188
Deferred Camp Fees	15,218				15,218
Notes and Mortgages (Note 5)	50,618	83,500	40,000		174,118
Total Liabilities	<u>87,172</u>	<u>85,653</u>	<u>40,649</u>	<u>0</u>	<u>213,474</u>
Fund Balances (Deficit)					
Unrestricted	(3,035)	(74,971)			(78,006)
Restricted				47,282	47,282
Net Investment in Plant			925,617		925,617
Total Fund Balances	<u>(3,035)</u>	<u>(74,971)</u>	<u>925,617</u>	<u>47,282</u>	<u>894,893</u>
Total Liabilities and Fund Balances	<u>\$ 84,137</u>	<u>\$ 10,682</u>	<u>\$ 966,266</u>	<u>\$ 47,282</u>	<u>\$1,108,367</u>

See accompanying notes to financial statements.



HENRY S. JACOBS U.A.H.C. CAMP INSTITUTE  
UTICA, MISSISSIPPI  
STATEMENT OF SUPPORT AND REVENUE, EXPENSES,  
CAPITAL ADDITIONS AND CHANGES IN FUND BALANCES  
FOR THE YEAR ENDED OCTOBER 31, 1988

	<u>Operations</u> <u>Fund</u>	<u>Sustaining</u> <u>Fund</u>	<u>Plant</u> <u>Fund</u>	<u>Scholarship</u> <u>Fund</u>	<u>Total</u> <u>All</u> <u>Funds</u>
<u>SUPPORT AND REVENUE:</u>					
Fees	\$369,326	\$	\$	\$	\$369,326
Canteen Revenue	23,460				23,460
Investment Income	2,015	155	371	3,138	5,679
Contributions	15,407	57,139	45,794	4,656	122,996
Other	97,100				97,100
Total Support and Revenue	<u>507,308</u>	<u>57,294</u>	<u>46,165</u>	<u>7,794</u>	<u>\$618,561</u>
<u>EXPENSES:</u>					
Administrative	180,181	233	82		180,496
Commissary	73,849				73,849
Educational and Recreational	61,221				61,221
Plant Operations	93,044		3,170		96,214
Housekeeping	3,226				3,226
Other	114,794	1,466			116,260
Depreciation			117,674		117,674
Interest	2,563	10,607	4,776		17,946
Total Expenses	<u>528,878</u>	<u>12,306</u>	<u>125,702</u>	<u>0</u>	<u>666,886</u>
Excess (Deficiency) of Support and Revenue Over Expenses Before Capital Additions and Transfers	<u>(21,570)</u>	<u>44,988</u>	<u>(79,537)</u>	<u>7,794</u>	<u>(48,325)</u>
<u>CAPITAL ADDITIONS AND</u> <u>TRANSFERS:</u>					
Provision for Replacement	(36,933)		36,933		0
Transfer from Sustaining	7,500	(8,997)	1,497		0
from Operations	(1,519)		1,519		0
from Scholarship	3,886			(3,886)	0
Total Capital Additions and Transfers	<u>(27,066)</u>	<u>(8,997)</u>	<u>39,949</u>	<u>(3,886)</u>	<u>0</u>

See accompanying notes to financial statements.



HENRY S. JACOBS U.A.H.C. CAMP INSTITUTE  
UTICA, MISSISSIPPI  
STATEMENT OF SUPPORT AND REVENUE, EXPENSES,  
CAPITAL ADDITIONS AND CHANGES IN FUND BALANCES  
FOR THE YEAR ENDED OCTOBER 31, 1988

	<u>Operations</u> <u>Fund</u>	<u>Sustaining</u> <u>Fund</u>	<u>Plant</u> <u>Fund</u>	<u>Scholarship</u> <u>Fund</u>	<u>Total</u> <u>All</u> <u>Funds</u>
Excess (Deficiency) of Support and Revenue Over Expenses After Capital Additions and Transfers	\$ (48,636)	\$ 35,991	\$ (39,588)	\$ 3,908	\$ (48,325)
Fund Balances (Deficit), Beginning Year	23,582	(110,962)	987,224	43,374	943,218
Provision for Replacement Not Funded	<u>22,019</u>	<u>          </u>	<u>(22,019)</u>	<u>          </u>	<u>          0</u>
Fund Balances (Deficit), Year End	<u>\$ (3,035)</u>	<u>\$ (74,971)</u>	<u>\$ 925,617</u>	<u>\$ 47,282</u>	<u>\$894,893</u>

See accompanying notes to financial statements.



HENRY S. JACOBS U.A.H.C. CAMP INSTITUTE  
UTICA, MISSISSIPPI  
STATEMENT OF CHANGES IN FINANCIAL POSITION  
FOR THE YEAR ENDED OCTOBER 31, 1988

	<u>Operations Fund</u>	<u>Sustaining Fund</u>	<u>Plant Fund</u>	<u>Scholarship Fund</u>	<u>Total All Funds</u>
<u>RESOURCES PROVIDED:</u>					
Excess (Deficiency) of Support and Revenue Over Expenses Before Capital Additions and Transfers	\$(21,570)	\$ 44,988	\$ (79,537)	\$ 7,794	\$(48,325)
Capital Additions and Transfers:					
Transfer from Sustaining Fund	7,500	(8,997)	1,497		0
Plant Replacement and Other Capital Items Funded by Operations	(16,433)		16,433		0
Scholarship Funds Provided	3,886			(3,886)	0
Expense Items not Using Resources - Depreciation			117,674		117,674
Bank Loans	30,618				30,618
Inter-Fund Loans	(7,696)	9,050	(1,479)	125	0
Decrease in Receivables	13,023				13,023
Decrease in Inventories	162				162
Decrease in Investments	4,837	5,844			10,681
Increase in Accrued Expense	3,378				3,378
Increase in Deferred Camp Fees	723				723
Total Resources Provided	<u>18,428</u>	<u>50,885</u>	<u>54,588</u>	<u>4,033</u>	<u>127,934</u>
<u>RESOURCES USED:</u>					
Repayment of Notes Payable		42,500	31,000		73,500
Plant and Equipment Additions			16,732		16,732
Increase in Prepaid Expense	10				10
Increase in Investments			5,126	4,033	9,159
Decrease in Accounts Payable	18,046				18,046
Decrease in Accrued Expenses		133	261		394
Total Resources Used	<u>18,056</u>	<u>42,633</u>	<u>53,119</u>	<u>4,033</u>	<u>117,841</u>
Increase (Decrease) in Cash	<u>\$ 372</u>	<u>\$ 8,252</u>	<u>\$ 1,469</u>	<u>\$ 0</u>	<u>\$ 10,093</u>

See accompanying notes to financial statements.



HENRY S. JACOBS U.A.H.C. CAMP INSTITUTE  
UTICA, MISSISSIPPI  
NOTES TO FINANCIAL STATEMENTS  
OCTOBER 31, 1988

1. SUMMARY OF SIGNIFICANT ACCOUNTING POLICIES:

The financial statements of the Camp have been prepared on the accrual basis of accounting. In order to observe limitations placed on certain resources, the Camp accounts are maintained in accordance with principles of fund accounting. The financial statements do not include the activities of the Museum of the Southern Jewish Experience which was under construction in Utica, Mississippi throughout the year. This project, which is being funded primarily by a \$539,220 grant from the Plough Foundation, is administered separately from the Camp.

The funds maintained by the camp are an Operations Fund, a Sustaining Fund, a Plant Fund, and a Scholarship Fund. The Sustaining Fund is used principally to purchase capital additions as planned and budgeted by the Executive Committee. The Scholarship Fund is an endowment fund, the earnings of which are used to provide funds for campers demonstrating financial need. These funded scholarships are accounted for as transfers to the Operations Fund. The original principal contributions remain intact as restricted fund balances. Property, plant and equipment are accounted for in the Plant Fund. Use of operating funds or sustaining funds for plant acquisitions are accounted for as transfers to the Plant Fund. Depreciation of buildings and equipment is provided over the estimated useful life of the assets on a straight-line basis. Inventories are stated at cost on a first-in, first-out basis.

The operations fund is charged annually with a provision for replacement. The charge, in accordance with U.A.H.C. formula, is equal to 10 percent of campers' fees. Against this reserve account are charged items of a replacement nature. To the extent that the provision is not utilized in this manner or transferred to the plant fund, it is returned to the operations fund.

2. INVESTMENTS:

Investments are stated at cost, which is less than market value, as follows:

Money Market Accounts	
Operations Fund	
Sustaining Fund	\$ 1,459
Scholarship Fund	1,223
Plant Fund	47,407
Common Stock	5,126
Operations Fund (Market value \$16,868)	
Government of Israel Bond -	10,450
Operations Fund (Market Value not determined)	<u>500</u>
Total	<u>\$ 66,165</u>



HENRY S. JACOBS U.A.H.C. CAMP INSTITUTE  
UTICA, MISSISSIPPI  
NOTES TO FINANCIAL STATEMENTS  
OCTOBER 31, 1988

3. ACCOUNTS RECEIVABLE:

Accounts receivable at year end consist of the following:

Camper Fees	\$ 6,102
Camp Rental Fees	20,650
Expense Reimbursements	<u>832</u>
	\$ 27,584
Less Allowance for Bad Debts	<u>750</u>
	<u>\$ 26,834</u>

4. LAND, BUILDINGS AND EQUIPMENT - PLANT FUND:

A summary of plant assets is as follows:

Land	\$ 22,988
Buildings	1,539,466
Automotive Equipment	36,154
Other Equipment	<u>353,702</u>
	\$1,952,310
Less Accumulated Depreciation	<u>994,857</u>
Book Value	<u>\$ 957,453</u>

5. NOTES AND MORTGAGES:

The Plant Fund mortgage is the remaining construction loan obligation secured by building pledges and certain lands of the camp. The original line of credit is to be repaid from pledges over a five year period following completion of construction. Interest rates are to vary at one-half percent over the prime rate not to exceed 12-1/2 percent. At year end, the interest rate was 11 percent. Principal payments during the year were \$31,000 which exceeded that required by the loan agreement..

Balance payable	<u>\$40,000</u>
-----------------	-----------------

The Operations Fund note is an open note from a credit line established September 1, 1988 and due September 1, 1989, at 11.5%.

Balance payable	<u>\$43,311</u>
-----------------	-----------------

The Sustaining Fund note is an open note dated August 28, 1987 and due February 10, 1989 at 11.5%.

Balance payable	<u>\$83,500</u>
-----------------	-----------------



HENRY S. JACOBS U.A.H.C. CAMP INSTITUTE  
UTICA, MISSISSIPPI  
NOTES TO FINANCIAL STATEMENTS  
OCTOBER 31, 1988

5. NOTES AND MORTGAGES: (Continued)

The Operations Fund makes monthly payments totaling \$215.43 on an installment loan secured by a truck.

Principal amounts to be paid are as follows:

<u>Years Ended</u>	
October 31, 1989	\$ 1,944
October 31, 1990	2,148
October 31, 1991	2,371
October 31, 1992	<u>844</u>
	<u>\$ 7,307</u>





Wilson & Schloemer

Certified Public Accountants  
P. O. Box 4920 2 Jackson, MS 39216 3 (601) 366-1636

December 20, 1988

To the Directors  
Henry S. Jacobs U.A.H.C. Camp Institute  
Utica, Mississippi

INDEPENDENT ACCOUNTANTS' REPORT ON SUPPLEMENTAL DATA

Our report on our audit of the basic financial statements of Henry S. Jacobs U.A.H.C. Camp Institute for the year ended October 31, 1988 appears on page 1. That audit was made for the purpose of forming an opinion on the basic financial statements taken as a whole. The following analysis of selected financial statement amounts is presented for purposes of additional analysis and is not a required part of the basic financial statements. Such information has been subjected to the auditing procedures applied in the audit of the basic financial statements and, in our opinion, is fairly stated in all material respects in relation to the basic financial statements taken as a whole.

*Wilson & Schloemer*

Certified Public Accountants



HENRY S. JACOBS U.A.H.C. CAMP INSTITUTE  
UTICA, MISSISSIPPI  
OPERATIONS FUND  
ANALYSIS OF SELECTED BALANCE SHEET AMOUNTS

	<u>October 31.</u>		
	<u>1988</u>	<u>1987</u>	<u>1986</u>
<u>CASH:</u>			
Trustmark/American Bank	\$ 912	\$ 540	\$ 1,643
Merchants/Bank of Utica	2,481	2,481	2,606
Petty Cash	<u>300</u>	<u>300</u>	<u>250</u>
Total	<u>\$ 3,693</u>	<u>\$ 3,321</u>	<u>\$ 4,499</u>
<u>INVESTMENTS:</u>			
Merrill Lynch Ready Asset	\$ 1,459	\$ 6,296	\$ 147
Xerox Common Stock - 10 Shares	475	475	475
J. C. Penney Common Stock - 300 Shares	9,975	9,975	9,975
Government of Israel 4% Bond	<u>500</u>	<u>500</u>	<u>500</u>
Total	<u>\$ 12,409</u>	<u>\$ 17,246</u>	<u>\$ 11,097</u>
<u>ACCOUNTS RECEIVABLE:</u>			
Camp Fees	\$ 6,102	\$ 21,311	\$ 6,294
Camp Rental	20,650	15,128	0
Other	832	4,168	4,777
Museum Expenditures Reimbursable	0	0	10,987
Allowance for Bad Debts	<u>(750)</u>	<u>(750)</u>	<u>(750)</u>
Total	<u>\$ 26,834</u>	<u>\$ 39,857</u>	<u>\$ 21,308</u>
<u>INVENTORIES:</u>			
Food	\$ 1,491	\$ 1,082	\$ 1,451
Office Supplies	5,593	2,599	2,172
Cleaning Supplies	377	353	383
Paper Goods	474	511	508
Canteen	34	155	776
Religious Supplies	12,360	15,791	10,499
Maintenance Supplies	<u>0</u>	<u>0</u>	<u>95</u>
Total	<u>\$ 20,329</u>	<u>\$ 20,491</u>	<u>\$ 15,884</u>
<u>PREPAID EXPENSES:</u>			
Insurance	<u>\$ 19,905</u>	<u>\$ 19,895</u>	<u>\$ 7,345</u>



HENRY S. JACOBS U.A.H.C. CAMP INSTITUTE  
 UTICA, MISSISSIPPI  
 OPERATIONS FUND  
 ANALYSIS OF SELECTED OPERATING STATEMENT AMOUNTS

	For Year Ended October 31.		
	<u>1988</u>	<u>1987</u>	<u>1986</u>
<u>REVENUE:</u>			
<u>Camp Fees</u>	\$ 33,956	\$ 29,900	\$ 34,599
Kibbutz	157,800	161,742	143,894
Camp Session I	172,625	180,450	176,336
Camp Session II	745	10,711	16,258
SoFTY Camp	4,200	1,500	4,425
CIT			
Total Camp Fees	<u>\$369,326</u>	<u>\$384,303</u>	<u>\$375,512</u>
<u>Canteen Revenue</u>	<u>\$ 23,460</u>	<u>\$ 26,595</u>	<u>\$ 26,821</u>
<u>Investment Income</u>	<u>\$ 2,015</u>	<u>\$ 1,590</u>	<u>\$ 3,608</u>
Interest and Dividends			
<u>Contributions</u>			
Donations	\$ 3,425	\$ 3,018	\$ 14,228
Designated for Scholarships	11,982	21,174	5,850
Total Contributions	<u>\$ 15,407</u>	<u>\$ 24,192</u>	<u>\$ 20,078</u>
<u>Other Revenue</u>			
Camp Rentals	\$ 86,210	\$ 58,614	\$ 47,019
Youth Budget (SoFTY)	6,767	8,000	5,224
Tochnit Sales	148	720	683
Camper Transportation Reimbursed	3,735	5,090	4,822
Miscellaneous	240	364	792
Total Other Revenue	<u>\$ 97,100</u>	<u>\$ 72,788</u>	<u>\$ 58,540</u>
<u>Budgeted Transfers from Other Funds</u>			
Sustaining Fund	\$ 7,500	\$ 7,500	\$ 13,500
Scholarship Fund	3,836	2,290	4,473
Total Budgeted Transfers	<u>\$ 11,386</u>	<u>\$ 9,790</u>	<u>\$ 17,973</u>



HENRY S. JACOBS U.A.H.C. CAMP INSTITUTE  
UTICA, MISSISSIPPI  
OPERATIONS FUND  
ANALYSIS OF SELECTED OPERATING STATEMENT AMOUNTS

	For Year Ended October 31,		
	<u>1988</u>	<u>1987</u>	<u>1986</u>
<u>EXPENSES:</u>			
<u>Administrative</u>			
Salaries	\$ 99,834	\$ 90,045	\$ 83,775
Payroll Taxes	13,362	12,109	11,462
Employee Benefits	4,387	4,173	4,040
Temporary Labor	0	0	164
Honorariums	0	1,000	500
Seminar	4,772	2,792	2,306
Telephone	14,773	15,584	11,887
Postage	5,326	3,675	3,352
Travel Allowance	10,266	11,335	5,632
Office Supplies	5,208	5,633	3,118
Advertising and Printing	5,529	6,349	2,919
Accounting and Legal	5,330	5,547	6,234
Medical Supplies	1,268	1,334	1,670
Office Rent	5,200	5,050	5,004
Equipment Rental	2,844	2,588	4,347
Interest	2,563	264	0
Computer Training	491	971	1,316
Dues and Subscriptions	179	35	79
Uncollectible Accounts	474	0	3,539
Miscellaneous	938	1,004	849
Total Administrative Expenses	<u>\$182,744</u>	<u>\$169,488</u>	<u>\$152,193</u>
<u>Commissary</u>			
Salaries	\$ 23,204	\$ 22,407	\$ 21,628
Food - Groceries	41,268	33,383	29,925
Food - Meats	3,239	4,888	8,519
Food - Dairy	1,862	3,520	4,621
Cleaning Supplies	0	0	3,646
Paper Goods	4,132	3,987	3,054
Miscellaneous	144	494	322
Total Commissary Expenses	<u>\$ 73,849</u>	<u>\$ 68,679</u>	<u>\$ 71,715</u>
<u>Educational and Recreational</u>			
Salaries	\$ 36,300	\$ 39,491	\$ 42,566
Travel Allowance	8,617	6,121	7,851
Staff Training	372	0	804
Supplies	7,383	8,242	7,622
Maintenance	40	69	0
Camper Transportation	4,099	3,695	4,853



HENRY S. JACOBS U.A.H.C. CAMP INSTITUTE  
 UTICA, MISSISSIPPI  
 OPERATIONS FUND  
 ANALYSIS OF SELECTED OPERATING STATEMENT AMOUNTS

	For Year Ended October 31.		
	1988	1987	1986
<u>EXPENSES:</u> (Continued)			
<u>Educational and Recreational</u> (Continued)			
Tochnit Expense	\$ 3,431	\$ 3,722	\$ 3,399
Israel Trip - Net	0	666	0
Equipment Rental	246	246	0
Miscellaneous	<u>733</u>	<u>142</u>	<u>0</u>
Total Educational and Recreational	<u>\$ 61,221</u>	<u>\$ 62,394</u>	<u>\$ 67,095</u>
<u>Plant Operations</u>			
Salaries	\$ 27,191	\$ 26,863	\$ 24,729
Contract Labor	676	0	0
Utilities - Gas	2,237	2,472	0
Utilities - Other	35,471	26,319	37,592
Maintenance and Supplies	7,073	4,992	8,168
Repairs	10,187	10,871	11,291
Grounds and Roads	2,917	2,232	2,766
Auto Gas and Oil	3,419	3,354	3,354
Auto Rental	1,958	1,950	0
Auto Repairs	1,721	2,142	3,366
Miscellaneous	<u>194</u>	<u>271</u>	<u>277</u>
Total Plant Operations Expenses	<u>\$ 93,044</u>	<u>\$ 81,466</u>	<u>\$ 91,543</u>
<u>Housekeeping</u>			
Laundry	\$ 2,683	\$ 3,225	\$ 3,956
Other	<u>543</u>	<u>285</u>	<u>0</u>
Total Housekeeping	<u>\$ 3,226</u>	<u>\$ 3,510</u>	<u>\$ 3,956</u>
<u>Other</u>			
Insurance	\$ 64,898	\$ 64,327	\$ 61,545
Canteen Merchandise	13,156	14,836	14,403
National Participation	5,430	3,930	3,638
SoFTY	12,517	6,898	7,913
Loss on Sale of Stock	0	0	1,458
Scholarships Awarded	<u>18,793</u>	<u>21,645</u>	<u>0</u>
Total Other Expenses	<u>\$114,794</u>	<u>\$111,636</u>	<u>\$ 88,957</u>



From the desk of:



RABBI DANIEL B. SYML

*I thought the attached  
might be of interest to you.*







RABBI ALEXANDER M. SCHINDLER • UNION OF AMERICAN HEBREW CONGREGATIONS  
PRESIDENT 838 FIFTH AVENUE NEW YORK, N.Y. 10021 (212) 249-0100

March 16, 1989  
9 Adar II 5749

Mr. Macy B. Hart  
Henry S. Jacobs Camp-UAHC  
Box 16528  
Jackson, MS 39236-0528

Dear Macy:

Forgive the brief note, I am off to Israel, but I do want to respond to your letter of March 6th.

The projected budget that I personally discussed with Jocelyn, was for \$540,000.00 - it was never for less. This is the figure which I worked with and this is the figure on which the 15% should be based.

I would appreciate it, therefore, if you were to transfer the sums which you owe us and which were built into your budget.

Thank you so very much. If you have any questions, please discuss them with Danny. I'll be wandering all over the face of this earth for the next month or two, but I want this matter settled certainly within this fiscal year.

Sincerely,

Alexander M. Schindler

cc: Rabbi Daniel B. Syme





March 6, 1989

Rabbi Alexander Schindler  
Rabbi Daniel Syme  
838 Fifth Avenue  
New York, NY 10021

Dear Alex and Dan:

I received your letter today and want to respond as you have requested. The U.A.H.C. share was not figured on 15% of the total project cost of \$539,220. There was no way for me to have known the cost in the outset.

As there was no administrative cost line on the budget, and as you advised me in St. Louis to pad the budget, I did. Our end project was actually around \$469,000, and that was the figure used to get the 15%. That percentage was then divided throughout the seven budget lines that were submitted to the Plough Foundation. The U.A.H.C. share is \$70,000. If you add that amount to the above 469,000 you will get the total of the grant.

The building is now finished, and we are performing the remainder of the commitments to the Plough Foundation. I believe they are very happy with the project, and we have kept them completely informed. I will send the U.A.H.C. share in installments as we get these funds. We have only been able to draw actual amounts submitted with the construction draw request.

I am anxious for both of you to see this beautiful structure. Leah's Bat Mitzvah on March 18 will be the first life cycle event to take place in the sanctuary.

Personal regards,

Macy B. Hart  
Director

MBH:jb



From the desk of:



RABBI DANIEL B. SYME

*I thought the attached  
might be of interest to you.*







RABBI ALEXANDER M. SCHINDLER • UNION OF AMERICAN HEBREW CONGREGATIONS  
PRESIDENT 838 FIFTH AVENUE NEW YORK, N.Y. 10021 (212) 249-0100

February 27, 1989  
22 Adar I 5749

Mr. Macy B. Hart  
Director  
UAHC Jacob Camp Institute  
Box 16528  
Jackson, MS 39236-0528

Dear Macy:

On my return from Israel, I met with Dan Syme regarding your letter about the Plough grant.

Unless I have totally lost my memory, I cannot recall ever having discussed the 15% amount or the schedule of payments with Jocelyn at any time. About a year or so, she contacted me concerning the slow pace of the building process and asked me to hurry you up and that I did, but nothing at all was discussed beyond this.

From the very beginning, we agreed that this 15% administrative fee was to be built into the cost of the project itself. This is a reasonable request, far below the administrative charges which are paid by other foundations to institutions for central administration. That sum approaches, if it does not exceed, 25%.

Be that as it may, you owe us \$81,000.00 rather than the lower sum that you indicate and I would appreciate it if you were to send it to us by June 30th. We need it desperately to make our budget this year. And, our abilities to make our budget this year will in turn determine the leeway with which we have the coming year.

Please send me written confirmation of your understanding of this deadline. We're involved in the budget processes even now and we must have your answer -- by return mail if at all possible.

With every good wish, I am

Sincerely,

Alexander M. Schindler

cc: Rabbi Daniel B. Syme



Jocelyn said they believe  
they have things under  
control as of 4 days  
ago, and urged that  
we not play Macy.  
I smoothed things  
over. He understands  
and accepts the 15%  
to support the national  
movement. But  
please keep an eye  
on this.

Thanks,  
D-

from the desk of:

BS

Rabbi Daniel B. Syme

fell  
down

Smitty -

Jocelyn Audrey  
spoke to me Sunday  
night. Macy told her  
that he couldn't  
spend all the money  
the Foundation  
gave him because  
15% goes to F.R.G.  
Nazi. Also, Macy has  
not filed the required  
reports, and the  
Foundation Board is  
less than pleased.



# MEMORANDUM

From Rabbi Alexander M. Schindler

Date February 23, 19  
18 Adar I 57

To Rabbi Daniel B. Syme

Copies Rabbi Allan Smith

Subject

Your recent memo concerning the Plough grant for the "Museum for the Southern Jewish Experience" puzzles me. I had no conversations with Jocelyn concerning the 15% administrative charge. She talked to me once about the seeming delay in getting construction going and I agreed to push in her behalf. As far as I am concerned that 15% was to be billed into the cost of the project and should come from Macy. Since he received \$540,000, he should remit the appropriate sum to us as soon as possible.

Thank you.



Union of American Hebrew Congregations  
838 FIFTH AVENUE, NEW YORK, N.Y. 10021 (212) 249-0100



# MEMORANDUM

From Rabbi Daniel B. Syme  
To Rabbi Alexander M. Schindler, Rabbi Allan Smith  
Copies  
Subject

Date Feb. 14, 1989

I enclose a copy of a letter received today from Macy Hart. This is the first that I have heard of this.

In the first instance, 15% of the \$540,000 grant is \$81,000 not \$64,000. Secondly, our budget this year depends heavily on the delivery of that entire amount by June 30th.

I would appreciate clarification at once so that we can determine what additional steps need to be taken.

Thanks.

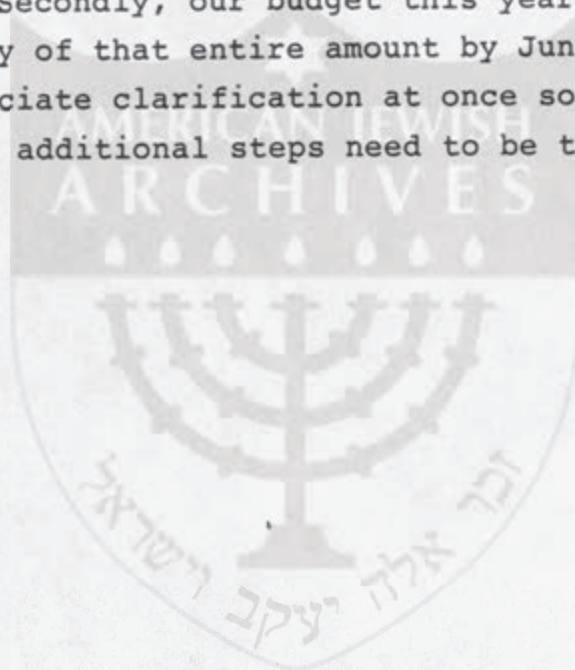





February 9, 1989

Rabbi Daniel Syme  
Union of American Hebrew Congregations  
838 Fifth Avenue  
New York, NY 10021

Dear Danny:

Thanks for your memo to me concerning the 15% on the Plough Foundation funds. I want to make sure we are all in concert with each other as to what that amount is going to be and how it is going to work. I am sure you are aware there was a conversation between Alex and Jocelyn Rudner with regard to the 15%, and that the Foundation made the decision to withhold the 15% until the Museum was completed. I do not have any extra monies to be sending at this time. We are nearing completion of the project, and probably the funds will free up, although I do not know the particulars of the conversation between Jocelyn and Alex.

The UAHC's share of this grant is \$64,000. That is the amount that was figured in the original budgeting process. I hope we will be able to deliver, not only a great portion, but possibly all of it, by the summer meeting time. In the meantime, I am counting on you for Phase 2, as you have indicated in past conversations.

The building is magnificent, as is the momentum that seems to be building. As you are aware, I am very much strapped timewise and have not been able to do a great deal of fundraising. I hope that you will come soon and see for yourself what has been accomplished, for I believe this project will generate a great deal of excitement throughout the country. I am sure you have seen the Baltimore Jewish Times article. It has brought us a wonderful amount of exposure.

Love and kisses at home.

Personal regards,

Macy B. Hart  
Director

MBH:jb

Dr. and Mrs. Julian Wiener  
Project Co-Chairmen

Vicki Reikes Fox  
Project Director

David B. Grishman  
Past Chairman Board of Directors  
Henry S. Jacobs Camp

Macy B. Hart  
Director  
Henry S. Jacobs Camp



*Jacobs Camp  
Synagogue*

Jackson, Mississippi 39201

May 31, 1988  
15 Sivan 5748

Dear Macy:

Mr. Macy B. Hart  
P.O. Box 16528  
Jackson, MS-39236

Mr. Macy B. Hart  
P.O. Box 16528  
Jackson, MS-39236

Dear Macy:

I am just signing a letter dated May 18, 1988, sent to you by the Plough Foundation, in which they express displeasure with the fact that there has been lack of progress in the movement toward the construction of the building at Camp Jacobs. This delay violates a promise I made in an earlier letter to the Plough Foundation, made on your assurance that the requirements would be met.

I am just signing a letter dated May 18, 1988, sent to you by the Plough Foundation, in which they express displeasure with the fact that there has been lack of progress in the movement toward the construction of the building at Camp Jacobs. This delay violates a promise I made in an earlier letter to the Plough Foundation, made on your assurance that the requirements would be met.

I am signing the new contract agreeing that the building be started no later than July 15, 1988. I am holding you personally responsible that this agreement will be met. I don't want to be embarrassed a second time, worse than that, I certainly don't want to lose a half a million dollars because of this needless delay.

I am signing the new contract agreeing that the building be started no later than July 15, 1988. I am holding you personally responsible that this agreement will be met. I don't want to be embarrassed a second time, worse than that, I certainly don't want to lose a half a million dollars because of this needless delay.

Greetings,

Alexander M. Schindler

*ce R*



*Signed to Plough*  
*Letter of signed contract to Macy.*  
*(Three enclosing letter to Macy)*

May 18, 1988

Mr. Macy B. Hart  
P.O. Box 16528  
Jackson, Mississippi 39236

Dear Macy:

Please accept this letter as confirmation of the following action taken by the Board of Trustees of Plough Foundation at its meeting on May 17, 1988:

RESOLVED, that the Plough Foundation agree to revise the 1986 grant of \$539,220 by removing the requirement that the building be completed by June 30, 1988 with a requirement that the building be started no later than July 15, 1988. As a condition of this change, the Plough Foundation will require a copy of the construction contract and specific validation of construction costs as building progresses. That validation will be on a monthly basis and consist of copies of draw requests properly approved by the architect or other responsible party. Progress payments will be made monthly by the foundation on the basis of requests signed by Macy Hart or his successor. The foundation staff is instructed to communicate the following statement:

At their meeting on May 17, 1988, the Trustees of the Plough Foundation expressed their displeasure over the lack of progress in the movement towards the construction of the museum at Jacobs Camp and your failure to provide regular quarterly reports in a timely fashion as we have requested. The Trustees have asked us to inform you that any failure in the future, including failure to begin construction by July 15, 1988, will result in the discontinuance of the foundation's support and a request for the return of funds remaining unspent.

If the terms and conditions above stated are acceptable, please sign and return the enclosed copy of this letter for our files.

Sincerely,

*Noris R. Haynes, Jr.*  
Noris R. Haynes, Jr.  
Executive Director

The foregoing terms and conditions are agreed to and accepted this  
31 day of *April*, 1988.

*Carroll Thompson*



# MEMORANDUM

From Rabbi Allan L. Smith

28 Iyar, 5747  
Date May 27, 1987

To Rabbi Daniel Syme

RE: BILL HESS AND MACY

On the day the Camp Directors' meeting ended, Macy had a presentation at Bill Hess' house relative to camp this summer. My understanding is the same as yours. The building is to be built in accordance with the Plough Foundation grant. I know that Macy is still talking about the broader plan. He has gotten encouragement from Eli Evans ( see letter enclosed). I am sure he is moving properly on the camp building.

ALS



Union of American Hebrew Congregations

838 FIFTH AVENUE, NEW YORK, N.Y. 10021 (212) 249-0100





# MEMORANDUM

From Rabbi Daniel B. Syme

Date 5/14/87

To Rabbi Allan Smith

Copies

Subject

Allen -

I got a call from Bill Hess today, indicating that Macy is trying to raise money from foundations in the South for the Camp museum. I thought we had a clear understanding that the primary structure was to be erected immediately according to the agreement with the Plough Foundation. Any other developments were to come after that. Would you please see what the story is on this? I promised Bill that I would not involve him deeply in internal politics. I want to see this project moved forward and above all, not jeopardize the grant. Thanks.

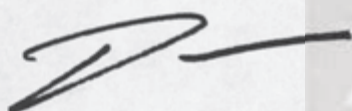

Union of American Hebrew Congregations

838 FIFTH AVENUE, NEW YORK, N.Y. 10021 (212) 249-0100

אחדות  
ליהדות  
אמריקה



---

# CHARLES H. REVSON FOUNDATION

---

444 MADISON AVENUE  
NEW YORK, N.Y. 10022-6962  
(212) 935-3340

SIMON H. RIFKIND  
Chairman

ELI N. EVANS  
President

HARRY MERESMAN  
Secretary and Treasurer

April 30, 1987

Macy Hart, Director  
Henry S. Jacobs Camp  
Utica, Mississippi 39175

Dear Macy:

Thank you for coming by and sharing with me the master plan for the Museum of the Southern Jewish Experience. As I told you, it is unfortunately a project that the Charles H. Revson Foundation cannot help because this kind of an entity is not on our agenda. However, it is an idea that personally resonates with me because of my own involvement in writing about Southern Jewish history and traveling 7,000 miles across the South in the 1970's interviewing all ages of Southern Jews for my book. I want to congratulate the Abraham Plough Foundation for having the imagination to make a generous grant to launch such a far-reaching idea.

I say "far-reaching" because we Jews born and raised in the South have just recently, in the last ten or fifteen years, become aware of the depth and dignity of our own history. Up until then, center stage was always the Northeast, where the great immigrant stories commanded such attention and applause that historians never bothered to look elsewhere. We languished on the periphery, like country cousins or "The Provincials" (if you will pardon the reference), not destined to triumph but to survive, overlooked, out there on the rim, in the Southern part of America where our history and our accomplishments did not count. Now, that impression has been somewhat corrected with a growing body of literature and new philanthropic attention. But the sense of inferiority still lingers among the young, who still harbor these impressions of inadequacy from earlier times.

The Museum of the Southern Jewish Experience could be the centerpiece of a new movement of Southern Jewish pride, and harness this new excitement and interest to make a real difference in the attitude of Southern Jews -- young and old -- about themselves. The museum could collect family diaries and letters; show families how to do oral and video histories; develop and display photographic projects and turn them into books and/or documentary films (like the recent book of photographs of Mississippi Jewish communities). It should stimulate the display and collection of family photograph albums; encourage putting family trees on a computer in the museum and then hook them into the genealogical project of the Museum of the Diaspora in Israel. It could encourage community histories, centennial celebrations, and collect community, state, and regional material and develop books, teaching materials and traveling exhibitions. It could



research and do exhibitions on notable families -- the Ploughs; the Thalhimers in Richmond; the Neiman and Marcus families in Texas; Judah Touro of New Orleans; the Massells of Atlanta; the Sulzbergers of Chattanooga. It could promote exhibitions on the lives of political figures (such as Judah P. Benjamin, Gustavus Myers who for thirty years served on the City Council in Richmond and the hundreds of office holders who have been elected to public office in the last fifty years). It could display photographic studies of the works of artists like the sculptor (Ezekiel) and writers (Phoebe Pember, Ludwig Lewison, etc.) and poets and painters. It could be a place that not only collects but celebrates the Southern Jewish experience. It could be not only a building at the camp that people visit but the "earth station" that radiates materials outward to an audience of thousands across the South, the nation and the world.

However, the most difficult step is the next one. With almost twenty years of philanthropic experience, I can tell you that the problem I think you will have in raising other funds is that the project is not laid out precisely enough to give other funders any confidence in it. You need a more detailed plan, some originality, and the thinking and advice of the best people in America and abroad, consulting with scholars in the field, to help plan such a project. It won't be done again on this scale and it should be done right. It should be a detailed plan -- physically and substantively -- that will give potential contributors the opportunity to participate and name exhibitions, rooms, activities, and programs in their own states and cities. There should be a way for thousands of families to contribute photographs to a videodisc project, include a contribution when they send the photographs, and then be able to summon those photographs from the video disc when they visit the museum with their families (the Statue of Liberty did this very successfully).

I hope the Plough Foundation will release some funds to enable you to take that next step in developing a more detailed plan. Some funds released now would enable you to engage top people to advise you and come up with an exciting and imaginative project, beautifully described and illustrated, that could be circulated widely to several thousand potential contributors. People would want to contribute because they would sense that the idea could matter -- to themselves, their families, their communities, states and region.

My feeling is that there is a considerable amount of money in the South for the right idea if it is developed with flair, imagination, a sense of participation and a carefully conceived and feasible plan. But make no mistake about it: the idea and its conception is central because few people will contribute major monies to a static, old-style museum which will only act as a repository for Southern Judaica or an attic that collects objects from vanishing congregations which will be seen just by campers and visitors to Utica. It must be a "big idea" -- a 21st century museum anchored in new technologies and committed to a regional and national educational and cultural mission.



Without this next step of creativity and detail, the idea will just remain a dream and the Ploughs could well be disappointed that others did not come forward, when indeed, the project and you need some funds to take the idea to the next level of specificity and presentation. I know you have been talking to Joceyln Rudner about next steps and I would be happy to talk with her as well, if she wishes to do so.

Thank you again for coming by and please know that you can count on my personal support in seeing the idea through to its completion.

With best wishes,

AMERICAN JEWISH  
ARCHIVES

*Eli Evans*

EE:rc







איחוד  
ליהדות  
מתקדמת  
באמריקה

# Union of American Hebrew Congregations

PATRON OF HEBREW UNION COLLEGE - JEWISH INSTITUTE OF RELIGION  
838 FIFTH AVENUE, NEW YORK, N.Y. 10021 (212) 249-0100 CABLES: UNIONUAHC

YOUTH DIVISION  
DEPARTMENT OF CAMP AND  
YOUTH PROGRAMMING

22 Nissan, 5747  
April 21, 1987

Mr. David Grishman  
Box 427  
Jackson, MS 39205

Dear David,

It was good speaking with you today.

In relation to the Jacobs Camp and its corporate status, I would like to review our conclusions.

The UAHC does not object to any UAHC camp establishing its own corporate entity for a clarification of its tax exempt status. In fact, it would make matters much easier, particularly in the area of fund raising. However, it should be absolutely clear that whatever corporate status is established, the UAHC must be the sole owner and in unequivocal control of that entity. Further, all business activities are subject to the review of the National office, its National Committee and staff. The corporate entity is not free to violate any of the rules of the National office. With all this in mind, we encourage you to proceed to establish the appropriate 501 (C 3) corporation.

Look forward to seeing you in May.

Best wishes,

Rabbi Allan L. Smith, Director  
UAHC Youth Division

ALS

CC: Macy B. Hart



To David Grishman:

Dear David:

It was good speaking with you today.

In relation to the Jacobs Camp and its corporate status, I would like to review our conclusions.

The Uahc does not object to any UAHC Camp establishing its own Corporate Entity for a clarification of its Tax Exempt Status. In fact it would make matters much easier, particularly in the area of Fund Raising. However, it should be absolutely clear that whatever Corporate Status is established, the Uahc must be the sole owner and in unequivocal control of that entity. Further, all business activities are subject to the review of the National Office, its national committee and staff. The corporate entity is not free to violate any of the rules of the national office. With all this in mind we encourage you to proceed to establish the appropriate 501 (C 3) corporation.

Look forward to seeing you in May.







איחוד  
ליהדות  
מתקדמת  
באמריקה

# Union of American Hebrew Congregations

PATRON OF HEBREW UNION COLLEGE - JEWISH INSTITUTE OF RELIGION  
838 FIFTH AVENUE, NEW YORK, N.Y. 10021 (212) 249-0100 CABLES: UNIONUAHC

YOUTH DIVISION  
DEPARTMENT OF CAMP AND  
YOUTH PROGRAMMING

16 Nisan, 5747  
April 15, 1987

Mr. David Grishman  
Box 427  
Jackson, MS 39205

Dear David,

I have just concluded my round of our camp regions and hope that our general recruitment situation improves over the next few weeks. Now it is time to return to the other issues of my travels and most specifically the Museum/Synagogue project.

I spoke with B.J. Tanenbaum, Jr. today in order to add perspective to the issue. I have not spoken with either Rabbi Schindler or Syme since my return, but feel quite confident that they will concur with the conclusions stated below. As you will note, I have copied all of us in this letter so that everyone will be up to date.

The positive conclusions are that the funds from the Foundation are available to build a meaningful structure on the grounds of the camp. This structure would serve as an adequate repository for artifacts of many Southern Jewish Communities in a synagogue environment.

The negative conclusions, for the time being, are that the Union is in no position to front any programmatic activities of this museum project. This, however, does not in any way suggest that at some time in the near future, once having the facility in place and seeing very specific interest from the community, that what is now the totality of the project might become just the first stage in a process.

In terms of the staff necessary to handle this initial stage, your camp committee should be the decision making body. By implication, all budgetary commitments must come from the current grant. All Camp Committees, within the Union structure, have always had the latitude to set budgetary priorities for those programs which were considered by the committee to be in the general interest of the camp community. All that the National Committee seeks is the responsible process which has always been a part of the Jacobs tradition.

It is, therefore, my suggestion that the Camp Committee and Macy proceed in an appropriate time frame to draw the necessary plans to bring this first phase to reality, namely the construction of a proper facility.

Cont...



Mr. David Grishman

-2-

April 15, 1987

It is my understanding and promise to you that all judgements relative to the future aspects of this project will remain open for near term consideration as the results of this first stage are evaluated.

Please let me know if there is any way in which I can be of assistance in satisfying whatever outstanding issues that might remain. Best wishes for a Happy Passover Season.

Yours in friendship,

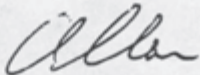

Rabbi Allan L. Smith  
Director, UAHC Youth Division

ALS

CC: Macy B. Hart, B.J. Tanenbaum, Jr., Rabbis Alexander Schindler and Daniel Syme





Letter to David Grishman

Copies Macy Hart, B.J. Tanenbaum Rabbi Schindler and Syme

Dear David:

I have just concluded my round of our camp regions and hope that our general recruitment situation improves over the next few weeks. Now it is time to return to the other issues of my travels and most specifically the Museum/Synagogue project.

I spoke with B.J. Tanenbaum today in order to add perspective to the issue. I have not spoken with either Rabbis Schindler or Syme since my return, but feel quite confident that they will concur with the conclusions stated below. As you will note I have copied all of us in this letter so that everyone will be up to date.

The positive conclusions are that the funds from the Foundation are available to build a meaningful structure on the grounds of the camp. This structure would serve as an adequate repository for artifacts of many Southern Jewish Communities in a synagogue environment.

The negative conclusions, for the time being, are that the Union is in no position to front any programmatic activities of this museum project. This, however, does not in any way suggest that at some time in the near future, once having the facility in place and seeing very specific interest from the community, that what is now the totality of the project might become just the first stage in a process.

In terms of the staff necessary to handle this initial stage, your camp committee should be the decision making body. By implication, all budgetary commitments must come from the current grant. All Camp Committees, within the Union structure, have always had the latitude to set budgetary priorities for those programs which were considered by the committee to be in the general interest of the Camp Community. All that the National Committee seeks is the responsible process which has always been a part of the Jacobs tradition.

It is therefore my suggestion that the Camp Committee and Macy proceed in an appropriate time frame to draw the necessary plans to bring this first ~~phase~~ <sup>phase</sup>, namely the construction of a proper facility, to reality.

It is my understanding and promise to you that all judgements relative to future aspects of this project will remain open for near term consideration as the results of this first stage are evaluated.

Please let me know if there is any way in which I can be of assistance in satisfying whatever outstanding issues might remain. Best wishes for a Happy Passover Season.

Yours in friendship,



Give us the strength to be gentle  
the wisdom to be confused  
the right to be wrong on occasion  
the sense to know when to lose.  
Give us the time to be patient  
the courage to be afraid.  
Give us the eyes of children again  
to see the world — a different world —  
a world that can still be made.

from **The Tap Dance Kid**  
"William's Song"  
Lyrics by Robert Lorick

## Henry S. Jacobs Camp

**Macy B. Hart**  
Camp Director

**David B. Grishman**  
Chairman, Board of Directors

*Summer*  
Utica, Mississippi 39175  
(601) 885-6042

*Winter*  
P. O. Box 16528  
Jackson, Mississippi 39236-0528  
(601) 362-6547



*4 Feb  
with letter*

April 7, 1987

Rabbi Allen Smith  
Union of American Hebrew Congregations  
838 Fifth Avenue  
New York, New York 10021

Dear Smitty:

I am glad I had an opportunity to meet with you during your visit a few weeks ago to Jackson. I regret, however, that we were not able to reach a satisfactory mutual understanding concerning the building of the Museum/Synagogue. I had thought that you were going to get a follow up letter to us within a couple of weeks after you left Jackson, but I have not heard from you. I wish you would give that some priority so we can get this matter concluded.

As you know, Macy has asked for a sabbatical after the end of Camp this summer. We are having a Camp Board Meeting on May 1, 1987, and I would like to be able to report the status of that request. Hopefully, you have either granted or denied the request by that date. In any event, it cannot remain in limbo for as long as the Museum/Synagogue matter has been going on. We have got to know an answer one way or the other real soon.

I hope all is well with you. We are busy making plans for Camp and to no one's surprise, summertime is almost here.

Best wishes.

Sincerely,

*David B. Grishman*  
David B. Grishman

DBG:sj



From the desk of:



RABBI DANIEL B. SYME

*I thought the attached  
might be of interest to you.*

*Museum*







איחוד  
ליהדות  
מתקדמת  
באמריקה

# Union of American Hebrew Congregations

PATRON OF HEBREW UNION COLLEGE JEWISH INSTITUTE OF RELIGION

DORAL EXECUTIVE OFFICE PARK

3785 NORTHWEST 82 AVENUE, SUITE 210, MIAMI, FLORIDA 33166, (305) 592-4792

SOUTHEAST COUNCIL

Rabbi Frank N. Sundheim

Regional Director

March 4, 1987

FROM : Frank Sundheim  
TO : Rabbi Daniel Syme  
RE : Demopolis, Alabama

I spoke with Melvin Levy from Demopolis, Alabama on March 3rd. I must tell you that the conversation left me with goosebumps. He seems like a lovely old man who long before anyone of else thought of it wanted to make sure that the memory of Congregation B'nai Jeshurun will be indelibly imprinted in the community.

Specifics concerning his answers to our questions are as follows:

- 1) They have a building
- 2) They are planning to sell that building
- 3) They have a cemetery
- 4) They will use the funds from the sale of the building plus trust funds that have already been placed in the bank for the perpetual care of the congregation's cemetery. If the trust fund at any time should have too much money in it, the excess will be sent to a Jewish Hospital in the mid-west (I didn't get the exact name of the hospital).
- 5) They will have the Torah Scrolls inspected and if it is o. k., it will be given to the Hillel House at George Washington University in Washington, D. C.

All of their other religious paraphernalia are being given to Temple Beth Or in Montgomery. The man in charge of this project within Temple Beth Or is Jack Koch. They will either use the religious objects or store them (I will be in Montgomery several times during the year, and I will check to see the progress of this project.)

## OFFICERS

Southeast Council - President  
Samuel Steen

S. Fl. Federation - President  
Fred Frank

Secretary  
Harry Boreth

Vice Presidents  
Harold Jacobs  
Abie Kaplan  
Jean Kent  
Harvey Schlesinger  
Hal Schwartz

National Board Members  
Robert T. Benjamin, Jr.  
Jack Coleman  
Bob Dreyfus  
Jan Epstein  
Iris Franco  
Paul Frank  
Melvin T. Goldberger  
Robert Lipshutz  
Gary Metzel  
Al Riesenburger  
Morris Robinson  
Samuel Steen

UAHC President  
Rabbi Alexander M. Schindler

UAHC Chairman of the Board  
Charles J. Rothschild, Jr.



I mentioned to Mr. Levy that if a Torah is unworthy of being used, it is a Jewish custom to bury it. He responded that in the cemetery, they were going to put two Stars of David from the front of the temple onto a family memorial that he has in the center of the cemetery. The Mogan Davids would be engraved as a perpetual memorial to the congregation. He said that if the Torah is not worthy of usage that he would see to it that the Torah would also be buried within the family plot.

I think you will agree that some very beautiful and sensitive things are being done by Mr. Levy. As he described his family's history in the community and the sadness of the demise of the congregation, I realized why he wanted to make sure that the community would be properly memorialized. This project turned into a labor of love.

cmc





# The Museum of Jewish Heritage

## A Living Memorial to the Holocaust

Under the Auspices of the  
New York Holocaust  
Memorial Commission

*Founding Chairmen*  
Mario M. Cuomo  
Edward I. Koch

*Honorary Chairmen*  
Jacob K. Javits (1904-1986)  
Elie Wiesel

*Chairmen*  
George Klein  
Robert M. Morgenthau  
Manfred Ohrenstein

*Museum Project Director*  
David Altshuler

*Museum Consultant  
to the Commission*  
Jeshajahu Weinberg

February 26, 1987

HENRY S. JACOBS CAMP

Mr. Macy B. Hart  
Henry S. Jacobs Camp  
P.O. Box 16528  
Jackson, Mississippi 39236-0528

Dear Macy:

I have just finished reading the project proposal for the Museum of the Southern Jewish Experience, and I am most impressed with the fine work that you and your colleagues are doing. This institution and the programs it will generate will fill an important gap in the preservation of the Jewish past and the enrichment of our present and future.

I don't need to tell you that I have been an admirer of the Jacobs Camp ever since its inception, but this new project clearly puts you in a new league of professional excellence and Jewish commitment. Although I have been pretty much a fan on the sidelines in the past, I want you to know that you can count on me for whatever support and assistance you might wish from me to further this ambitious and highly significant project.

Since our own museum is at an early stage of development, I am aware perhaps more than others of the precarious mix of excitement and challenge that you must be experiencing now. Clearly, the proposal is a strong "skeleton", to which much "flesh" must be added. So too, the extremely generous founding grant you have received from the



# The Museum of Jewish Heritage

Mr. Macy B. Hart  
February 26, 1987  
Page Two

Plough Foundation is both a tribute to your vision and a goad to reach out for more support, an expanded professional staff, and ever-widening programmatic objectives. As your years of planning and building proceed, do not hesitate to ask for my help, and be assured that I will try to enlist my colleagues to aid you in whatever way you see fit.

Congratulations on a wonderful new beginning and best wishes for continued success.

Sincerely,

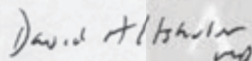

David Altshuler  
Museum Project Director

DA:mb





## CITY/CONGREGATION

## FAMILY MEMBERSHIP

1969

1987

TENNESSEE:

Brownsville - Adas Israel

10

7

Jackson - B'Nai Israel

75

51

Memphis - Temple Israel

1360

1525

Union City

10

0

