



## Daniel Jeremy Silver Collection Digitization Project

Featuring collections from the Western Reserve Historical Society and  
The Jacob Rader Marcus Center of the American Jewish Archives

### **MS-4850: Daniel Jeremy Silver Papers, 1972-1993.**

Series II: Subject Files, 1956-1993, undated.

---

Reel  
15

Box  
6

Folder  
188b

Cleveland Museum of Art, minutes, 1973-1976.

#### EXTENSION EXHIBITIONS DEPARTMENT

The Director said that Miss Doris Dunlavy, administrator of this department, has submitted her resignation as of January 1, 1975 for reasons of health. He said that this provides the opportunity for the Trustees to consider the future of this entire program. He stated he would propose the following:

- (1) That this department be again placed under the jurisdiction of the Department of Art History & Education as it was prior to 1958.
- (2) That Miss Dunlavy not be replaced and that the operation be supervised by Miss Janet Mack.

He said that there were various matters which should be considered carefully before decisions are reached. For example, this department might become a resource center from which the schools, libraries, etc. could borrow materials for their own exhibitions. This would of course eliminate the need for a good part of the existing staff. Also, the Bequest of Harold T. Clark would have to be examined carefully to see if there might be problems in discontinuing the established operation of the department. The Director suggested that the future of this operation be reviewed by members of the staff who are not directly involved with it, in order to present a more objective view. When such a study has been made, it will then be presented as a recommendation to the Trustees. The President said that he would appoint a committee of three to work with members of the staff assigned to this.

#### OPENING OF THE NEW WEST WING GALLERIES

The Director said that work is proceeding rapidly in the renovation of these galleries and that we are planning a preview and reception for donors to the Gallery Renovation Fund on Monday, December 16.

#### PERSONNEL MANAGER

The Director stated that we have reached the point where we should have a Personnel Manager to relieve Mr. Grossman of this load. He said that since we also need someone to supervise the Membership operation, it might be possible to make a combination position of this with the person working the equivalent of three days or so at Personnel matters and two days on Membership. It was felt that we should proceed with this now and engage the appropriate person as soon as he or she is found.

Upon motion duly made and unanimously carried, it was

VOTED: to approve the employment of such a person as soon as the appropriate one is found.

REPORT ON FINE ARTS GARDEN

Mr. Grossman reported that an inspection of the condition of plantings, lights, etc. in the Fine Arts Garden has been made by Strong & Hill. A copy of the report is attached (Appendix A). It was suggested by Dr. Silver that we look into the possibility of securing Federal funds to assist with the maintenance of the garden.

LAWSUIT BY CHARLOTTE FRANK

The Director reported that Mrs. Charlotte Frank died in London on August 8 and that the English solicitors had failed to report this fact to the Cleveland lawyers until a few days ago. There was a pretrial hearing on September 17 and the judge had urged that an out-of-court settlement be made if at all possible. Otherwise, a trial would begin on October 10. He read portions of a letter from the Museum's counsel, Neil K. Evans, which indicated that there are three options for the Estate of Mrs. Frank:

- (1) It can appear and substitute itself as a party plaintiff and attempt to maintain the action; or
- (2) It can appear and dismiss the action with prejudice; or
- (3) It can fail to appear in which event the action will be dismissed, also with prejudice, after a period of ninety (90) days.

Mr. Evans feels that it is highly improbable that the action will be maintained by the Estate, but if it is, the Museum will have to decide whether to pay the nuisance value of the suit or to proceed with the defense.

DIRECTOR'S CAR

The President stated that it might be appropriate to purchase a new car now for the Director since the present one has been in use since March 1970. This was discussed briefly and Mr. Perry urged that a 1975 model be bought.

Upon motion duly made and unanimously carried, it was

VOTED: to approve the purchase of a new car for the Director.

AUTHORIZATION FOR PURCHASES IN JAPAN

The Director said that he is customarily given authorization to make purchases in Japan. He requested authorization to spend up to \$100,000 with an additional \$50,000 if absolutely necessary. Any works purchased would not be paid for until 1975.

Upon motion duly made and unanimously carried, it was

VOTED: to authorize the Director to spend up to \$150,000  
in Japan, such purchases to be paid for in 1975.

#### GIFT FROM NOAH BUTKIN

The Director reported the gift of \$10,000 from Noah Butkin for the purchase of conservation equipment, primarily an X-ray machine and a microscope. He said that this will make it possible for our own conservation staff to operate more effectively and will eliminate the need for sending many items to Oberlin for this kind of examination. For example, the new Grünewald painting could be examined at leisure.

Upon motion duly made and unanimously carried, it was

VOTED: to accept this gift, to spend it for the purposes  
outlined above, and to express to Mr. Butkin the  
appreciation of the Trustees.

#### VACANCIES ON THE BOARD OF TRUSTEES

Mr. Williams stated he hoped to have a meeting of the Nominating Committee just as soon as Mr. Wilbur, the Chairman, has returned from Australia on or about October 17. It was suggested that the Nominating Committee also consider additions to the Advisory Council. He said that the Annual Meeting would be held on Thursday, November 21, at 11:00 a.m. at the Union Club.

#### MUSEUM NEWS AND CALENDAR

The Director reported that plans for this new publication are well advanced and that the first issue will appear next January. It will be a bimonthly publication in a format 11" x 6-1/2" and will be profusely illustrated.

He said that it will be prepared by a committee of which Mr. Wrolstad is Chairman and Editor. Mrs. Silver is responsible for the preparation of material relating to all educational activities, television, and the traditional Calendar material. Miss Stamper is responsible for material on exhibitions, films, publicity, external affairs, the Junior Council and staff news. An outline of the contents is attached. (Appendix B).

#### PARKING ON WADE OVAL

Dr. Silver reported a near-accident recently as he was approaching the Museum at a time when cars were parked on both sides of the street around Wade Oval. It was suggested that the Museum and the other institutions affected by this

Executive Committee Meeting  
October 4, 1974

5.

try to get the city to pass an ordinance prohibiting parking on the Oval side of the street. It is already posted as such part-way. Mr. Barksdale stated that Captain Matyas has had meetings with the police of Precinct #5 and the University Circle police, and as a result cars are being ticketed during the daytime with some regularity. It was suggested that the Museum explore with the Cleveland Police Department the costs of having cars towed away.

The meeting was then adjourned.

Sherman E. Lee  
Secretary

kc



WILLIAM A. STRONG — THOMAS W. HILL  
 LANDSCAPE ARCHITECTURE • SITE AND TOWN PLANNING  
 4500 EUCLID AVENUE CLEVELAND 3, OHIO

COPY

September 9, 1974

Mr. R. Henry Norweb, Jr., Chairman  
 The Fine Arts Garden  
 c/o The Holden Arboretum  
 Mentor, Ohio 44060

Dear Mr. Norweb,

RE: Fine Arts Garden

The following are the result of an inspection of the grounds with Mr. Santamary.

1. Hyacinths.

The Hyacinths used for the planting in the Garden of Squares at the southwest corner of the original building were effective, Spring 1974. They were not vandalized. Mr. Santamary suspects the early flowering in cool to cold weather is before the vandals congregate, also there is a trifle more police protection in that the windows above afford an observation post. Hyacinths are proposed for 1975.

2. Lights.

There were installed 3 vandal-resistant lights of stove-pipe appearance with light-holes of assorted sizes. One was placed in the bulb garden area, a second near the walk way leading from the Wade Park Manor, and the third on the north side of the walk leading to the southwest corner of the Art Museum. This third light while in a small open area, is nevertheless more or less obscured from observation. This latter light has been subjected to pounding with clubs. The top cover has had to be repaired. The plastic cylinder inside has not been broken; it has been attacked, but has stood up.

The former mushroom-like standards have had the stoutly ribbed glass cylinders smashed. These are costly (about \$40.00 each) and apparently not replaceable. The luminaires (if that is the correct term) have been on order for about 18 months.

Consideration could be given to the gradual replacement of the mushroom light standards with the stove-pipe types, say 3 lights a year. For the first 2, 3, or 4, could be placed near the Holden White Terrace which seems to be dark.

Mr. R. Henry Norweb, Jr.  
The Fine Arts Garden  
c/o The Holden Arboretum  
Mentor, Ohio 44060

September 9, 1974

### 3. Tulips and Peonies, vandalized.

The tulips have always been subject to vandalism in varying degree. I believe last spring was the first time the peony buds were struck off. Last spring groups of a dozen or more tulip flowers were knocked off in a hit or miss fashion. The petunias planted, following tulips, are mindlessly thinned out in patches. They are not stolen for home use, just pulled out and left on the walks to dry up.

There is no practical solution here within the limits of available funds. Adequate policing is not possible. Guards are beyond the Garden's resources, and the sum of money established to compensate the city for its policing is inadequate. The city is non-cooperative. It does not maintain its park lands which is its function to do.

The University Circle police are helpful when present, but when absent, the vandals gather quickly and ply their trade. Unfortunately for the welfare of the Garden, the police cannot be there 24 hours per day.

### 4. Cherry Trees.

For many years, the Fine Arts Garden, when the Oriental Cherries were in bloom, was a gorgeous spectacle thronged by thousands of visitors. The overly used word, unique, was applicable. Many of these cherries were winter-killed. Replacement planting was made in the spring of 1964.

Vandals destroyed the young trees by breaking branches and in a few instances the main stem. Further replacement planting has been omitted because of vandals.

Consideration has been given to protective measures and devices. Metallic screens embracing the trunk such as used abroad while efficient for grazing animals would only offer a challenge to vandals to climb. Larger trees than the usual nursery-grown plant might be safe if the lowest branch is 9 to 10 feet above the lawn.

The Losely nursery has, 5 large *Prunus sargentii*, the smallest being 4½ - 5" @ 157.50, a 6" dia. @ 210.00, two 7/8" @ 262.50, and one 9" @ 315.00.

Mr. R. Henry Norweb, Jr.  
The Fine Arts Garden  
c/o The Holden Arboretum  
Mentor, Ohio 44060

September 9, 1974

It is suggested that the smallest ( $4\frac{1}{2}$  - 5" @ 157.50) be ordered and planted, and if purchased, branches less than 9' above lawn be removed. This to be a trial in order to learn if larger plants are left undamaged.

#### 5. Ground Cover Plants.

The shrubbery west of the Yew Panel is too much used by vagrants. A ground cover here may be useful because it is moist, a possible deterrent to sleeping in the thicket.

At the southern end, it is suggested that the Yellow Archangle (*Lamium galeobdolon variegatum* - not listed in Hortuss II) be used. *Lamiums* are the Dead Nettle of Europe. The Brooklyn Botanical Garden rescued, introduced or reintroduced the variegated form in 1964. It has been hardy under observation for 10 years. Plant 24" to 30" apart in shade, or semi-shade. Now available at \$25.00 per 100.

At the northern part plant the spotted-leafed Lungwort, *Pulmonaria*, probably, *angustifolia*, irregularly in shade 18" apart. A. Shammarello will divide 50 plants from his ornamental planting for the Fine Arts Garden at 60¢ each, or for \$30.00 for the 50.

#### 6. Peony.

In the bulb garden, it is suggested that 12 Peony, *Paeonia officinalis rubra*, be planted. These flower very early, bright crimson before tulips. This peony in 1972 cost delivered \$1.25 each from Peonyland, Utah, apparently the only grower. The dozen would probably cost between \$12.00 and \$16.00.

There has been sent to you order 444-7497, Van Zonneveld, hyacinths and tulips, Enclosed herewith order 444-7499, Grootendorst, tulips and small bulbs.

Very sincerely yours,

William A. Strong.

WAS:eeb

cc: Mr. Grossman  
Mr. Santamary

APPROPRIATE

September 23, 1974

Mr. William A. Strong  
4500 Euclid Avenue  
Cleveland, Ohio 44103

Dear Bill:

RE: FINE ARTS GARDEN

With reference to your letter of September 9th, the continued use of hyacinths in the Garden of Squares is approved. Lights should be replaced with the vandal-proof type on a scheduled basis as recommended with priority going to the most poorly lighted areas first. With regard to the vandalism of the tulips, if this continues in 1975 the planting of these bulbs should probably be discontinued. To have no tulips is no worse than to have beds with the heads pulled off. Likewise, the planting of small cherry trees that are constantly vandalized is pointless. We should try the 4½" to 5" Prunus sargentii and see if it withstands vandalism. The use of Yellow Archangle and Lungwort for ground cover is a good idea and we should proceed. The use of peonies is also a good idea and these twelve plants should be secured.

Yours sincerely,

R. Henry Norweb, Jr.  
Chairman  
FINE ARTS GARDEN COMMISSION

RHN/a

James D. Ireland  
President

R. Henry Norweb, Jr.  
Chairman

John S. Wilbur  
Vice President

Edward J. Bartlett II  
Secretary

David H. Swafford  
Secretary

Raymond G. Armstrong

W. C. Gable, Jr.

T. L. Gable

Kent H. Smith

# PLANTING KEY

- #1. EXISTING KATSURA TREE
- #2. ERANTHIS & CHIONODOXA
- #3. LAMIUM
- #4. PULMONARIA
- #5. MERTENSIA
- #6. PAEONIA OFFICINALIS RUBRA
- #7. PRUNUS SARGENTI

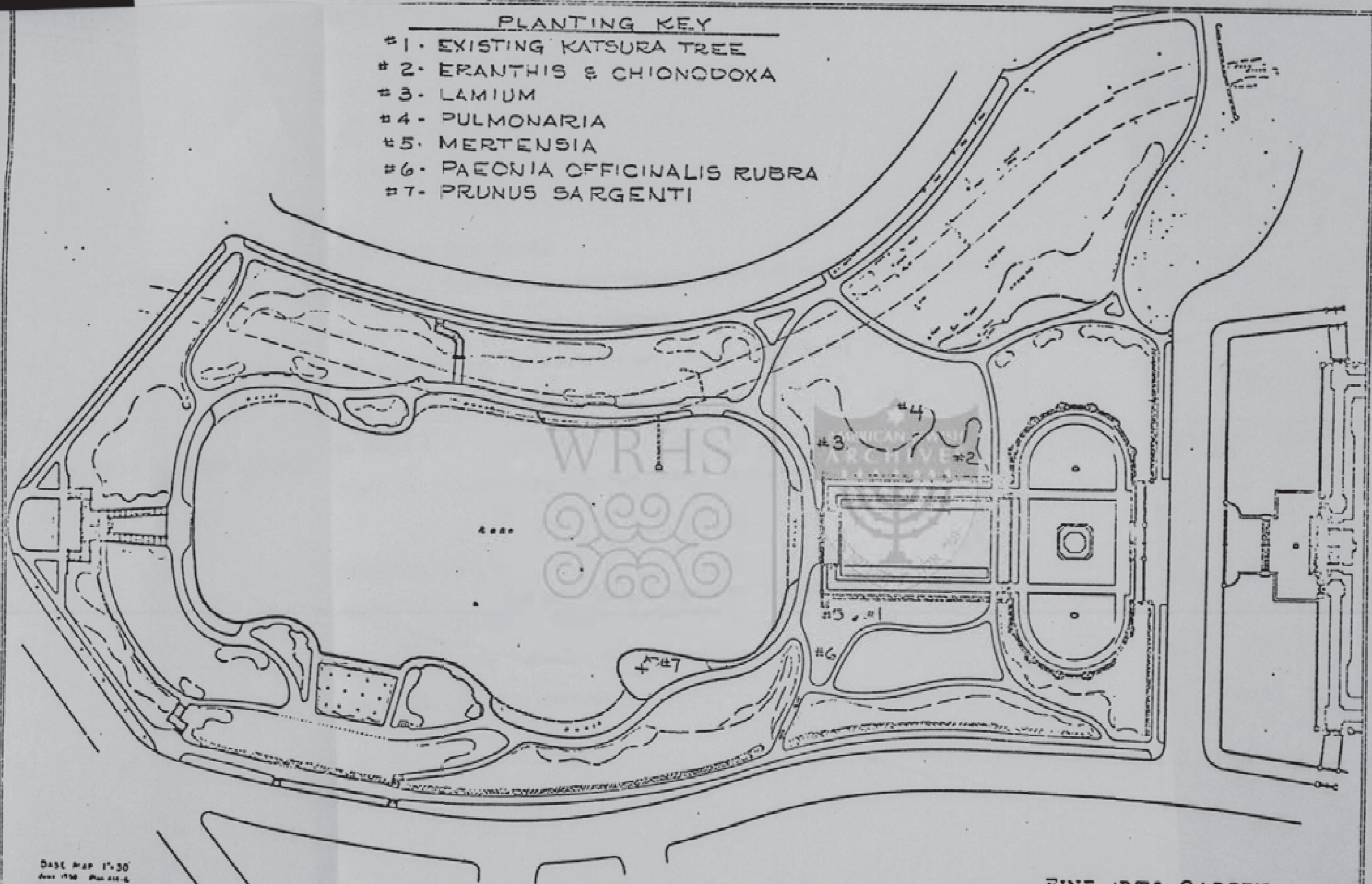

FINE ARTS GARDEN  
CLEVELAND

BASE MAP 1'-30"  
JULY 1930 PLAN 410-6  
DESIGNED BY THE CIVIL ENGINEERS  
OF THE CLEVELAND PUBLIC WORKS DEPARTMENT  
AND THE LANDSCAPE ARCHITECTS  
OF THE CLEVELAND PUBLIC WORKS DEPARTMENT  
WILLIAM B. STUBBS - LANDSCAPE ARCHITECT  
1225 E. 12TH STREET CLEVELAND, OHIO

1974

CONTENTS OF NEWS AND CALENDAR

1. Special material for the January/February 1975 issue

Advanced Placement in Art History Program, illustrated

Nevelson & sculpture, illustrated

Junior Council Lecture Series on French Impressionism

Painting Catalogue announcement

2. Features in most issues

Special exhibitions (January/February: Bickford Collection, illustrated)

Special lectures, expanded treatment

New acquisitions, at least one per issue, illustrated

Film program, illustration

In Memoria

Staff section (January/February: Karel Paukert and Ross Merrill)

3. Calendar material

Three issues -- January, May and September -- will continue publication of trimester education programs

Daily activities calendar for each month

Usual CMA calendar listings

THE CLEVELAND MUSEUM OF ART  
ACCESSIONS MEETING  
February 7, 1975

HUNT  
CUNAGI  
MONT  
HEIM

**PURCHASES:**

From - Alexander P. Rosenberg

Price:  
\$1,350,000.

Painting by Pablo Picasso, oil on canvas, painted 1918:  
HARLEQUIN WITH VIOLIN ("Si tu veux")  
Label: Purchase from the Leonard C. Hanna Jr.  
Bequest

TR 16129/1

From - Frederick Mont, Inc.

Price:  
\$480,000.

Painting by Juan de Flandes, Hispano-Flamish, ca. 1480 -  
ca. 1519; oil on panel: BIRTH OF ST. JOHN  
Label: Purchase, John L. Severance Fund

TR 16025/4

From - B. & S.D. Levy, Inc.

Price:  
\$3,650.

Painting by W.S. Haseltine, 1835-1900, oil on canvas:  
CAPRI  
Label: Purchase, Mr. and Mrs. William H. Marlatt  
Fund

TR 16085/241

From - Heim Gallery, Paris (Gerard Stora)

Price:  
\$97,000.

Sculpture by Jean-Baptiste Carpeaux (1827-1875); marble:  
BUST OF MADAME COLEMAN  
Label: Purchase, John L. Severance Fund

TR

From - Mathias Komor

Price:  
\$5,000.

Early Christian gold glass, 3rd - 4th c. A.D.:  
JONAH CAST UP BY THE SEA MONSTER  
Label: Purchase from the J.H. Wade Fund

TR 15690/11

Price:  
\$4,000.

Sculpture, Africa, Ivory Coast, Baule Tribe:  
FLY WHISK (bronze handle)  
Label: Purchase, James Albert and Mary Gardiner Ford  
Memorial Fund

TR 15690/15

From - Nicolas Koutoulakis

Price:  
\$100,000.

Textile, Egypt, ca. 4th -5th c. A.D.  
Label: Purchase from the J. H. Wade Fund

TR 16111/1

From - William Wolff, Inc.

Price: Miniature Painting, India, Guler School, ca. 1790: TR 16029/2  
\$2,700. HINDOLA RAGA  
Label: Purchase, Edward L. Whittemore Fund

From - Yamanaka & Co., Ltd. (Kyoto)

Price: Lacquered wood with mother-of-pearl inlay, China, 15th C.: TR 16033/2  
Yen 4,500,000. KESA BOX (container for priestly robes)  
Label: Purchase, Andrew R. and Martha Holden  
Jennings Fund

From - Christer von der Burg (Han-Shan Tang)

Price: Painting by Tseng Yen-Tung, Chinese, Ch'ing Dynasty: TR 1611C/1  
\$900 MINIATURE ALBUM WITH FIGURES AND LANDSCAPES  
(ink and color on paper)  
Label: Purchase, Cornelia Blakemore Warner Fund

From - Bank Leu (Dr. Leo Miltenberg)

Price: Greek pottery by the Antimenes Painter, ca. 525 B.C.: TR  
SFr. 125,000. HYDRIA  
(Approx. 49,725 US\$) Label: Purchase from the J. H. Wade Fund

From - Mohamed Yeganah

Price: Sculpture, miniature bronze, Hittite, 8th-7th c. B.C.: TR  
\$20,000. STAG  
Label: Purchase from the J. H. Wade Fund

From - Robert Light Gallery

Price: Photograph by Paul Strand (American, born 1890): TR 16131/1  
\$860. IN THE MARKET, MEXICO (1932; silver print)  
Label: Purchase, Andrew R. and Martha Holden  
Jennings Fund

From - Paul Drey Gallery

Price: Drawing by Antoine Pesne; black and red chalk with grey TR 16011/5  
\$3,000. wash on buff paper: LOT AND HIS DAUGHTERS  
Label: Purchase, Dudley P. Allen Fund

Price: Pair of drawings by Salvator Rosa; pen and brown ink TR 16011/7 a  
\$3,800. with brown and grey wash: TWO LANDSCAPE STUDIES  
Label: Purchase, Dudley P. Allen Fund

From - Mr. Ernest Joresco

Price:  
\$3,500

Sculpture, bronze, Italian Renaissance, ca. 1500:  
LION

TR 15802/2

Label: Purchase, Norman O. Stone and Ella A. Stone  
Memorial Fund

PURCHASE FROM SUNDRY PURCHASE ART FUNDS:

From - Victor D. Spark

Price:  
\$425

Drawing by J. W. Casilear (American), pencil and colored  
chalk on paper: ROUND TOWER AT SCHAFFHAUSEN (1842)

TR 15689/5

Label: Gift of Mrs. John C. Newington  
(monies previously given)



From - Mrs. Marjorie Taylor Wells

Print by Louise Havelson: JUNGLE FIGURES  
Drawing by Blampied: THE TRACHERS  
Red chalk drawing by Conrad West: NYMPHS  
AND SHEPHERDS

TR 16023/4  
TR 16023/5  
TR 16023/6

Labels: Gift of Mrs. Marjorie Taylor Wells

From - Mr. and Mrs. William E. Ward

Lithograph printed in colors by Karel Appel  
Label: Gift of Mr. and Mrs.  
William E. Ward

TR 16020/2

Woodcut printed in colors by Hideo Hoshikawa:  
A MAN IN ARMOR

TR 16020/3

Label: Gift of Mr. and Mrs. William E.  
Ward in memory of Betty Argyle Wye

YEAR-END GIFTS, 1974:

The following GIFTS, recommended by the Curators and approved by the Director, were offered between November 25 and December 31, 1974. There has been no Accessions Committee meeting since November 25; therefore the gifts are reported at this time for ratification:

From - Blumka Gallery

E.V.: \$2,000

Two textile fragments, Egypto-Arabic  
Label: Gift of Ruth Blumka in memory  
of Leopold Blumka

TR 15658/42,43

From - Mr. and Mrs. William J. Robertson

E.V.: \$100

Textile, France, early 20th century:  
FRAGMENT BASED ON MEDIEVAL PERSIAN BIRD  
DESIGN (Jacquard weave)

TR 15730/15

Label: Gift of Mr. and Mrs. William J. Robertson

E.V.: \$100

Textile, France, early 20th century:  
FRAGMENT BASED ON MEDIEVAL PERSIAN LION  
DESIGN (Jacquard weave)

TR 15630/16

Label: Gift of Mr. and Mrs. William  
J. Robertson

From - Mr. and Mrs. Robert M. Levine

E.V.: \$600

Collage-lithograph by Alan Shields:  
SUN MOON TITLE PAGE (double-sided)  
Label: Gift of Mr. and Mrs. Robert  
M. Levine

TR 15648/2

From - Mrs. Moselle Taylor Meals

E.V.: \$550

Print by Louise Nevelson: JUNGLE FIGURES  
Drawing by Blampied: THE VRAICHERS  
Red chalk drawing by Conrad Metz: NYMPHS  
AND SHEPHERDS

TR 16023/4

TR 16023/5

TR 16023/6

Labels: Gift of Mrs. Moselle Taylor Meals

From - Mr. and Mrs. William E. Ward

E.V.: \$250

Lithograph printed in colors by Karel Appel  
Label: Gift of Mr. and Mrs.  
William E. Ward

TR 16020/2

E.V.: \$750

Woodcut printed in colors by Hideo Hagiwara:  
A MAN IN ARMOR

TR 16020/3

Label: Gift of Mr. and Mrs. William E.  
Ward in memory of Betty Argyle Hays

From - Mr. F. J. Geib

E.V.: \$175

Lithograph by Honoré Daumier, French,  
1808 - 1879: LE MALADE  
(Delteil 255, state II/III; date 1835)  
Label: Gift of F. J. Geib in memory  
of his Father, Dr. F. J. Geib

TR 16072

From - Hilda Volkin

E.V.: \$70

Serigraph by Hilda Volkin, 1973-4: FIGURE I  
(4/4; 22x26"; Special Mention, 1974 May Show)  
Label: Gift of Hilda Volkin

TR 16078/1

From - Mr. and Mrs. Henry Steinberg

E.V.: \$ 150.

Lithograph by Philip Pearlstein: NUDE ON A  
STRIPED RUG  
Label: Gift of Mr. and Mrs. Henry Stein-  
berg in memory of Anthony J.  
Vaiksnoras

TR 15958/4

From - Mr. Richard Hundley

E.V.: \$

Wood engraving by Lynd Ward: SELF-PORTRAIT  
(1929)  
Label: Gift of Richard Hundley

TR 16109/1

From - Henry Hawley

E.V.: \$

Woodcut by Hendrick Goltzius, Dutch, 1558-1617: TR 15471/8  
NEPTUNE (Hollstein 367, state II/II)  
Label: Gift of Henry H. Hawley

From - Dr. Richard G. Paley

E.V.: \$ 500.

Metal, Japan, Late Kamakura-Early Muromachi  
Period, 14th-15th century: VAJRA  
(Conditions: Not to be disposed of for at  
least 5 years)  
Label: Gift of Dr. Richard G. Paley

TR 16107/1

From - Mr. Gilbert P. Schafer

E.V.: \$57,750.

Metal, China, Early Chow: KUEI  
Label: Gift of Mr. and Mrs.  
Gilbert P. Schafer

TR 16097/9

From - Mrs. Ralph Silver

E.V.: \$400.

Large Plate, Japanese, Edo Period,  
18th - 19th century  
Label: Bequest of Mrs. Ralph Silver

TR 16102/1

From - Barry Bradley

E.V.: \$ 160.

Calligraphy by Wang Wen-chin, Chinese,  
late 18th century: POEM (Pair of  
hanging scrolls)  
Label: Gift of Barry Bradley

TR 15721

From - Mrs. Katherine C. White

E.V.: \$3,500.

Sculpture, Africa, Congo-Brazzaville,  
Bakongo Tribe or Bavili Sub-tribe, 19th c.:  
STANDING MALE FIGURE (wood, iron, glass)  
Label: Gift of Katherine C. White in  
honor of William Mathewson  
Milliken on his 85th year

TR 15476/37

E.V.: \$4,750

Sculpture, Africa, Zaïre, Bayaka Tribe,  
probably ca. 1900: FETISH FIGURE  
(wood, lizard skin)

TR 15476/38

E.V.: \$7,500

Sculpture, Africa, Mali, Dogon Tribe:  
PAIR OF ANCESTOR FIGURES (wood)

TR 15476/39

E.V.: \$2,250

Sculpture, Africa, Ivory Coast, Baule:  
MASK (wood)

TR 15476/40

E.V.: \$1,250

Sculpture, Africa, Ivory Coast, Senufo Tribe:  
BIRD STANDARD (wood, with brass tacks)

TR 15476/41

E.V.: \$1,500.

Sculpture, Africa, Ghana, Akan People,  
18th - 19th century: FUNERARY HEAD  
(terra cotta)

TR 15476/42

E.V.: \$1,800

EGUNGUN MASK by Adugbologe, African, Nigeria,  
Village of Abeokuta, Yoruba Tribe; died ca. 1940

TR 15476/43

E.V.: \$1,500

STAFF (oshe Shango), wood with glass beads,  
Africa, Nigeria, Yoruba Tribe

TR 15476/44

E.V.: \$1,500

BOX IN FORM OF A DUCK, painted wood,  
Africa, Nigeria, Yoruba Tribe, probably ca.  
1900

TR 15476/45

E.V.: \$1,200

STAND or BOWL, wood with color; Africa,  
Cameroon Grasslands, probably first quarter  
of 20th century

TR 15476/46

E.V.: \$7,500

Sculpture, Africa, Zaïre, Dibaya  
Territory, Village Udolo I Dibanda,  
Bena Lalua Tribe: MALE FIGURE (wood)

TR 15476/47

Labels on TR 15476/38 - 47:  
Gift of Katherine C. White

From - Mr. Alvin N. Haas

E.V.: \$2,000.

Sculpture, Africa, Zaïre, Baluba Tribe:  
ANCESTOR FIGURE (Ntuta), wood, first  
quarter of 20th century

TR 15711/7

Label: Gift of Mr. and Mrs. Alvin N. Haas

From - Mrs. Ruth Blumka

E.V.: \$ 2,000.

Sculpture, Italy, 16th century; stone  
relief: HERCULES

TR 15658/35

Label: Gift of Ruth Blumka in memory  
of Leopold Blumka

E.V.: \$5,000.

From - Dr. and Mrs. Paul G. Ecker

Metal, Germany or Netherlands, 16th century;  
brass: DINANDERIE CANDLESTICK

TR 15693/4

Label: Gift of Dr. and Mrs. Paul G. Ecker

From - William Mathewson Milliken (partial gift)

E.V.: \$40,000  
(85% of this amount  
is gift for 1974;  
15% was gift for  
1973 - see Minutes  
of 8/6/73)

Polychromed wood sculpture, Austria, Salzburg;  
ca. 1330: MADONNA AND CHILD

TR 15946

: 73.143

Label: The Mary Spedding Milliken

Memorial Collection

Gift of William Mathewson Milliken

From - Mr. Leonard Lane

E.V.: \$1,100

Painting by Mark Greenwold, acrylic: LOVE  
Label: Gift of Ellen and Leonard Lane  
(\$1000 May Show award 1967)

TR 16049/1

From - Mrs. Albert Levin

E.V.: \$700 each  
(\$2,100)

Three photographs by Margaret Bourke-White:  
SMOKESTACKS  
TRAIN WITH OIL CARS  
INDUSTRIAL SCENE

TR 15869/8

TR 15869/9

TR 15869/10

Label: Gift of Mrs. Albert Levin

From - Mr. Godfrey Frankel

E.V.: \$100	(1946)	Four photographs by Godfrey Frankel:	
E.V.: \$100	(1945)	CHURCH COURTYARD, MORELIA, MEXICO	TR 16067/2
E.V.: \$150	(1948)	CHILDREN, RELOCATION CENTER, Heart Mt. Wyo.	TR 16067/4
E.V.: \$150	(1948)	BREAD WINDOW, EAST HOUSTON STREET, N.Y.C.	TR 16067/5
		THIRD AVENUE, N.Y.C., UNDER THE ELEVATED	TR 16067/6
		Label: Gift of Godfrey Frankel	

From - Mr. Steingrim Laursen

E.V.: \$450 each		Two drawings by Jan Groth; Norwegian, b. 1938:	
(\$900)		UNTITLED (black crayon)	TR 16054/9
		UNTITLED (black crayon)	TR 16054/10
		Label: Gift of Steingrim Laursen	

From - William R. Singelis, Scandesign

E.V.: \$70		Photograph by Nicolas C. Hlobeczy, American:	TR 16113/1
		EASTER, 1972	
		Label: Gift of Scandesign, Inc., Cleveland	
E.V.: \$500		Photograph by Minor White; American:	TR 16113/2
		BEGINNINGS, FROSTED WINDOW, Rochester, N.Y., 1962	
		Label: Gift of Scandesign, Inc., Cleveland	

From - Katherine C. White

E.V.: \$1,250		DOLL, wood with beads and string; Africa,	TR 15476/48
		Ghana, Ashanti Tribe	
		Label: Gift of Katherine C. White	

From - Mr. Noah L. Butkin

E.V.: \$34.35		Engraving, anonymous (after Hendrik	TR 15718/51
		Goltzius), Dutch: PAN PURSUING SYRINX	
		(Bartsch 48, Hollstein I.138.525)	
		Label: Gift of Mr. and Mrs. Noah L. Butkin	

From - The Print Club of Cleveland

E.V.: \$7,500		Drawing by Nicolo dell'Abate (recto & verso):	TR 15724/51
plus \$193.57 expenses		ALLEGORICAL FIGURE	
\$7,693.57		Label: Gift of the Print Club	
(from "Art for Coll.")		of Cleveland	

From - Gilbert W. Einstein Co., Inc.

E.V.: \$120		Color lithograph by Robert Kipness:	TR 16056/5
		BACK PORCH	
		Label: Gift of G.W. Einstein Company, Inc.	

From - Mrs. Lewis B. Williams

E.V.:	Watercolor drawing by Muirhead Bone: ETNA	TR 15939/8
	Ink drawing by Muirhead Bone: LAGOON, VENICE	TR 15939/9
	Ink drawing by Alphonse Legros: STUDY FOR A FOUNTAIN	TR 15939/18
	Ink drawing by Jean François Millet: COTTAGES	TR 15939/22
	Black chalk drawing by Puvis de Chavanne: CARMEN	TR 15939/23
	Etching by John Taylor Arms: MONT SAINT MICHEL	TR 15939/26
	Lithograph by Ethel Gabain: THE WEST WIND	TR 15939/32
	Drypoint by Alphonse Legros: L'ALLEE DE PEUPLIERS	TR 15939/36
	Etching by Louis Auguste Lepère: PROVINS	TR 15939/39
	Engraving by Cornelis Massys: JUSTICE AND PRUDENCE	TR 15939/46
	Lithograph by Ethel Gabain: THE BALUSTRADE	TR 15939/51
	Drypoint by Gifford Beal: THE NET WAGON	TR 15939/53
	Labels: Gift of Mrs. Lewis B. Williams	

From - Mr. and Mrs. Wilbur D. Prescott

E.V.: \$250.	Series of ten serigraphs: CITY CANVASES	TR 15745/6-15
	(Ray Domingo: Batman and Robin	
	Mort Epstein: Electric Wall Socket	
	Joseph C. Hruby: Osborn Building from Huron Road	
	John Morell: Love them, cherish them .....	
	Edwin Mieczkowski: Abstract	
	Elijah Shaw: Abstract	
	Phyllis Sloane: People on a Balcony	
	Julian Stanczak: Abstract	
	Jody Trivison and Susan Todys: Monopoly	
	Jody Trivison and Susan Todys: Abstract	
	Labels: Gift of Mr. and Mrs. Wilbur D. Prescott)	

From - Leona E. Prasse

E.V.: \$150.	Set of etchings by Giovanni Battista Piranesi: "GROTESCHI"	
	RUINS WITH DEATH'S HEAD AND SKELETON	TR 15801/22
	RUINS WITH A STATUE OF A FAUN AND FALLEN COLUMN	TR 15801/23
	RUINS WITH SERPENTS	TR 15801/24
	RUINS WITH SKULLS AND A SMOKING VASE	TR 15801/25
E.V.: \$45,000.	Etching and drypoint by Rembrandt, 1652: KING DAVID IN PRAYER	TR 15801/42
	(Hollstein XVIII.20.41, state I/III)	
E.V.: \$575.	Etching and drypoint by Jacques (James) Joseph Tissot: SOIREE D'ETE	TR 15801/43
	(Beraldi XII/132/47)	

Labels for TR 15801/22-25 and 42,43:

The Mr. and Mrs. Charles G. Prasse Collection

NOTE: The "CITY CANVASES" serigraphs and the Fragonard etching were purchased from Sotheby for these objects by the donors.

From - Hollanders Workshop, Inc.

E.V. \$100	Lithograph by Walasse Ting: UNTITLED (Artist's proof: red and yellow, black field)	TR 15930/1
E.V. \$100	Lithograph by Walasse Ting: UNTITLED (Artist's proof: red and yellow, black field)	TR 15930/2
E.V. \$50	Impression from the edition of the Print Club: Print by Walasse Ting: FIREWORKS (Print Club Publication for 1974, No. 52)	TR 15930/5

Labels: Gift of the Print Club  
of Cleveland

From - The Print Club of Cleveland

E.V.: \$600	Etching by Jean Honoré Fragonard: ST. JEROME (Baudicour 21, Wildenstein XIV i/iii) Label: Gift of the Print Club of Cleveland	TR 16080/1
-------------	---	------------

From - Gilbert P. Schafer

E.V.: \$100	} \$2,050.	Porcelain, China; pair of bowls	TR 16097/1,2
E.V.: \$100		Porcelain, China; bowl with red dragon and blue cloud decoration	TR 16097/3
E.V.: \$750		Porcelain, China; blue and white bowl with fish decoration	TR 16097/4
E.V.: \$650		Lacquer, China; box with ink cake	TR 16097/7
E.V.: \$450		Pottery, China; bowl (mottled green and tan)	TR 16097/8

Labels: Gift of Mr. and Mrs. Gilbert P.  
Schafer

From - Mr. Barrie Morrison

E.V.: \$45,000.	Sculpture, bronze (with black lacquer patina); Italy, Venice, 16th century: NEPTUNE STANDING ON A CARRIAGE DRAWN BY SEAHORSES (attributed to Tiziano Minio; 1511/12-1552) Label: Gift of Mr. Barrie Morrison	TR
-----------------	--	----

NOTE: The "CITY CANVASES" series of prints, gift of Mr. and Mrs. Wilbur D. Prescott, and the Fragonard etching, ST. JEROME, gift of the Print Club of Cleveland, were purchased from Sundry Purchase Art Funds with monies given specifically for these objects by the donors.

Gifts for the DEPARTMENT OF EXTENSION EXHIBITIONS:

From - Mrs. Martha G. Thomas

E.V.: \$25.

Japanese porcelain plate  
Label: Gift of Martha G. Thomas

TR 16122/1

From - Edward B. Henning

E.V.: \$225.

Sculpture by Ilya Bolotowsky (born in  
Russia, 1907): UNTITLED  
(screen printed plexiglass; ca. 1970)  
Label: Anonymous Gift

TR 15633/2

From - Estate of Mrs. Georgina West

E.V.: \$100.

Textile, embroidery, India, 19th century:  
Phulkari (head shawl), embroidered in  
yellow silks on gold cotton ground.  
Label: Bequest of Mrs. Georgina West

TR 14721/2

From - Mrs. Moselle Taylor Meals

E.V.:

Japanese stencil; anonymous artist  
Label: Gift of Mrs. Moselle Taylor Meals

TR 16023/7

MINUTES OF THE MEETING OF THE ACCESSIONS  
COMMITTEE HELD AT THE MUSEUM ON NOVEMBER 29,  
1975, AT 10:00 A.M. IN THE TRUSTEES ROOM

PRESENT: Mrs. Richard L. Bassett, George P. Bickford,  
Harvey Buchanan, Noah L. Butkin, Severance A.  
Millikin, Mrs. R. Henry Norweb, Lewis C. Williams,  
and Sherman E. Lee.

The minutes of the meeting held August 11, 1975, having been distributed, were approved.

The following objects were presented for PURCHASE:

From - Frederick Mont, Inc.

Price: \$45,000. Painting by Simon de Vlieger, Dutch, ca. 1600-1653: TR 16025/3  
LANDSCAPE (oil on canvas)  
Label: Purchase, Mr. and Mrs. William H.  
Marlatt Fund

From - Mr. and Mrs. Paul Mallon

Price: \$25,000. Egypto-Phoenician sculpture: HEAD TR 15537/10  
(\$9,350. as of  
11/28) Label: Purchase, Andrew R. and Martha  
Holden Jennings Fund

From - Kinkichi Yamaoka

Price: ¥25,000,000. Painting, China (?), Sung (?); hanging scroll: TR 16185/1  
(\$82,500. as of  
11/28) SHAKA TRINITY (color on silk)  
Label: Purchase, Mr. and Mrs. William H.  
Marlatt Fund

From - Shogoro Yabumoto

Price: \$40,000. Painting by Baiitsu, Japanese; hanging scroll: TR 15832/12  
WHITE PRUNUS  
Label: Purchase, Mr. and Mrs. William H.  
Marlatt Fund

From - Tseng Hsien-chi

Price: \$14,000. Painting by Hsieh Shih-chen, Chinese, handscroll: TR 15519/23  
RETURNING TO THE VILLAGE IN A RAINSTORM  
Label: Purchase, Mr. and Mrs. William H.  
Marlatt Fund

From - Chang Ting Chen

Price: \$7,000.

Painting by Lo P'ing, hanging scroll:  
SCHOLAR WATCHING THE WATERFALL

TR 16178/1

Label: Purchase, Mr. and Mrs. William H.  
Marlatt FundFrom - Bank Leu A.G.Price: SFr. 160,000.  
(\$59,340. as of  
11/28)Bronze vessel, China, Shang Dynasty: HSIEN  
Label: Purchase from the J.H. Wade Fund

TR 15680/22a

From - J.E. Eskenazi, Ltd.Price: £18,000.  
(\$36,396. as of  
11/28)Sculpture, Kashmir, 8-9th c.A.D.; brass:  
FIGURE OF ELEVEN-HEADED BODHISATTVA  
Label: Purchase, Andrew R. and Martha Holden  
Jennings Fund

TR 15902/4

From - Spink & Son, Ltd.

Price: \$1,100.

Ivory, India, Kushan: CHAIR LEGS  
Label: The Severance and Greta Millikin  
Purchase Fund

TR 15665/23

Price: \$1,000.

Bracket, monster head mask, Java, 12th c.  
Label: Purchase, Norman O. Stone and Ella A.  
Stone Memorial Fund

TR 15665/24

From - Julian SherrierPrice: £8,000.  
(\$16,176. as of  
11/28)Sculpture, India, Gandhara, 2nd c. A.D.; stone relief:  
MIRACLE OF SRAVASTI  
Label: Purchase, Andrew R. and Martha  
Holden Jennings Fund

TR 16179/1

From - Seligman & Co., Inc.

Price: \$70,000.

Sculpture, North Italian, Circle of Tullio Lombardo,  
ca. 1500: TABERNACLE RELIEF (polychromed marble)  
Label: Purchase from the J.H. Wade Fund

TR 15656/5

From - E.V. Thaw

Price: \$14,000.

2 buckles, 2 fibulae (3 Frankish, 1 Ostrogoth),  
6th and 7th c. A.D.  
Label: Purchase, Andrew R. and Martha  
Holden Jennings Fund

TR 15668/13-21

From - Cyril Humphris

Price: £4,500.  
(\$9,099. as of  
11/28)

Sculpture by Massimiliano Soldani, Italian,  
Florentine, ca. 1700; bronze: VASE  
Label: Severance and Greta Millikin  
Purchase Fund

TR 15761/7

From - Heim Gallery

Price: \$1,500.

Medallion by Auguste Barre, signed and dated 1830:  
BRONZE RELIEF  
Label: Purchase, Norman O. Stone and Ella A.  
Stone Memorial Fund

TR 15936/3

From - The Fine Art Society, Ltd.

Price: £ 700.  
(\$1,415.40  
as of 11/28/75)

Three-piece coffee set (pot, creamer, sugar bowl),  
Tiffany & Co., ca. 1879, silver inset with copper,  
gold and ivory  
Label: Purchase, Norman O. Stone and Ella A.  
Stone Memorial Fund

TR 16174,a,b

From - Louis Stotz

Price: \$ 800.

Furniture, American, ca. 1830, wood with marble top:  
CONSOLE TABLE  
Label: Purchase, A.W. Ellenberger Sr. Memorial  
Fund

TR 16182/1

From - The 56th May Show

Price: \$ 90.

Porcelain by Gail S. Vandy Bogurt:  
THE GENTLE, WIND WOOD  
Label: Purchase, Wishing Well Fund

TR 16155/32

From - David Tunick, Inc.

Price: \$1,250.

Print by Daniel Hopfer (active 1493-1536):  
EVE (state I/II)  
Label: Purchase, Delia E. Holden Fund

TR 15694/44

Price: \$1,000.

Prints (set of 14 on 3 mats) by Jacob de Gheyn II,  
(1565-1629): PASSION SET  
Label: Purchase, Delia E. Holden Fund

TR 15694/46.  
1-14

Price: \$ 425.

Print by Wenzel Hollar:  
PORTRAIT OF ARETINO (1649)  
Label: Purchase, Delia E. Holden Fund

TR 15694/43

From - Arthur Feldman Graphics

Price: \$400.

Lithograph by Joseph Cornell (one of five proofs signed by the artist): UNTITLED

TR 16194/1

Label: Purchase, Delia E. Holden Fund

From - Angus Whyte

Price \$1,750.

Two sanguine drawings by Sieuwert van der Meulen (active in Alkmaar from 1698, died in Alkmaar 1730):

TR 16195/2,3

/2: THE HERRING BARK

/3: PREPARATION OF THE HERRING BARK

Label: Purchase, Dudley P. Allen Fund

From - Plunkett and Company

Price \$285

Lithograph by Don Eddy: BMW SHOWROOM

TR 15728/38

Label: Purchase, Dudley P. Allen Fund

Upon recommendation of the Curators concerned and the Director, and upon motion duly made and unanimously carried, it was

VOTED: to approve the recommendations for purchase as listed and to appropriate the sums indicated from the income of the various funds as stated.

The following objects were presented for purchase from SUNDRY PURCHASE ART FUNDS:

From - Jerome Solomon

Price \$1,641.38  
shipping 291.20  
\$1,932.58

Sculpture by Sir Jacob Epstein (English, b. USA; 1880-1959); clay portrait figure study (fragment of original plaster): NAN, 1911

TR 16180/1

Label: Gift of William Mathewson Milliken in memory of Mr. and Mrs. Ralph M. Coe (from insurance money covering damage of a Barlath sculpture given by Wm. M. Milliken)

From - The Halsted 831 Gallery

Price \$350  
less 10%  
\$315

Photograph by James Van der Zee, American (b.1886), silver print (original vintage print), 1927: WOMEN'S CLUB

TR 15963/26

Label: Gift of The Links (monies previously given)

From - The Halsted 831 Gallery (continued)

Price \$900.  
less 10%  
\$810

Photograph by August Sander;  
BERLINER TAPEZIERMEISTER #27  
Label: Ada K. Round Bequest  
(monies previously given)

TR 15963/30

Price \$200.

Photograph by Jerry Uelsmann:  
BLESS OUR HOME AND EAGLE, 1963  
Label: Gift of Mrs. James J. Rorimer  
(monies previously given)

TR 15963/32

Price \$60.  
less 10%  
\$54.

Photograph by George Tice, 1970:  
OAK TREE (Holmoel, New Jersey)  
Label: Ada K. Round Bequest  
(monies previously given)

TR 15963/36

From - Blumka Gallery

Price \$18,000

Ivory, France, Ile-de-France, 14th c.:  
DIPTYCH

TR 15658/46

Label: Gift of Mrs. Chester D. Tripp in  
memory of Chester D. Tripp  
(\$5,000 previously given, balance to be  
paid as Mrs. Tripp's donations arrive)

From - Martin Eidelberg

(\$1,200)

Pottery by Dalpayrat: VASE  
Label: Gift of Mrs. S. Prentiss Baldwin  
by exchange

TR 16120/30

(vase received for Japonisme exhibition was broken.  
CMA insurance paid \$900; CMA paid \$300 from proceeds  
of sale of an American highboy given by Mrs. Baldwin)

From - Klein-Vogel Gallery

Price \$425.

Lithograph by Camille Martin: L'ESTAMPE ORIGINALE

TR 16045/77

Price \$300.

Two mezzotints and one etching by Frank Short (set):  
LANDSCAPE  
/78 published state  
/79 proof with mezzotint  
/80 proof without mezzotint

TR 16045/78-80

Labels: Gift of Moselle Taylor Meals  
(monies previously given)

From - Ramiel M. Howitt

Price \$450.

Watercolor by John Fulylove, British (1847-1908):  
VIEW OF THE OLD CITY OF JERUSALEM  
Label: Gift of Mr. Ralph L. Wilson  
(monies previously given)

TR 16191/1

From - Tomlinson Collection

Price \$150  
less 10%  
\$135

Etching by Mortimer Menpes:  
PORTRAIT OF WHISTLER

TR 15716/10

Label: Gift of Mr. and Mrs. Wilbur D. Prescott  
(monies previously given)

Upon recommendation of the Curators and the Director, and upon motion duly made and unanimously carried, it was

VOTED: to approve the recommendation to purchase the objects from  
Sundry Purchase Art Funds as listed.

The following GIFTS were also presented:

From - Mr. and Mrs. Noah L. Butkin

E.V. \$20,000.	Painting by Jean Victor Bertin, French, 1775-1842: FOREST LANDSCAPE WITH DAPHNE AND APOLLO	TR 15718/38
E.V. \$25,000.	Painting by Georges Michel, French, 1763-1843: LANDSCAPE	TR 15718/41
E.V. \$50,000.	Painting by Jacob Duck, Dutch: SALOME WITH HEAD OF ST. JOHN THE BAPTIST	TR 15718/52
E.V. \$75,000.	Painting by Willem Van de Velde II, Dutch, 1633-1707: SEASCAPE	TR 15718/59
E.V. \$25,000.	Painting by Dirck van Sandvoort, Dutch: PORTRAIT OF ELIZABETH SPIEGEL	TR 15718/60
E.V. \$6,500.	Ivory, German, ca. 1670/80: STATUETTE OF A PEDDLER	TR 15718/62

Labels: Gift of Mr. and Mrs. Noah L. Butkin

From - Alexandre P. Rosenberg

E.V. <del>\$250,000</del> <b>208,333</b>	Painting by Georges Braque, oil on canvas, 1929: THE CRYSTAL VASE Label: Gift of Alexandre P. Rosenberg	TR 16197/1
---	---	------------

From - Mrs. Lewis B. Williams

E.V. \$	Painting by Berthe Morisot, French, 19th c.; pastel drawing: PORTRAIT OF A CHILD	TR 15939/3
E.V. \$ 15,000.	Pottery, Korea, Koryu Period, 13th c.: WATER JAR Labels: Gift of Mrs. Lewis B. Williams	TR 15939/55

From - Dr. and Mrs. Sherman E. Lee

E.V. \$7,500. Sculpture, Italian, Venetian, attributed to Camello, TR 15652/82  
ca. 1455/60-1537, bronze: HERCULES AND THE NEMEAN LION

E.V. \$3,000. Sculpture, Japan, Kyogen mask: WHISTLER TR 15652/62

Labels: Gift of Dr. and Mrs. Sherman E. Lee

From - Dr. Leo Mildenberg

E.V. SFr. 2,000. Sculpture, Sicilian, ca. 300 B.C., terra cotta: TR 15680/20  
(748. as of FEEDING VESSEL IN THE FORM OF A PIG  
11/28) Label: Gift of Dr. Leo Mildenberg

From - Jephtha H. Wade III

E.V. 4,000. Japanese woodblock prints, triptych by Toyokuni: TR 16079/5  
WIND AMONG THE CHERRY BLOSSOMS

E.V. 10,000. Japanese woodblock prints, triptych by Utamaro: TR 16079/6  
FIREFLY HUNTING

Labels: Gift of Jephtha H. Wade

From - The Print Club of Cleveland

E.V. \$8,500. Drypoint and etching by Picasso: TR 16195/1  
L'HOMME A LA GUITARE  
Label: Gift of The Print Club of Cleveland

From - Mr. and Mrs. Robert Shearer

E.V. \$ Etching by Charles Daubigny (1817-1878): TR 16193/1  
INTERIEUR D'UNE AUBERGE  
Label: Gift of Mr. and Mrs. Robert Shearer

From - The Rev. and Mrs. Danila Pascu

E.V. \$1,500. Watercolor by T.H. Chromek (1809-1873): TR 16171/1  
ROMAN ARCH WITH VIEW OF COLISEUM  
Label: Gift of Rev. and Mrs. Danila Pascu

From - Mr. and Mrs. Henry Steinberg

E.V. \$ Lithograph by Stuart Davis: HOTEL CAFE (dated 1928/29) TR 15958/6  
Label: Gift of Mr. and Mrs. Henry Steinberg in  
honor of William Mathewson Milliken

From - Leona E. Prasse

E.V. \$450. Lithograph by John Stewart Curry: TR 15801/44  
STALLION AND JACK FIGHTING (dated 1944)  
Label: The Mr. and Mrs. Charles G. Prasse  
Collection

Upon recommendation of the Curators concerned and the Director, and upon motion duly made and unanimously carried, it was

VOTED: to accept the gifts offered as unrestricted gifts,  
and to express to the donors the appreciation of  
the Trustees.

Upon motion duly made and unanimously carried, it was

VOTED: to request the Trustees to appropriate the following  
sums for the use of the Accessions Committee from the  
income of the funds allocated for purchase of works  
of art:

Dudley P. Allen Fund	\$ 2,035.00
A.W. Ellenberger Sr. Memorial Endowment Fund	800.00
Delia E. Holden Fund	3,075.00
Andrew R. and Martha Holden Jennings Fund	75,922.00
Mr. and Mrs. William H. Marlatt Fund	188,500.00
The Severance and Greta Millikin Purchase Fund	10,199.00
Norman O. Stone and Ella A. Stone Memorial Fund	3,915.40
Wishing Well Fund	90.00
J. H. Wade Fund	129,840.00
<b>TOTAL:</b>	<b>\$414,376.40</b>

Also offered to the Museum from the Estate of Julia Feininger, and recommended for acceptance, was a large number of original woodblocks by Lyonel Feininger (TR 16189/1-46). A detailed list will be submitted at the next Accessions Committee meeting.

The meeting then adjourned.

Sherman E. Lee  
Director

MINUTES OF THE MEETING OF THE ACCESSIONS  
COMMITTEE HELD AT THE MUSEUM ON JANUARY 8,  
1976, AT 4:00 P.M. IN THE TRUSTEES ROOM

PRESENT: Mrs. Richard Bassett, George P. Bickford,  
Harvey Buchanan, Robert I. Gale, Jr., James D.  
Ireland, Severance A. Millikin, Mrs. Alfred M.  
Rankin, Daniel J. Silver, Paul J. Vignos, Jr.,  
Lewis C. Williams, and Sherman E. Lee.

It was agreed to distribute the minutes of the meeting held on November 29, 1975 along with the present minutes of the meeting on January 8, 1976.

The following object was presented for purchase:

From - The University Museum of the University of Pennsylvania

Price: Painting, Chinese, handscroll: SPRING MORNING AT THE PALACE  
max. \$200,000. Label: Purchase, John L. Severance Fund  
(\$180,000.)

TR 15114/2

Upon recommendation of Mr. Wai-kam Ho and the Director, and upon motion duly made and unanimously carried, it was

VOTED: to approve the recommendation for purchase and to request the Trustees to appropriate up to \$200,00.00 for the use of the Accessions Committee from the income of the John L. Severance Fund.

The Director was authorized to conclude negotiations with the University Museum of the University of Pennsylvania concerning a probable 10% discount on the price of the scroll.

(Shortly thereafter, the final price of \$180,000.00 was agreed upon.)

A detailed listing of the Feiniger woodblocks accepted as gift on November 29, 1975, was submitted (see Appendix I).

Lists of year-end gifts for 1975 (see Appendix II) and of purchases and gifts for the Department of Extension Exhibitions, also made in 1975 (see Appendix III), were submitted for ratification. Upon recommendation of the Curators concerned and the Director, and upon motion duly made and unanimously carried, it was

VOTED: to accept the gifts offered as unrestricted gifts and record them as received during the year 1975, and to express to the donors the appreciation of the Trustees.

Thereupon the meeting was adjourned.

Sherman E. Lee  
Secretary

Acceptance of a number of original woodblocks by Lyonel Feininger, offered from the Estate of Julia Feininger, was recommended at the Accessions Committee meeting of November 29. A detailed list of these gifts, which have been accepted, is now submitted.

- TR 16189/1 Church (Zirchow?)  
(Prasse W1)
- /2 On the Lookout  
(Prasse W9)
- /3 Gelmeroda Church  
(Prasse W11)
- /4 Lighthouse  
(Prasse W17)
- /5 Rainy Day on the Beach (block split in two pieces)  
(Prasse W39)
- /6 Men, Houses, Lantern and Pushcart  
(Prasse W72)
- /7 Ships in Port  
(Prasse W74)
- /8 Houses in Paris  
(Prasse W 76) Only bottom half to be delivered. Block split --  
not recorded in Prasse.
- /9 Locomotive on the Bridge  
(Prasse W81)
- /10 Side Wheeler  
(Prasse W83)
- /11 Promenade  
(Prasse W86)
- /12 City with Church in the Sun  
(Prasse W87)
- /13 Street Lantern  
(Prasse W105)
- /14 Ships in a Harbor  
(Prasse W117)
- /15 The Hack  
(Prasse W123)
- /16 Old Shellbacks  
(Prasse W124)
- /17 Ships in Heavy Sea  
(Prasse W137)

- R 16189/18 Houses (Prasse W145)  
Happy Boat Ride (Prasse W146) } One block
- /19 Three Fir Trees  
(Prasse W155)
- /20 Lighthouse  
(Prasse W172)
- /21 Troistedt  
(Prasse W182)
- /22 Anglers  
(Prasse W191)
- /23 The Lantern on the Bridge  
(Prasse W197)
- /24 The Ship (with sun)  
(Prasse W198)
- /25 Ships and Sun  
(Prasse W201)
- /26 Coast Guard  
(Prasse W202)
- /27 Fir Trees and Sun  
(Prasse W203)
- /28 Village Church  
(Prasse W210)
- /29 Ships (with man on a pier)  
(Prasse W216)
- /30 Ships Along the Shore  
(Prasse W233)
- /31 Title page: Zwolf Holzschnitte von Lyonel Feininger  
(Prasse W236)
- /32 Estuary -(block split in two pieces)  
(Prasse W238)
- /33 Marine, 2 (with two figures on beach) - (block split in three pieces)  
(Prasse W241)
- /34 Houses and Church - (block split in two pieces)  
(Prasse W244)
- /35 Evening by the Sea  
(Prasse W246)

YEAR-END GIFTS, 1975

2 16189/36 Church  
(Prasse W249)

/37 St. Nikolai  
(Prasse W250)

/38 Possendorf  
(Prasse W251)

/39 Süssenborn  
(Prasse W253)

/40 Old Gables in Luneburg  
(Prasse W256)

/41 Siemensstadt  
(Prasse W294)

/42 Two small wood blocks cut by Feininger children

/44 Trees and Stars  
(Prasse W260)

/45 Architecture  
(Prasse W232)

/46 Lighthouse  
(Prasse W278)

Label: Gift of Andreas Feininger, T.Lux Feininger  
and Father Laurence Feininger in honor of  
Leona E. Prasse



From: Thomas P. Miller

Valrus Ivory, English, Winchester (?) late 18th c.  
LION HEAD (possibly for a Tea Caddy)

Label: Gift of Thomas P. Miller in memory of  
James J. Horner

From: Dr. Paul G. Ecker, M.D.

Furniture, Dutch, 17th c.: CHEST

Label: Gift of Dr. and Mrs. Paul G. Ecker

From: Mrs. Robert C. Brown

Glass, Bohemia, mid-19th c.: PAIR OF VASES

/1 LADY WITH BEALEDRESS AND ERMINE-TRIMMED MINK

/2 LADY WITH TIARA

Label: Anonymous gift

## YEAR-END GIFTS, 1975

The following gifts, recommended by the Curators and approved by the Director, were offered between November 29 and December 31, 1975. There has been no Accessions Committee meeting since November 29; therefore the gifts are reported at this time for ratification:

From - Countess Elsie Lee Gozzi; Fortuny, Inc.

TR 16198/1

- E.V.: \$1,000. Textile, two joined panels of silk-lined "Fortuny Painted Velvet," made by Mariano Fortuny y de Madrazo; Italy, Venice, Fabrica Fortuny, early 1920s.  
Label: Gift of Countess Elsie Lee Gozzi

From - Estate of Mary Frances Fenton

- E.V.: \$200. 9 Carpets (accepted as GIFTS TO BE SOLD): TR 16200/1-9  
75. Hamadan, center diamond, geometric pattern  
200. Anatolian mat, three medallions  
350. Sinna mat, all-over pattern  
200. Royal Bokara, red field  
400. Caucasian, two center medallions, star design border  
50. Kabestan, multi-colored geometric repeat design  
750. Small Anatolian mat  
300. Shiraz runner, 3 hand border, over-all pattern  
Caucasian rectangular central panel

From - Mrs. Chester D. Tripp

- E.V.: \$6,000. Sculpture, South Netherlands, Brabant, ca. 1400; bronze: TR 16162/3  
MADONNA AND CHILD  
Label: Gift of Mrs. Chester D. Tripp

From - Thomas P. Miller

- E.V.: \$10,000. Walrus ivory, English, Winchester (?), late 11th c.: TR 16204  
LION HEAD (possibly for a Tau Cross)  
Label: Gift of Thomas P. Miller in memory of  
James J. Rorimer

From - Paul G. Ecker, M.D.

- E.V.: \$ 7,500. Furniture, Dutch, 17th c.: CHEST TR 15693/5  
Label: Gift of Dr. and Mrs. Paul G. Ecker

From - Mrs. Robert C. Brouse

- E.V.: \$1,500. Glass, Bohemia, mid-19th c.: PAIR OF VASES TR 16183/1,2  
/1 LADY WITH HEADDRESS AND ERMINE-TRIMMED ROBE  
/2 LADY WITH TIARA  
Label: Anonymous gift

From - Dr. Richard G. Paley

E.V.: \$3,500.

Porcelain, China, Ch'ing Dynasty, K'ang Hsi Period  
(1662-1722): VASE

TR 16107/3

Label: Gift of Dr. Richard G. Paley

From - Dr. and Mrs. Sherman E. Lee

E.V.: \$200.

Pottery, Japan, Kamakura Period, 13-14th c.:  
COVERED BOX

TR 15652/67

Label: Gift of Dr. and Mrs. Sherman E. Lee

From - Mrs. Martin M. Reed

E.V.:

\$400.

Yü-hai, volumes 118-120, a Ming edition with painting on  
the edges; China, Ming Dynasty (1368-1644)

TR 16199/1-4

Label: Gift of Mrs. Martin M. Reed

Text (accessioned as apparatus)

Woodblock print on paper (accessioned as apparatus)

Woodblock for print (accessioned as apparatus)

From - Richard Karberg

E.V.: \$20.

Photograph by Richard Karberg: St. Al's

TR 16155/130

Label: Gift of Richard Karberg

From - Mrs. Katherine C. White

E.V. :

African sculpture:

TR 15476/49-67

\$5,500.

/49 Dogon, White Monkey Mask (wood)

4,500.

/50 Senufo, Horned Helmet Mask (wood)

2,500.

/51 Sherbro, Figure of a Woman (soapstone)

800.

/52 Sherbro, Miniature Figure (soapstone)

5,500.

/53 Baule, Mask with Horns (wood)

6,500.

/54 Anyi, Figure of a Seated Man (wood)

1,000.

/55 Ashanti, Head (terra cotta)

2,800.

/56 Fanti, Doll (wood)

1,500.

/57 Yoruba, Drum (wood)

1,700.

/58 Ibibio, Mask (wood)

2,200.

/59 Cameroon Grasslands, Cow Mask (wood)

1,200.

/60 Cameroon Grasslands, Pipe Bowl (pottery)

500.

/61 Cameroon Grasslands, Pipe Bowl (pottery)

2,000.

/62 Babembe, Figure (wood)

1,800.

/63 Bateke, Figure of a Man (wood)

1,800.

/64 Bakongo, Bell (wood)

3,000.

/65 Basuku, Male Figure (wood)

5,000.

/66-67 Yoruba, Pair of Gelede Masks (wood)

\$ 49,800.

Labels: Gift of Katherine C. White

From - Mrs. Richard Treaster

E.V.:

Painting by Richard Treaster, American, Cleveland School,  
born 1932; pencil, water color and tempera; 1970: THE CELLIST

TR 16207/1

Label: Gift of Mrs. Richard Treaster

From - Mr. and Mrs. Richard B. Tullis

E.V.: \$1,470. Seven uninked embossed prints by Jack Zajac, American, TR 16164/1-7  
 (\$210 each) born 1929: THE PLEASURE GARDENS OF COUNT GIOVANNI DI  
 POGGIBONSI, II:  
 /1 The Statue  
 /2 The Shore  
 /3 The Tree  
 /4 The Swan  
 /5 The Bird  
 /6 The Cascade  
 /7 The Mountain

Label: Gift of Mr. and Mrs. Richard B. Tullis

From - Moselle Taylor Meals

E.V.: \$800. /23 Woodcut from the "SCHATZEEHALTER", attr. to Wolgemut TR 16023/23-25  
 125. /24 Etching by Adrian van der Cabel: LANDSCAPE  
 12. /25 Etching by William Strang: DAVID STRANG, No.1

Label: Gift of Moselle Taylor Meals

From - Dr. and Mrs. Sherman E. Lee

E.V.: \$200. Drawing by circle of Adam Elsheimer (Hendrik Goudt? 1585-1630) TR 15652/68  
 HOLY FAMILY

Label: Gift of Dr. and Mrs. Sherman E. Lee

From - Edward B. Henning

E.V.: \$100. Lithograph by Antonio Tapias, Spanish, born 1923: TR 15981/15  
 ROUGE SUR PAPIER JOURNAL (1970)  
 E.V.: \$100. Etching with plate tone, by Ben Nicholson, born 1894: TR 15981/16  
 FRAGMENT OF TUSCAN CATHEDRAL (1965)  
 E.V.: \$100. Drypoint by Bernhard Luginbühl, Swiss, born 1929: TR 15981/17  
 PLAN FÜR STENGEL (1968)  
 E.V.: \$100. Screen print by Nicholas Krushenick, American, born 1929: TR 15981/18  
 ROCK SOUP (1971)

Labels: Anonymous gift

From - Mr. and Mrs. William E. Ward

E.V.: \$450. Woodcut printed in colors by Hirokyuki Tajima: TR 16020/5  
 AN EVIDENCE G

Label: Gift of Mr. and Mrs. William E. Ward  
 in memory of Walter Blodgett

From - Estate of Walter Blodgett

- E.V.: \$400. Drypoint by Lovis Corinth: PORTRAIT OF ANDREAS WEISSGAERBER TR 16202/1  
(second version), (Schwarz 377), 1919
- E.V.: \$100. Engraved copy after Hans Sebald Beham: MUSICA TR 16202/2  
(Pauli 127a)
- E.V.: \$400. Watercolor drawing by Georg Wilhelm Baurenfeind TR 16202/3  
(German, died 1763): MUSHROOMS

Labels: Bequest of Walter Blodgett

From - Impressions Workshop, Inc.

- E.V.: \$50 Lithograph by Paul Maguire: AFTER GOYA TR 16098/6  
(accessioned as apparatus)

From - Mr. and Mrs. Frank K. Griesinger

- E.V.: \$750,000. Painting by Paul Gauguin, oil: TE RAHU RAHI TR 16206/1  
(5% of it to be Label: Jointly owned by the Cleveland Museum of Art  
1975 gift to CMA) and an anonymous Collector

From - Alexandre P. Rosenberg

- E.V.: \$30,000. Pair of Firedogs with Chinoiserie subjects, French, TR 16197/2,3  
18th c., gilt bronze  
Label: Gift of Alexandre P. Rosenberg and Micheline Sinclair

From - Mr. and Mrs. William D. Wixom

- E.V.: \$4,000. Lithograph by Henri Matisse: SEATED ODALISQUE TR 15644/2  
(Lieberman III bis)  
Label: Gift of Mr. and Mrs. William D. Wixom

From - Mrs. Katherine C. White (Addendum)

TR 15476/68-72

- E.V.: African sculpture:
- |                  |                                    |
|------------------|------------------------------------|
| \$1,800.         | /68 Benin, coil armlet (bronze)    |
| 1,400.           | /69 Cameroon, stool (wood)         |
| 4,500.           | /70 Bakongo, bell (wood)           |
| 2,800.           | /71 Bakuba, cup (wood)             |
| 750.             | /72 Bakuba, box (wood)             |
| <u>\$11,250.</u> | Labels: Gift of Katherine C. White |

The following purchases were approved and gifts accepted for the Department of Extension Exhibitions:

Also reported for ratification are the following purchases from previously given monies in the SUNDRY PURCHASE ART FUNDS and from the Wishing Well Fund:

From - Impressions Workshop, Inc.

Price:  
\$515.

Four lithographs in colors by Herb Jackson, American,  
born 1945: THE ELEMENTS

TR 16098/7-

/7 Earth

/8 Air

/9 Fire

/10 Water

Label: Gift of Moselle Taylor Meals  
(monies previously given)

From - Julius Bohler

Price:  
DM 4,200.  
(\$1,601.04)

Drawing by Giovanni Paolo Panini, Italian, 1691/2 - 1765;  
pencil on paper: STANDING LADY IN A FUR-TRIMMED CLOAK

TR 15666

Label: Gift of Moselle Taylor Meals  
(monies previously given)

From - The 56th May Show

Spec. Price:  
\$180  
(orig. \$250)

Lithograph and serigraph by Hugh Kepets: BOTANICAL GARDEN I  
(edition 14/80)

TR 16155/135

Label: Purchase, Wishing Well Fund

From - E. M. L. L. L.

Price: \$45

Basketry, Melanesian, VANUATU

TR 16155/135

Label: Purchase, Harold T. Clark Educational Extension  
Fund

From - Museum of Fine Arts, Boston

Price: \$35

Textile, crewel embroidery, American, 20th c., reproduction

TR 16155/135

of plant motif taken from a crewel embroidered bed curtain,

New England, Ipswich, Massachusetts, 1725-1750.

Original in Museum of Fine Arts, Boston.

Embroidery by Harriet Albright, C.M.A., 1953

Label: Extension Exhibition Department Fund

From - The 56th May Show

Price: \$18

Factory by Suzanne Gilbert: BOWLED FORM No. 1

TR 16155/135

(glazed stoneware vase)

Label: Purchase, Harold T. Clark Educational  
Extension Fund

The following purchases were approved and gifts accepted for the  
Department of Extension Exhibitions:

## PURCHASES:

From - Bill Wright

Price: \$25	Jewelry, Dogon Tribe: RING, MAN AND ANIMAL	TR 16175/1
\$25	Jewelry, Senufo Tribe: RING, ANIMAL	/2
\$20	Metal goldweight, Baulé Tribe: SNAKE	/3
\$40	Basketry, Lobi Tribe: WEDDING BASKET; woven fiber and leather	/4, a-j
<u>\$110.</u>	(nest of 10 with stopper)	
	Label: Purchase, Harold T. Clark Educational Extension Fund	

From - Lawrence A. Walker

Price: \$60	Three blockprints by Lawrence A. Walker, American;	Tr 16169/1-3
	all dated June '75: COMPLEMENTARY TARGET I	
	COMPLEMENTARY TARGET II	
	COMPLEMENTARY TARGET III	
	Label: Purchase, Harold T. Clark Educational Extension Fund	

From - The 56th May Show

Price: \$55	Box, inlaid, walnut and ebony, by Joseph M. Woodell	TR 16155/315
less 10%	Label: Purchase, Harold T. Clark Educational Extension Fund	
<u>\$49.50</u>		

From - H.M. Lissauer

Price: \$45	Basketry, Melanesia: YAM MASK	TR 15569/11
	Label: Purchase, Harold T. Clark Educational Extension Fund	

From - Museum of Fine Arts, Boston

Price: \$35	Textile, crewel embroidery, American, 20th c. reproduction	TR 16201/1
	of plant motif taken from a crewel embroidered bed curtain,	
	New England, Ipswich, Massachusetts, 1725-1750.	
	Original in Museum of Fine Arts, Boston.	
	Embroidery by Hermine Altmann, C.M.A., 1975	
	Label: Extension Exhibition Department Funds	

From - The 56th May Show

Price: \$18	Pottery by Suzanne Gilbert: ROUNDED FORM No.2	TR 16155/88
	(glazed stoneware vase)	
	Label: Purchase, Harold T. Clark Educational Extension Fund	

From - Richard Hundley

Price: \$100. Two wood engravings by Lynd Ward: TR 16109/2,3  
 GOD'S MAN (1929) and WILD PILGRIMAGE (1931)  
 Labels: Purchase, Harold T. Clark Educational  
 Extension Fund

From - The Cleveland Museum of Natural History

Price: \$15 Basket, Africa, Botswana Okavango River Region TR 16149/2  
 (reeds, grasses; coiled)  
 Label: Purchase, Harold T. Clark Educational  
 Extension Fund  
 (accessioned as apparatus)

## GIFTS:

From - Mrs. Moselle Taylor Meals

E.V.:	\$35	Costume, Iran, 20th century: EMBROIDERED COAT	TR 16023/18
	\$50	Rubbing from Ise Shrine, Japan (framed)	TR 16023/17
	\$25	Etching by C. Bouverie Hoyton: DUNBERRY BEACON	TR 16023/19
	\$25	Etching by C. Bouverie Hoyton: WROXTOR DOWN	TR 16023/20
	\$	Illustration from a printed 15th c. book; woodcut	TR 16023/21
	\$40	Etching by William Strang: WILLIAM SHARP (FIONA MACLEOD)	TR 16023/22

Labels: Gift of Moselle Taylor Meals

From - Dr. Arthur J. Newman

E.V.: Costume, China: ROBE TR 16203/1  
 Label: Gift of Dr. and Mrs. Arthur J. Newman

From - Mrs. William F. Kirsch

E.V.:		Three Japanese prints:	TR 16187/1-3
	\$20.	Hiroshige: AN INTERIOR, COUNTRY INN	
	\$20.	Toyokuni: LADY FLUTIST AND GUESTS	
	\$20.	Hiroshige: ENJOYING THE COAST VIEW AND CHERRY BLOSSOMS	

Labels: Gift of Mrs. William F. Kirsch

From - Linda Robb

E.V.: \$300. Ivory, Japan, 19th c.: VASE (with tin liner) TR 16166/1  
 Label: Gift of Linda Robb

From - Edward B. Henning

E.V.:	\$35	Lithograph by Alfred Manessier: PRINTEMPS PRECOCE	TR 15981/8
	\$25	" by Catherine Murphy: STILL LIFE WITH REPRODUCTION, 1975	/9
	\$25	" by Enrique Castro-Cid: CHRISTMAS BIRD, 1973	/10
	\$50	" by Henry Moore: RECLINING FIGURE	/11
	\$30	" by Ettore Colla	/12

From - Edward B. Henning (cont'd.)

E.V.: \$35	Lithograph by Zao Wou-Ki	TR 15981/13
\$25	Embossed intaglio by Horst Antes	/14
\$35	Serigraph by Adja Yunkers: MORKETIDEN ; 1972	/19
\$50.	Woodcut print by Jean Charlot, Mexican (b. France): PREPARING KAWA-FIJI; 1971	/20
	Labels: Anonymous gift	
	(all accessioned as apparatus)	

From - Dr. James B. Birch and James A. Birch

E.V.: \$300.	Textile, American, 19th c.: Cotton quilt	TR 16188/2
	Label: Gift of Dr. James B. Birch and Mr. James A. Birch in memory of Dr. and Mrs. Thomas Bruce Birch	

From - Dr. James B. Birch

E.V.: \$150.	Textile, American, 19th c.: Crochet coverlet	TR 16188/1
	Label: Gift of Dr. James B. Birch	

From - James A. Birch

E.V.: \$150.	Textile, American, 19thc.: Cotton quilt	TR 16093/2
	Label: Gift of James A. Birch	
E.V.: \$30.	Block print by Theresa Sherman, American, 20th c.	TR 16093/3
	(accessioned as apparatus)	

From - Mrs. Edd A. Ruggles (deceased)

E.V.: \$80.	Dedham Stoneware Pottery, Massachusetts, executed ca. 1930: 4 plates (FRUIT, RABBIT, AZALEA, RABBIT)	TR 15759/284-287
	(accessioned as apparatus)	

From - Rose Weizman

E.V.: \$50.	Printing block, wood, 20th c.	TR 16167/1
	(accessioned as apparatus)	

From - Mrs. Robert C. Bonner

E.V.: \$35.	Textile by June Bonner, American: Silk (fold dyed, natural indigo dye)	TR 15944/4
	(accessioned as apparatus)	

MINUTES OF THE MEETING OF THE ACCESSIONS  
COMMITTEE HELD AT THE MUSEUM ON FEBRUARY 25,  
1976, AT 4:00 P.M. IN THE TRUSTEES ROOM

PRESENT : Mrs. Richard Bassett, Harvey Buchanan,  
Noah L. Butkin, Robert I. Gale, Jr.,  
Severance A. Millikin, Mrs. Alfred M. Rankin,  
Daniel J. Silver, Lewis C. Williams, and  
Sherman E. Lee.

The minutes of the meetings held November 29, 1975, and January 8, 1976, having been distributed, were approved.

The following objects were presented for purchase:

From - Leggatt Brothers

Price: Painting by Michelangelo Merisi da Caravaggio, Italian,  
\$3,250,000. 1573-1610 (oil on canvas):  
MARTYRDOM OF ST. ANDREW  
Label: Purchase, Leonard C. Hanna Jr. Bequest

TR 16210/1

From - Roland Do Huu

Price: Sculpture, bronze, Nepal, ca. 10th century:  
\$160,000. AVALOKITESVARA  
Label: Purchase, John L. Severance Fund

TR 15766/3

From - Mrs. Paul Mallon or Milton Girod

Price: Sculpture, Egypt, Amarna Relief:  
SFr. 250,000. HEAD OF NEFERTITI  
(app.\$98,000.) Label: Purchase from the J.H. Wade Fund

TR 15537/14

From - Bruce McAlpine

Price: Sculpture, alabaster, Early Dynastic Egypt:  
\$15,000. FROG  
Label: Purchase, Andrew R. and Martha Holden  
Jennings Fund

TR 16161/1

From - Otto Wertheimer

Price: Drawing by Thomas Gainsborough:  
\$25,000. MRS. SIDDONS  
Label: Purchase, John L. Severance Fund

TR 14738/2

From - Julius Böhrer

Price:  
DM 3,800.  
(\$1,487.70)

Drawing by Friedrich Preller the Elder, German, 19th c.:  
GATHERING AT THE PRELLERS'  
Label: Purchase, Delia E. Holden Fund

TR 15666/6

Upon recommendation of the Curators concerned and the Director, and upon motion duly made and unanimously carried, it was

VOTED: to approve the recommendations for purchase as listed  
and to appropriate the sums indicated from the income  
of the various funds as stated,  
and to request the Trustees to appropriate the following  
sums for the use of the Accessions Committee from the  
income of the funds allocated for purchase of works of art:

Leonard C. Hanna Jr. Bequest	\$3,250,000.00 *)	
Delia E. Holden Fund	1,487.70	
Andrew R. and Martha Holden Jennings Fund	15,000.00	
John L. Severance Fund	185,000.00	
J.H. Wade Fund		SFr. 250,000.00

The meeting then adjourned.

\*) Payment schedule for the Caravaggio painting  
from the Leonard C. Hanna Jr. Bequest:

July 10, 1976	\$200,000.
October 10, 1976	400,000.
January 10, 1977	400,000.
April 10, 1977	400,000.
July 10, 1977	350,000.
October 10, 1977	450,000.
January 10, 1978	400,000.
April 10, 1978	350,000.
July 10, 1978	300,000.
	<u>\$3,250,000.</u>

Sherman E. Lee  
Secretary

MINUTES OF THE MEETING OF THE ACCESSIONS  
COMMITTEE HELD AT THE MUSEUM ON JULY 29,  
1976, AT 3:30 P.M. IN THE TRUSTEES' ROOM

PRESENT: George P. Bickford, Noah. L. Butkin, Robert  
I. Gale, Jr., James D. Ireland, Severance A.  
Millikin, Mrs. Alfred M. Rankin, Daniel J.  
Silver, Paul J. Vignos, Jr., Lewis C. Williams  
and Sherman E. Lee.

The minutes of the meeting held May 7, 1976, having been distributed, were approved.

The following objects were presented for PURCHASE:

From - Uraeus Gallery

Price: Relief Sculpture, Egypt, Dynasty XVIII, from the  
\$100,000. Funerary Temple of Amenhotep III: NOME GOD  
Label: Purchase, John L. Severance Fund

TR 16248/1

From - Blumka Gallery

Price: Pottery, Germany, 18th century: STRASBOURG TUREEN  
\$12,000. (tureen, lid platter)  
exp.: 124.21 Label: Purchase, Andrew R. and Martha  
\$12,124.21 Holden Jennings Fund

TR 15658/57

From - Macklowe Gallery

Price: Furniture, France, ca. 1910; wood with ormolu:  
\$12,500. MAJORELLE CABINET  
exp.: 461.66 (cabinet, marble top, two shelves, piece of ormolu)  
\$12,961.66 Label: Purchase, John L. Severance Fund

TR 16238/1

From - R.M. Light & Co., Inc.

Price: Etching by Rembrandt: THE STROLLING MUSICIANS  
\$7,000. Label: Purchase from the J.H. Wade Fund

TR 15481/8

From - N.W. Lott & H.J. Gerrish, Ltd.

Price: Etching by Samuel Palmer: CHRISTMAS  
L 195. Label: Purchase, Delia E. Holden Fund  
(ca.\$350)

TR 16241/1

From - Setsu Gatodo Co., Ltd.

Price:  
Yen 10,000,000.  
(ca.\$33,420.00)  
exp.: \$80.95

Painting by Shugetsu, Japanese, died 1510:  
HABOKU LANDSCAPE  
Label: Purchase from the J.H. Wade Fund

TR 16034/4

From - Bunzo Nakanishi

Price:  
\$10,000.

Painting, Japan, Momoyama Period; painted in strong  
colors and mounted as a kakemono: DAIITOKU MYOO  
Label: Purchase, John L. Severance Fund

TR 16044/4

From - Tokyo Gallery, Ltd.

Price:  
\$2,485.  
(£1,400)

Sculpture, Chinese, 18th century; boxwood, with  
separate base: FIGURE SEATED IN A BOAT  
Label: The Severance and Greta Millikin  
Purchase Fund

TR 16249/1

From - Katsuhiro Kobayashi

Price:  
\$1,015.50  
(Yen 300,000.)

Painting by Chinzan, Japanese, 1801-1854; album,  
six leaves; color on silk: FLOWERS AND INSECTS  
Label: Purchase, Cornelia Blakemore Warner  
Fund

TR 16218

From - Associated American Artists

Price:  
\$220.-  
500.  
350.  
110.  
171.  
\$1,351.

Japanese Prints from "The Theatrical World of Osaka" :  
Gigado Ashiyuki: ARASHI RIKAN II AS KIZU NO KANSUKE  
Shunshosai Hokucho: ICHIKAWA EBIJURO II AS HORIGUCHI MANZAEMON  
Gototei Hirosada: MASAEMON, OTANI AND YAMADA  
Ryusai Kunishige: UNKNOWN ACTOR AS SOKUJO OSONO  
Ichiyosai Yoshitaki: UNKNOWN ACTOR (\$190 less 10%)

TR 16186/

/1

/2

/3

/10

Labels: Purchase, Edward L. Whittemore Fund

From - Robert G. Sawers

Price:  
\$300.

Pair of Japanese Prints, Kuniyasu & Ashikuni, Osaka:  
/3 SOLDIER WITH SWORD ABOVE HEAD (fence in background)  
/4 SOLDIER THRUSTING HIS SWORD (2 haystacks in background)  
Label: Purchase, Edward L. Whittemore Fund

TR 16136/3,4

From - William Wolff, Inc.

Price:  
\$12,000.

Sculpture, India, Gupta Period (320-550); stone:  
VISHNU  
Label: Purchase from the J.H. Wade Fund

TR 16029/5

From - Spink and Son, Ltd.

Price: Sculpture, West Tibet, 10-11th c.; brass inlaid TR 15665/26  
 \$11,000. with silver: STANDING BODHISATTVA PADMAPANI  
 exp.:79. Label: Purchase, John L. Severance Fund  
 \$11,079.

From - Ulrich von Schroeder

Price: Metalwork, India, Gandhara, Upper Swat, 5-6th c.; TR 16205/1  
 SFr.7,500. bronze: RELIQUARY BOX  
 (ca.\$3,040.) Label: Edward L. Whittmore Fund

Upon recommendation of the Curators concerned and the Director, and upon motion duly made and unanimously carried, it was

VOTED: to approve the recommendations for purchase as listed and  
 to appropriate the sums indicated from the income of the  
 various funds as stated.

The following PURCHASE was also presented:

From - Loewi-Robertson, Inc.

Price: Textile, Levantine, 12th century: SILK FRAGMENT TR 15730/17  
 \$7,500. Label: Purchase from the J.H. Wade Fund

Upon recommendation of the Curator of Textiles and the Director, and upon motion duly made, it was

DECIDED BY A VOTE OF 6 TO 1 : to approve the recommendation  
 for purchase and to appropriate the sum indicated  
 from the income of the J.H. Wade Fund.

Then the following GIFTS were presented:

From - Anonymous Donor

E.V.: Jade, India, Mughal: FOOTED PLATTER TR 15346/6  
 \$22,000. Label: Anonymous Gift

From - George P. Bickford

E.V.: Painting, India, Mughal, Akbar Period, 1526-1577: TR 16123/45  
 \$75,000. ALAM SHAH CLOSING THE DAM AT SHISHAN PASS; page from  
 (actual gift: 1/3rd) the "Dastan-i-Amir-Hamza" (color and gold on muslin;  
 paper border a later addition)  
 Label: Partial Gift of George P. Bickford

From - The Print Club of Cleveland

E.V.: Lithographs printed in colors by Samia A. Halaby: TR 15724/53-63  
CLEVELAND  
(Material for Print Club Publication no. 53 for 1975)  
Label: Gift of The Print Club of Cleveland

From - Nickolas C. Hlobeczy

E.V.: Photograph by Minor White; silverpoint: TR 16246  
WATERFALL (Highway 100, Vermont)  
Label: Gift of Nickolas C. Hlobeczy in  
memory of his father and of his  
friend and teacher, Minor White

From - T. Yanagi

Manuscript, Japan, Fujiwara Period, 11th century: TR 15828/6  
BUDDHIST SUTRA  
(Accessioned as APPARATUS)

Upon recommendation of the Curators concerned and the Director, and upon motion  
duly made and unanimously carried, it was

VOTED: to accept the gifts offered as unrestricted gifts,  
and to express to the donors the appreciation of  
the Trustees.

The following GIFTS for the DEPARTMENT OF EXTENSION EXHIBITIONS were presented for  
ratification:

From - Mrs. John Nichols

E.V.: \$500. Porcelain, China, 17th century, provincial Red and TR 16140/91  
Green Ware: JAR WITH LID  
Label: Gift of Mrs. John Nichols

From - Arthur L. Feldman

E.V.: \$400. Etching by Adja Yankers, American: THE SKY HIDES ALL BIRDS TR 15452/4  
(unmatted, printed in white ink)  
Label: Gift of Arthur L. Feldman

From - Jehuda Levin

E.V.: \$250. Print by Sandu Liberman: AMERICANA TR 16240/1  
(unmatted, black & white lithograph, 21/50;  
signed lower right: Sandu Liberman)  
Label: Gift of Jehuda Levin

Upon recommendation of the head of the Extension Exhibitions Department and the Director, and upon motion duly made and unanimously carried, it was

VOTED: to accept the gifts offered as unrestricted gifts, and to express to the donors the appreciation of the Trustees.

Upon motion duly made and unanimously carried, it was

VOTED: to request the Trustees to appropriate the following sums for the use of the Accessions Committee from the income of the funds allocated for purchase of works of art:

Delia E. Holden Fund		£195.00 (app.\$350.)
Andrew R. and Martha Holden Jennings Fund	\$12,124.21	
Severance and Greta Millikin Purchase Fund	\$2,485.00	(£1,400.00)
John L. Severance Fund	\$134,040.66	
J. H. Wade Fund	\$26,500.00	plus Yen 10,000,000.00
Cornelia Blakemore Warner Fund	\$1,015.50	
Edward L. Whittemore Fund	\$1,351.00	plus SFr. 7,500.00

Upon recommendation of the Curator of Prints and Drawings and the Director, and upon motion duly made and unanimously carried, it was

VOTED: to authorize the sale or trade of a Dürer woodcut, Holy Family with St. Joachim and St. Ann (46.7 Gift of The Print Club of Cleveland), which was replaced by the same subject in better condition, given by The Print Club of Cleveland in 1967 (67.171); and to apply the monies realized to future Print Club purchase-gifts.

Then the meeting adjourned.

Sherman E. Lee  
Secretary

Executive Committee Meeting  
August 4, 1976

MINUTES OF THE MEETING OF THE EXECUTIVE  
COMMITTEE OF THE BOARD OF TRUSTEES OF  
THE CLEVELAND MUSEUM OF ART, held on  
Wednesday, August 4, 1976, at 12:00 Noon,  
in Parlor 4 of the Union Club

Present: James H. Dempsey, Jr., Robert I. Gale, Jr.,  
Severance A. Millikin, A. Dean Perry,  
Daniel J. Silver, Mrs. Seth Taft,  
Lewis C. Williams. Also present were  
Sherman E. Lee, Secretary and Director,  
A. Beverly Barksdale, Assistant Secretary and  
General Manager, Albert J. Grossman, Assistant  
Treasurer and Operations Administrator

Presiding: Mr. Williams

SCHEDULE OF FUTURE EXHIBITIONS

The Director described the major exhibitions scheduled for 1977 and 1978 and made brief comments on the importance of each (copy attached as Appendix A).

USE OF VOLUNTEERS AS INTERNS

The Director stated that it has been the policy of this Museum to limit the use of volunteers to members of the Junior Council and to those specific projects which they staff, such as the Sales Desk, the Information Desk, and assignments during the May Show, the Art for Collectors Show, and for exhibition previews, etc. There has been discussion concerning the use of a limited number of qualified volunteers per year to work as technical assistants in the Conservation and other professional Departments. He said that he recommends this with the understanding that the department head and the Director approve the candidate and that the responsibilities of the volunteer be clearly defined. Placement of such persons should be limited to the professional departments, each intern should be expected to work a regular schedule, such appointments may be terminated at any time by the Museum at its own pleasure. Dr. Silver suggested that the Executive Committee review this in eighteen months. While no vote was taken, it was the consensus that the program be approved with the above provisions noted.

LABOR SITUATION IN THE MUSEUM

The Director said that an agreement was reached with the Union last December which provided an across-the-board 15¢ per hour increase for our hourly employees. At that time he was requested by the Union representatives to reconsider at mid-year to determine if the budget would permit any further increase. He said that he and Mr. Grossman made this study two weeks ago and found that we are currently well behind our budgeting for the first six

months of the year. No increase is therefore possible. There was a Union meeting slated for this morning when a strike vote was scheduled, but it has been postponed for a week or two due to health problems of Mr. Murphy, the president of the Union. If a walkout does occur, the Museum, on advice of counsel, will regard it as a breach of contract. There followed discussion concerning the Museum's position on a number of matters. It was agreed that striking members of the Union would lose wages and all benefits; however, other members of the staff who might not feel that they could cross the picket line should be considered as acting in good faith and handled with a sympathetic and diplomatic approval. The Director said that in his absence Mr. Barksdale would be Acting Director and that he would act in consort with Mr. Grossman, keeping in very close contact with the Executive Committee for discussion of any action to be taken.

#### PROCEDURES FOR HOSTING DISTINGUISHED GUESTS AND SPEAKERS

The President made reference to a request from the staff which was discussed briefly at the Board Meeting of June 3, 1976, wherein the President was asked to appoint a Trustee who could be called upon to arrange entertainment for such persons, when necessary. He said that he had given this thought and arrived at the decision that this should be handled on an ad hoc basis. The Director suggested that Mr. Barksdale prepare a questionnaire to be sent to the Trustees to determine which of them would be willing to provide hospitality when needed, and what times of the year or days of the week would be impossible for them. Staff members hosting visitors could then work through Mr. Barksdale's office.

#### REPORT ON MEMBERSHIP DRIVE

Mr. Barksdale said that through the end of July, 216 new members had been recruited either through the booth or through mailings. The largest mailing to the 3300 members of the Academy of Medicine was made too recently for any results to be known. The 216 members have yielded \$3,895. To date the Museum has spent \$9,805.32 on this effort, which includes the services of a consultant, the printing of brochures, extra copies of the News and Calendar to be given out, addressing and mailing, and personnel to staff the Membership Booth after the month that the Junior Council undertook this, and at such times as regular members of the staff are not available. He said that total membership which stood at 8,215 at the end of July 1974, just prior to the announcement that the Bulletin would no longer go to Annual Members, gradually dropped to 8,127 at the end of December 1975. After that it began to grow again. By the end of May these losses had been recouped and by the end of July there was a further rise to 8,328.

#### RESULTS OF THE JULY 4TH EXPERIMENT

The Director said that this had been commented upon and that it is known that the attendance during the week containing the 4th of July was the lowest since The European Vision of America opened.

#### TV SERIES ON AMERICAN CIVILIZATION

The Director said that he was approached by a group headed by Gilbert P. Schafer, Jr., representing a proposed Foundation for Education in the Arts, seeking funding to produce a television series of thirteen one-hour programs devoted to an examination of America's artistic heritage. They asked him to serve as moderator in the way that Kenneth Clark has done in the well-known "Civilization" series. He gave them about six names of persons he would recommend for such an assignment, but they have come back to him with the request that he do it. He estimated that this would involve about a two-year period and would require at most half of his time. He said that the proposition was of interest to him for several reasons, one of which is that the material would be prepared by a very distinguished group including such persons as Jules Prown, John Wilmerding, and Dore Ashton. Further, he intended that 50% of any remuneration he would receive should go to the Museum. The benefits to the Museum by such a participation would be positive, should the series be successful. This was discussed at length and given approval in principle, with the understanding that it will be discussed further with the Trustees before any contract is signed. Dr. Silver added the proviso that at the same time the Director would present his plan for management and personnel during the period of his absence from the Museum.

#### PROPOSED VOLUME DEALING WITH ACQUISITIONS OF PAST 10 YEARS

Mr. Williams proposed such a volume in view of the great number of very important acquisitions during the period since the Golden Anniversary of 1966. The Director stated that each year the issue of the Bulletin devoted to The Year in Review lists all objects acquired during the year and illustrates the most important of them, some in color. We already have a complete and on-going record of purchases. The volume issued in 1966, called "Selected Works", was printed in an edition of 7,000 copies, of which 3,899 were bound; 3,101 copies remain in Holland in flat sheets. The total cost of the volume was \$53,470. After ten years we have sold or otherwise disposed of only 1,989 bound copies; 1,910 remain. A few months ago the price was reduced from \$15 to \$8.50. He said that he was not in favor of going to the very great expense of producing the proposed volume in view of the fact that The Year in Review exists as it does, and that we are on the point of updating and reissuing The Handbook. Mrs. Taft said that she felt that The Handbook would be much more useful. The idea of binding the ten issues of the Bulletin and offering this as a volume was mentioned. Mr. Barksdale is to check on the number of remaining copies of The Year in Review for each year. (See Appendix B)

REQUEST FROM ARMAND HAMMER TO PARTICIPATE IN EXHIBITION

The Director said that he had had telephone calls from Armand Hammer in California and a confirming letter in which Mr. Hammer has requested that this Museum participate in an exhibition presently touring the Soviet Union and scheduled to go on to France in the fall. It involved the loan of five major paintings to replace a group from the Buffalo Bill Historical Center which will not go to France. In return Mr. Hammer proposed an exhibition of works from French museums under control of the Institut de France, which would circulate among the participating museums in this country: The National Gallery of Art, The Los Angeles County Museum of Art, The Detroit Institute of Art, The Houston Museum of Fine Arts, and CMA. This was discussed at a staff meeting yesterday with mixed reactions. The Director later talked to Kenneth Donohue, Director of The Los Angeles County Museum, and learned that the Armand Hammer Foundation has not formulated any plans for financial support of the exhibition coming to this country. He said that he was opposed to the exhibition and asked for approval of his views by the Executive Committee.

Upon motion duly made and unanimously carried, it was

VOTED: to approve the Director's decision to decline participation in this exhibition.

CHANGE IN BENEFACTOR LISTING

Mr. Barksdale said that Mr. Grossman has received a letter from Wilbert S. Brewer, who established a Memorial Fund in memory of his first wife some years ago. He has now written to the Museum requesting that this fund be renamed "The Mr. and Mrs. Wilbert S. Brewer Individual Membership Endowment Fund" and that his name be added to that of his wife in the listing of Benefactors on the wall.

Upon motion duly made and unanimously carried, it was

VOTED: to approve these requests of Mr. Brewer.

EVA PROMOTION BY PETER USTINOV

The President said that he had been surprised by a public service announcement by Peter Ustinov which promotes attendance at The European Vision of America in its closing days. Miss Stamper provided the explanation reported by Mr. Barksdale: Channel 25 has been at work here for the past several months on an hour-long program dealing with the exhibition. Mr. Ustinov came to the Museum to narrate the program. While he was in the Museum, the producer offered Mr. Ustinov's service to us, free of charge, for a public service announcement on the exhibition. This has been used on Channels 3, 5, 8, and 43 for the past week or so.

Executive Committee Meeting  
August 4, 1976

5.

The Director stated that attendance at the exhibition has steadily increased, and to date has amounted to approximately 90,000. He added that it is quite possible that we will reach the 100,000 mark by the time the exhibition closes August 8.

Sherman E. Lee  
Secretary

kc



## APPENDIX A

## THE CLEVELAND MUSEUM OF ART

## Exhibition Schedule

1976Gallery

Ground Level	<u>#Heritage and Horizon: American Painting 1776-1976</u> (Members' Preview, Sept. 7, 4:00-7:00 p.m.)	Sept. 8 - Oct. 10
Classroom Level	<u>#Heritage and Horizon: the Words and Thoughts of American Artists 1776-1976</u>	Sept. 8 - Oct. 10
Upper Level	<u>#The American Situation: The Camera's Century</u>	Sept. 8 - Oct. 3
Print Galleries	<u>Dutch and Flemish Prints, 15th through 17th Centuries</u>	Sept. - Dec.
	<u>German Prints, 15th and 16th Centuries</u>	Sept. - Dec.
Classroom Level	<u>Textile Arts Club Annual Exhibition</u>	Oct. 20 - Nov. 7
Indian Painting Gal.	<u>Tuti-Nama</u>	Nov. 9 - Dec. 19
Classroom Level	<u>#Materials and Techniques of 20th-Century Artists</u>	Nov. 17 - Jan. 2 '77
Ground & Upper Levels	<u>#May Show</u> (Patrons' Preview, Nov. 22, 2:30-5:00 p.m.) (Members' Preview, Nov. 23, 4:00-11:00 p.m.)	Nov. 24 - Jan. 2 '77

1977

Upper Level	<u>#Tsutsumu: The Art of the Japanese Package</u>	Jan. 18 - Feb. 20
Classroom Level	<u>#In the Nature of Materials: Japanese Decorative Arts</u>	Jan. 18 - Feb. 27
Lower Level	<u>#The Year in Review</u> (Reception and private viewing, Jan. 31, 6:30 p.m.)	Feb. 1 - Mar. 6

Ground Level	<u>Japanese Screens</u> (CMA and Cleveland Collections)	Mar. 22 - May 8
Classroom Level	<u>#Interrelationships Between French, English, and American Prints 1850-1920</u>	Mar. 22 - May 29
Upper Level	<u>#Perception and Illusion: Anamorphic Art</u> (Members' Preview, Mar. 29, 6:00-10:00 p.m.)	Mar. 30 - May 15
Print Galleries	<u>#Edvard Munch: The Major Graphics</u>	May 7 - June 5
Classroom Level	<u>#Still Life Images</u>	June 21 - Sept. 11
Ground and Upper Levels	<u>#May Show</u> (Patrons' Preview, July 11, 2:30-5:00 p.m.) (Members' Preview, July 12, 4:00-11:00 p.m.)	July 13 - Aug. 21
Print Galleries	<u>#Turner Water Colors from The British Museum</u>	Oct. 4 - Nov. 27
Ground and Upper Levels	<u>#Fiberworks</u> (Members' Preview, Oct. 4, 6:00-10:00 p.m.)	Oct. 5 - Nov. 20
Classroom Level	<u>#Fiberworks</u> (supporting exhibition)	Oct. 5 - Nov. 20
Ground Level	<u>#Mingei: Japanese Folk Art</u> (Members' Preview, Dec. 12, 6:00-10:00 pm) <u>Other showings:</u> Japan House, New York Center of Asian Art & Culture, San Francisco	Dec. 13 - Jan. 22, '78 Feb. 8 - Mar. 15, '78 Apr. 7 - May 22, '78

### 1978

Upper Level	<u>#Barocci Drawings</u>	Jan. Feb.
Ground Level	<u>#Afro-American Arts and Crafts</u>	Feb. - Mar.
Ground and Upper Levels	<u>#May Show</u> (Patrons' Preview, Apr. 22, 2:30-5:00 p.m.) (Members' Preview, Apr. 23, 4:00-11:00 p.m.)	Apr. 24 - June 4
Upper Level	<u>#Works of Paul Klee</u>	July 6 - Sept. 3
Ground Level	<u>#Sasanian Art</u> (Members' Preview, July 5, 4:00-7:00 p.m.) <u>Other showings:</u> Asia House, New York Dallas Museum of Fine Arts	July 6 - Aug. 13 Jan. 12 - Mar. 11, '78 Apr. 10 - May 21, '78
	<u>#Chinese Painting in the Kansas City and Cleveland Museums</u>	(1978 or 1979)

## REMAINING COPIES OF "YEAR IN REVIEW" BULLETINS

1967 December	866
1968 Not issued until 1969 January	240
1970 January	175
1971 February	347
1972 January	328
1973 March	420
1974 February	55
1975 March	261
1976 February	921

